

**MEDICAL OR OFFICE SPACE FOR LEASE**

# PROFESSIONAL OFFICE ON US 1

308 S Harbor City Blvd., Melbourne, FL 32901

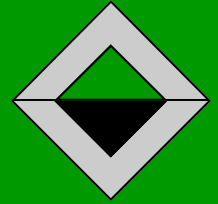

- ▲ Beautiful Professional Office Building with Plenty of Parking for Medical or General Office Use
- ▲ Centrally Located in the Heart of Melbourne's Medical & Business District
- ▲ Near Shopping, Restaurants, Schools & Conveniently Located Near Holmes Regional Medical Center
- ▲ High Visibility on Busy Harbor City Blvd. with Daily Traffic of 35,000 Cars
- ▲ 2 Suites Available - 2100 SF & 800 SF
- ▲ \$17/SF/YR Gross Lease

Demographics	1 Mile	3 Mile	5 Mile
2019 Population	2,487	42,264	131,243
2019 Average Household Income	\$51,802	\$68,456	\$69,850
Median Age	37.2	48.5	47.7

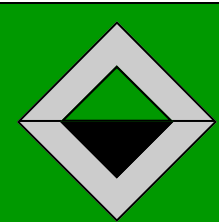
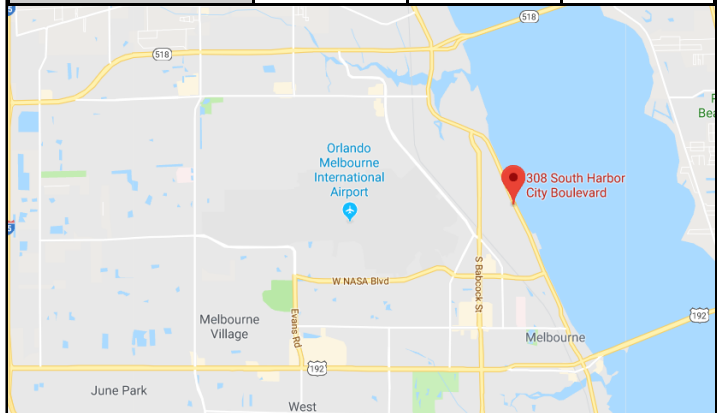

Information contained herein has been obtained from others and is considered to be reliable; however, a prospective purchaser, agent, or lessee is expected to verify all information to their satisfaction. We make no guarantee, warranty, or representations herein.

Licensed Real Estate Broker



**Commercial**

- ▲ Management
- ▲ Leasing
- ▲ Sales

Leasing Contact:

**Rebecca Collura**

JM Real Estate, Inc.

Office: 321.242.2882 ext. 210

Cell: 321.768.3750

Email: [Rebecca@JMRealEstate.com](mailto:Rebecca@JMRealEstate.com)

[WWW.JMREALESTATE.COM](http://WWW.JMREALESTATE.COM)

**MEDICAL OR OFFICE SPACE FOR LEASE**

# PROFESSIONAL OFFICE ON US 1

308 S Harbor City Blvd., Melbourne, FL 32901

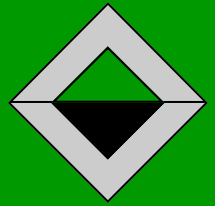

Suite B - 2,100 SF

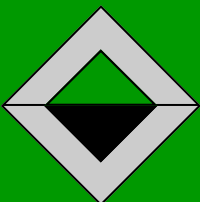

Information contained herein has been obtained from others and is considered to be reliable; however, a prospective purchaser, agent, or lessee is expected to verify all information to their satisfaction. We make no guarantee, warranty, or representations herein.

Licensed Real Estate Broker



**Commercial**

▲ **Management**

▲ **Leasing**

▲ **Sales**

Leasing Contact:

**Rebecca Collura**

JM Real Estate, Inc.

Office: 321.242.2882 ext. 210

Cell: 321.768.3750

Email: [Rebecca@JMRealEstate.com](mailto:Rebecca@JMRealEstate.com)

**[WWW.JMREALESTATE.COM](http://WWW.JMREALESTATE.COM)**

**MEDICAL OR OFFICE SPACE FOR LEASE**

# PROFESSIONAL OFFICE ON US 1

308 S Harbor City Blvd., Melbourne, FL 32901

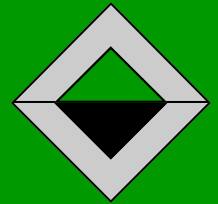

Suite C - 800 SF

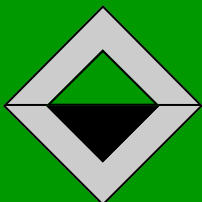

Information contained herein has been obtained from others and is considered to be reliable; however, a prospective purchaser, agent, or lessee is expected to verify all information to their satisfaction. We make no guarantee, warranty, or representations herein.

Licensed Real Estate Broker



**Commercial**

▲ **Management**

▲ **Leasing**

▲ **Sales**

Leasing Contact:

**Rebecca Collura**

JM Real Estate, Inc.

Office: 321.242.2882 ext. 210

Cell: 321.768.3750

Email: [Rebecca@JMRealEstate.com](mailto:Rebecca@JMRealEstate.com)

**[WWW.JMREALESTATE.COM](http://WWW.JMREALESTATE.COM)**

MEDICAL OR OFFICE SPACE FOR LEASE

# PROFESSIONAL OFFICE ON US 1

308 S Harbor City Blvd., Melbourne, FL 32901

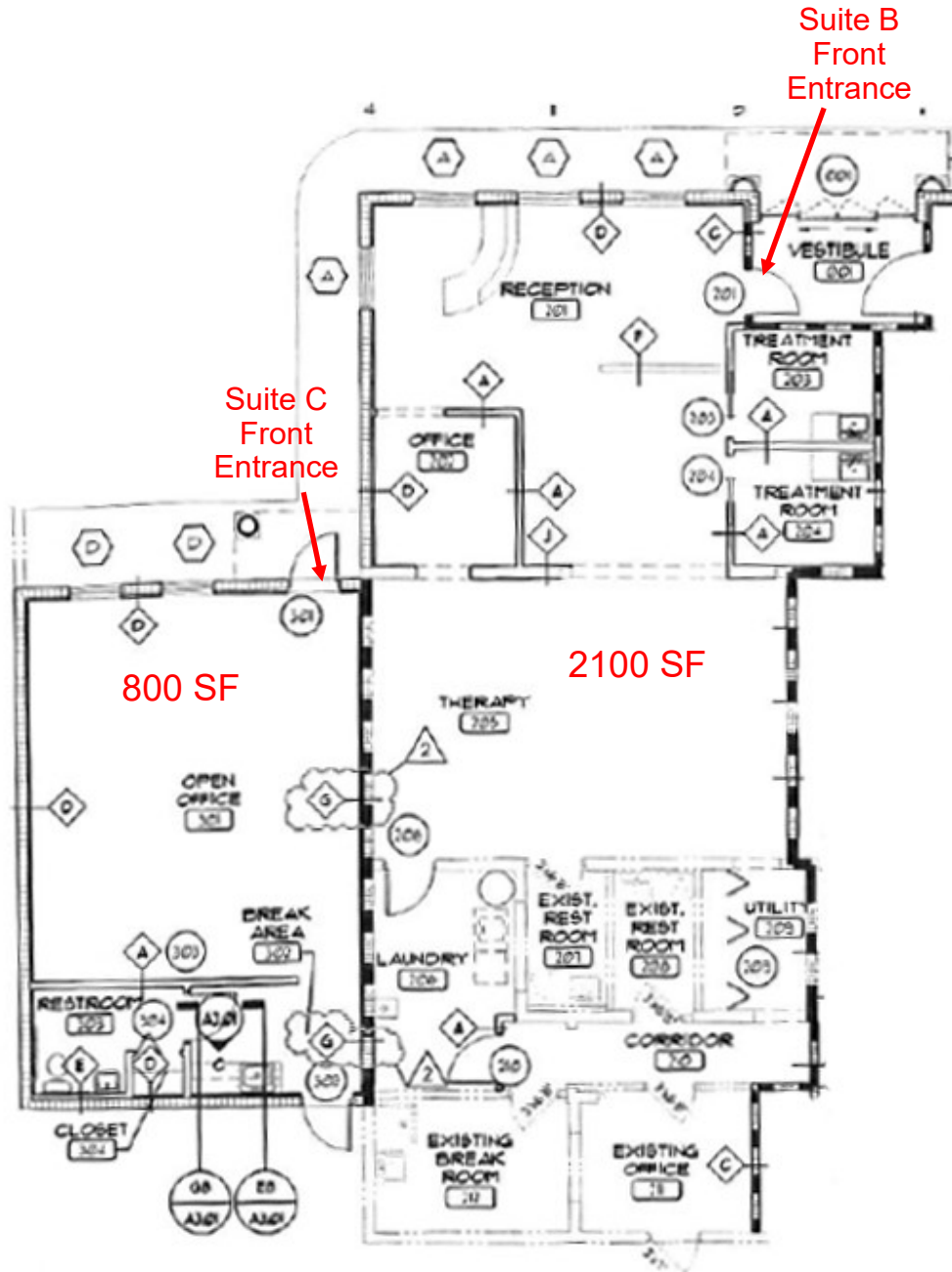
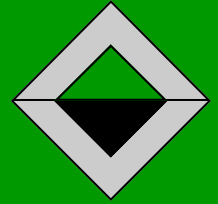

FLOOR PLAN

Information contained herein has been obtained from others and is considered to be reliable; however, a prospective purchaser, agent, or lessee is expected to verify all information to their satisfaction. We make no guarantee, warranty, or representations herein.

Licensed Real Estate Broker



**Commercial**

▲ Management

▲ Leasing

▲ Sales

Leasing Contact:

**Rebecca Collura**

JM Real Estate, Inc.

Office: 321.242.2882 ext. 210

Cell: 321.768.3750

Email: [Rebecca@JMRealEstate.com](mailto:Rebecca@JMRealEstate.com)

[WWW.JMREALESTATE.COM](http://WWW.JMREALESTATE.COM)

