

MEDICAL OFFICE SPACE FOR LEASE

9091 EDINGER AVENUE

WESTMINSTER, CA 92683



LISTING DATA

- ±800 RSF medical office suite
- 3 exam rooms, office, storage and reception
- Fully furnished medical space
- Shared with Dr. Mach Endocrine & Diabetes - Dr. Mach will only use the space on Saturday, Tenant will have full access Monday thru Friday
- Available now

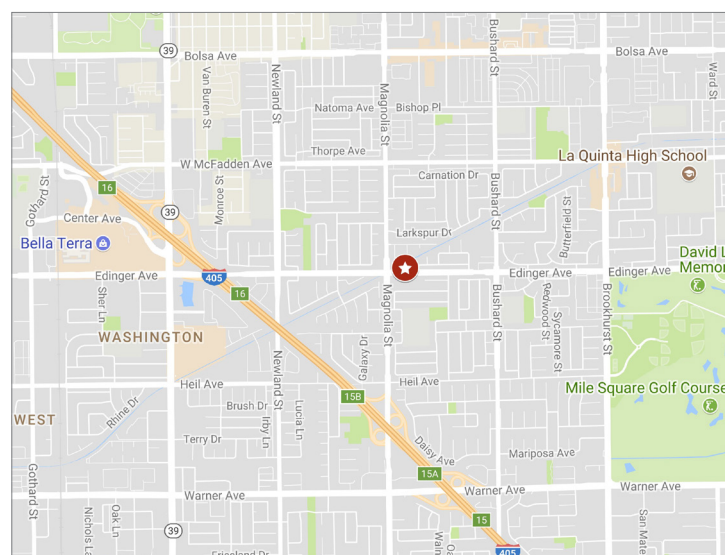

Mia Pham
Senior Vice President
CalBRE 01875144
949.790.3129
mpham@leeirvine.com

All information furnished regarding property for sale, rental or financing is from sources deemed reliable, but no warranty or representation is made to the accuracy thereof and same is submitted to errors, omissions, change of price, rental or other conditions prior to sale, lease or financing or withdrawal without notice. No liability of any kind is to be imposed on the broker herein.

MEDICAL OFFICE SPACE FOR LEASE
9091 EDINGER AVENUE
WESTMINSTER, CA 92683

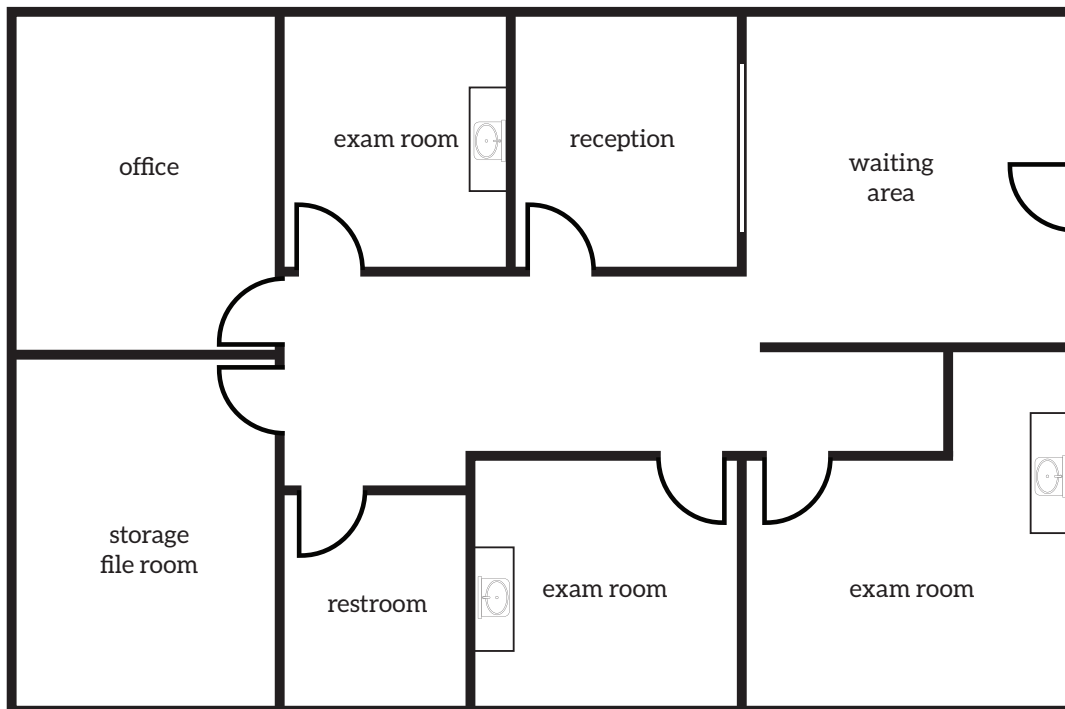

Mia Pham
Senior Vice President
CalBRE 01875144
949.790.3129
mpham@leeirvine.com

All information furnished regarding property for sale, rental or financing is from sources deemed reliable, but no warranty or representation is made to the accuracy thereof and same is submitted to errors, omissions, change of price, rental or other conditions prior to sale, lease or financing or withdrawal without notice. No liability of any kind is to be imposed on the broker herein.