

100 SUYDAM STREET

BUSHWICK, BROOKLYN



RETAIL SPACE
FOR LEASE

BUSHWICK BROOKLYN

100 SUYDAM STREET

SPACE HIGHLIGHTS

LOCATION

Between Myrtle Ave
and Central Ave

SPACE

1,500 SF

CEILING HEIGHT

12 FT

FRONTAGE

57 FT

DIMENSIONS

Variable

ZONING

C2-3

OCCUPANCY

Immediate

ASKING RENT

Upon Request

HIGHLIGHTS

- Additional Basement Space
- 57 FT of Frontage
- Modern Sunny Building
- 12 FT Ceilings
- 4 Minute Walk to Central M Train



BUSHWICK BROOKLYN

100 SUYDAM STREET

FLOORPLANS & DETAILS

Space	1,500 SF
Ceiling Height	12 FT
Frontage	57 FT
Dimensions	Variable

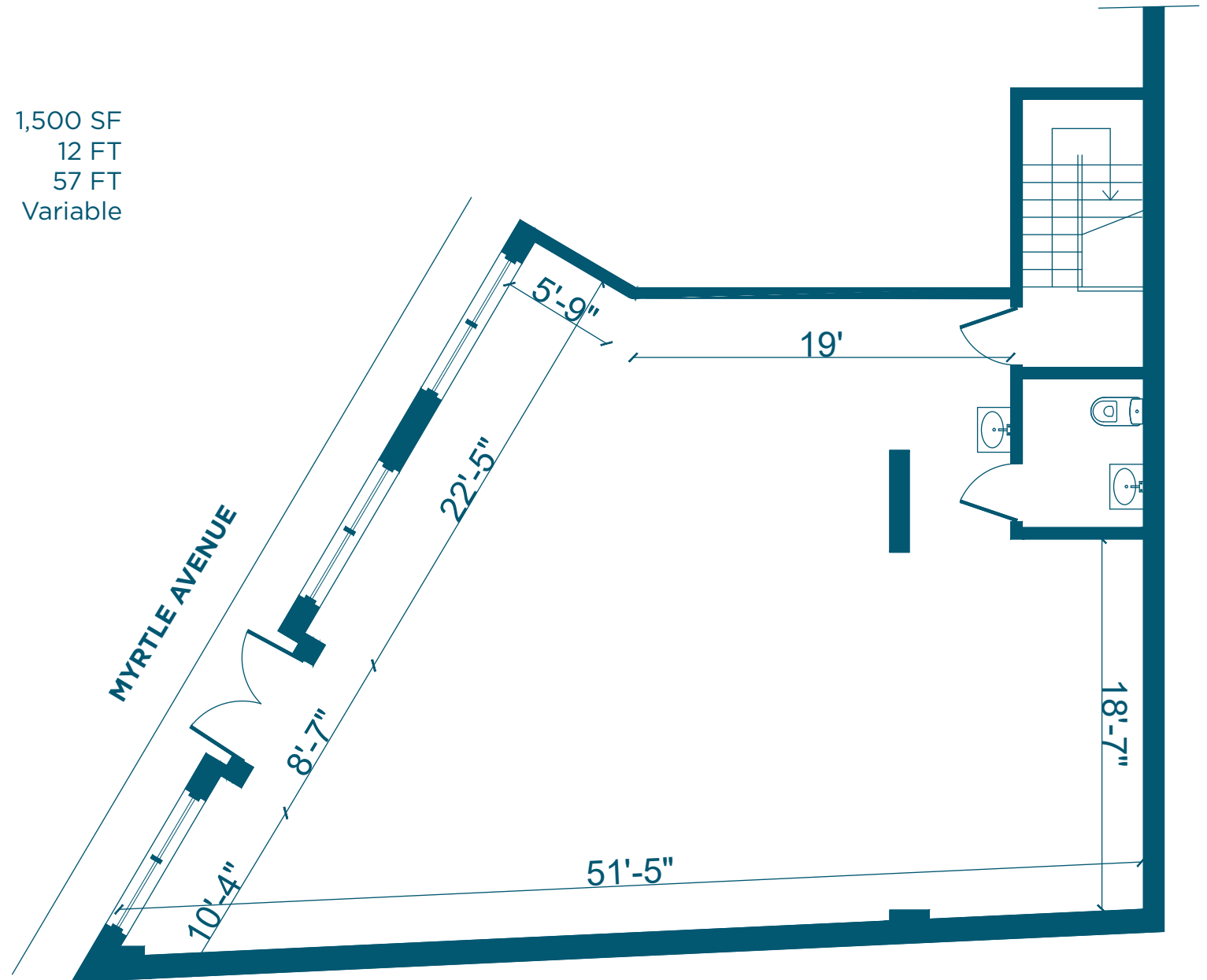

BUSHWICK BROOKLYN

4 CHARLES PLACE

EXISTING CONDITION



NEIGHBORHOOD DEMOGRAPHICS



184,335

POPULATION
WITHIN 1-MILE
RADIUS



35 Years

AVERAGE
POPULATION
AGE



10.35%

POPULATION
GROWTH
SINCE 2010



\$65,171

AVERAGE HHI
WITHIN 1-MILE
RADIUS



4,300

TOTAL BUSINESSES
WITHIN 1-MILE
RADIUS



\$1.2 bn

ANNUAL SPENDING
WITHIN 1-MILE
RADIUS

BUSHWICK BROOKLYN

100 SUYDAM STREET

NEIGHBORHOOD & TRANSPORTATION

NEIGHBORHOOD TENANTS

- Bossa Nova Civic Club
- Zefe's
- Little Skips
- Happyfun Hideaway
- Le Garage
- Archie's Bar & Pizza
- Precious Metal
- Little Mo
- Bizarre
- Hart Bar
- Bushwick Public House
- Bushwick Bakery
- Brooklyn Whiskers
- House of Kava
- Mood Ring
- Birdy's
- Zatar Cafe & Bistro
- Maite
- Tacos Molly
- Central Cafe Brooklyn
- Central Wine & Liquor
- Richie's Gym

TRANSPORTATION

- 5 Min Walk at Central Avenue (0.2 mi)
- 8 Min Walk at Myrtle Avenue (0.4 mi)
- 10 Min Walk at Kosciuszko Street (0.5 mi)
- 15 Min Walk at Morgan Avenue (0.7 mi)

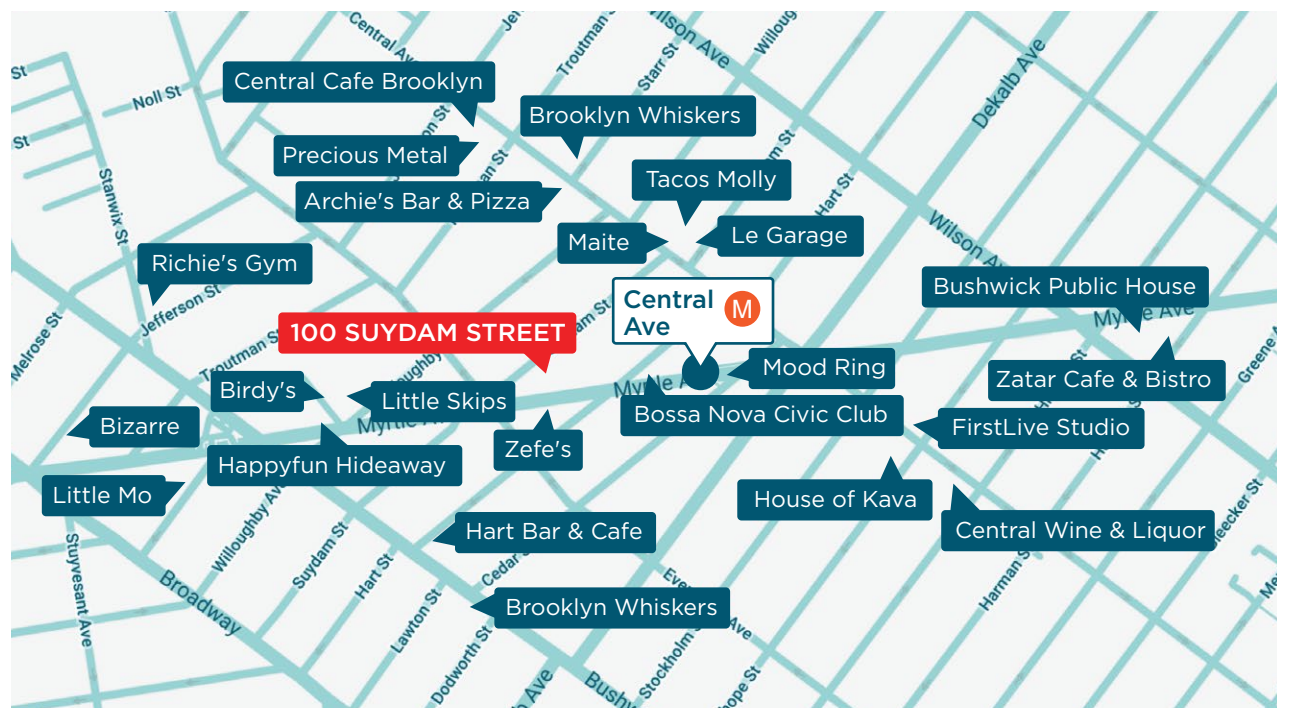

BUSHWICK BROOKLYN

100 SUYDAM STREET

CONTACT



ROSS ADAMS
609.903.1413
radams@exrny.com

