

3245 Cobb Pkwy NW

3245 Cobb Pkwy NW
Kennesaw, Georgia 30101

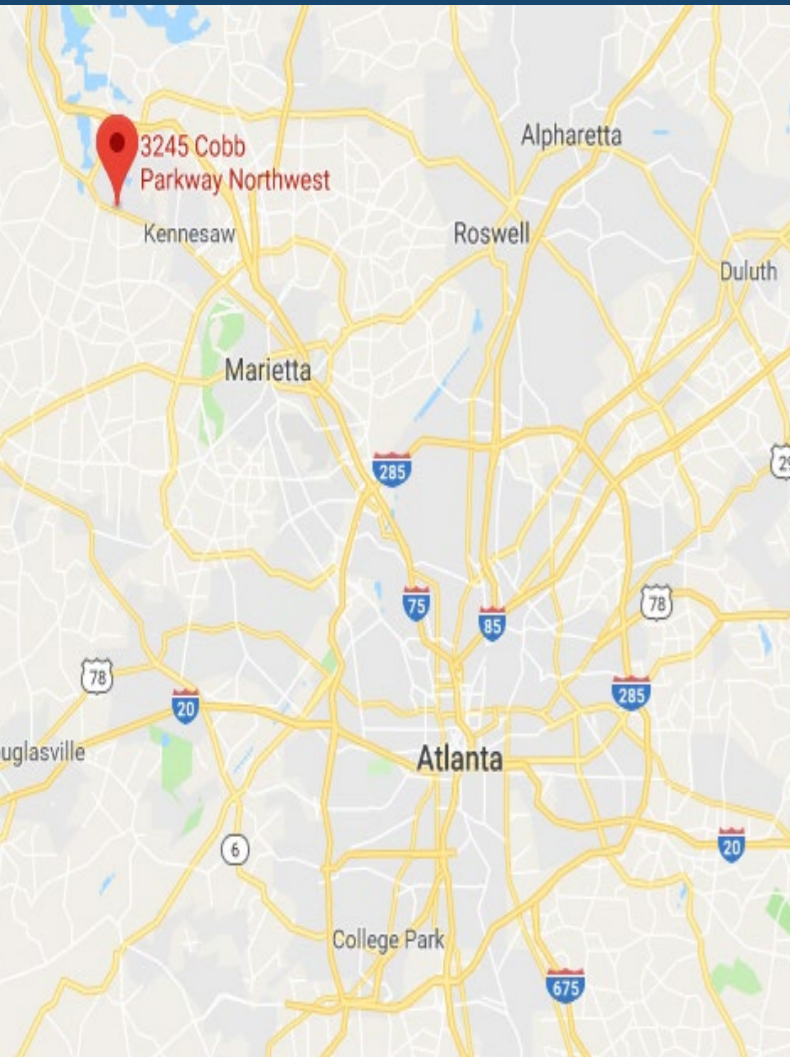

Leasing Contacts

Allie Hodge (678) 501-5342

Marrissa Chanin: (678) 501-5341

Email: info@riverwoodproperties.com

3245 Cobb Pkwy NW is an unanchored center located on Cobb Pkwy NW. The site is near the signalized intersection of Cobb Pkwy NW and Acworth Due West Rd in Kennesaw, Georgia. The center has multiple access points with one on Cobb Pkwy NW and the other on Acworth Due West Rd. This center boasts a strong mix of service, retail and restaurant tenants. With great exposure to over 28,000 vehicles per day, this is an ideal location for any retailer.

Intersection: Intersection of Cobb Pkwy NW & Acworth Due West Road

Daily Traffic Counts: 29,000 Vehicles Per Day

Site Access: Site is accessible via Cobb Pkwy or Acworth Due West Rd NW

3245 Cobb Pkwy NW

101	Aspen Dental	4,000
105	<i>Restaurant Space Available</i>	<i>2,400</i>
113	AT&T	5,020

GLA: 11,420 SF

Availability: 2,400 SF

AREA DEMOGRAPHICS

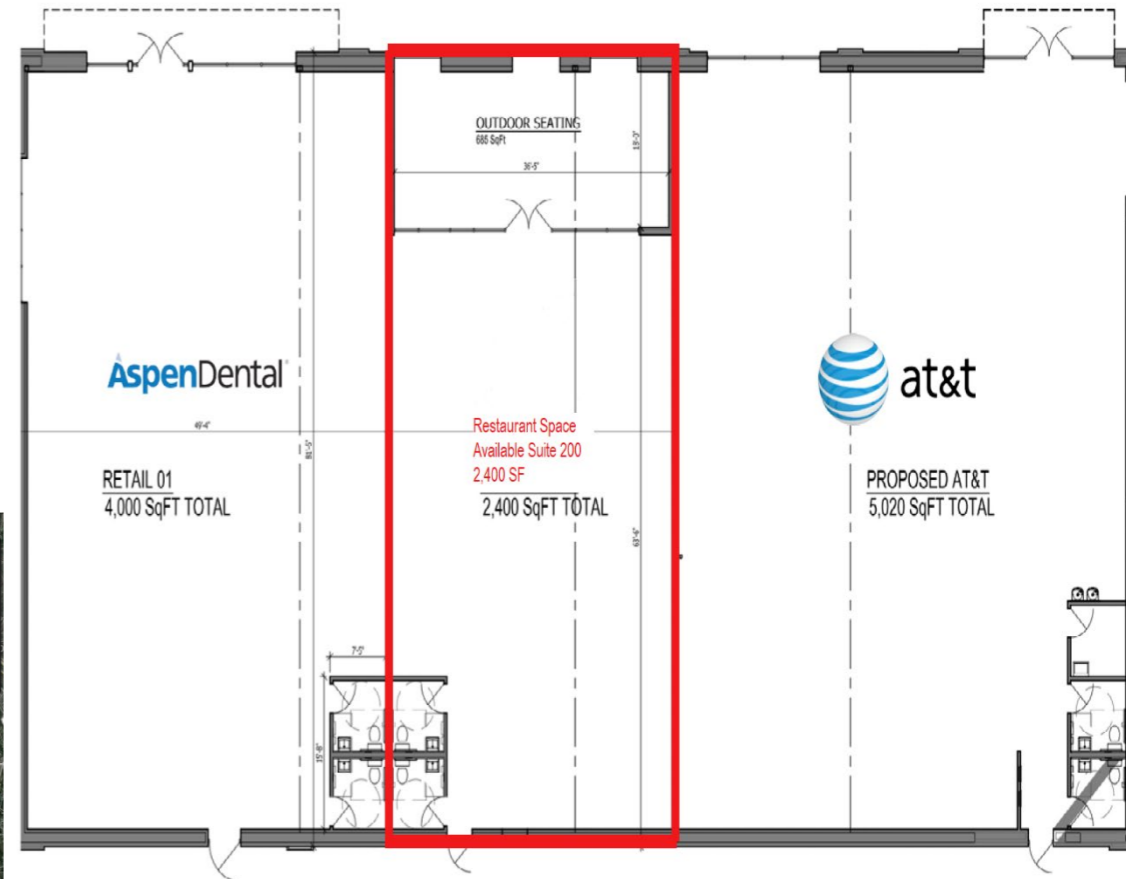
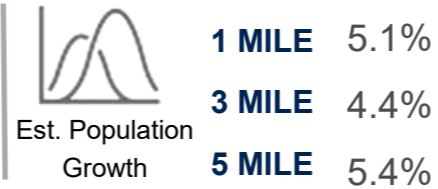
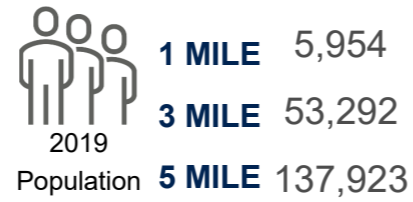

3245 COBB PKWY NW Trade Area Overview