

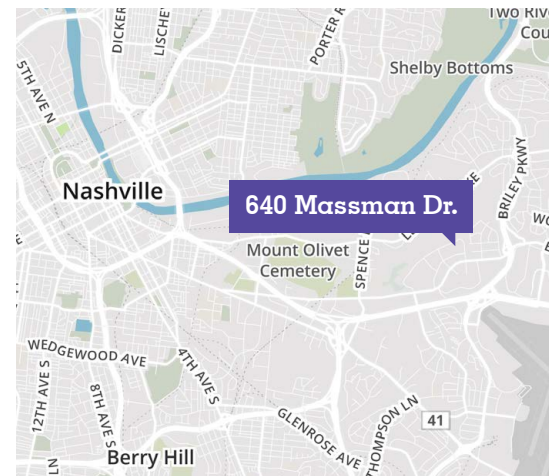

Opportunity

- +/- 169,855 sf available for lease
- Divisible to 87,355 sf and 82,500 sf spaces
- New ownership with significant improvements to be completed 11/1/20
- Original building consists of 20' - 22' clear and 38' x 53' column spacing
- Addition consists of 30' - 38' clear and 41' x 50' column spacing
- 281 car parks
- 16 dock doors
- One oversized drive in - 12' x 14'
- 6,000 amps of electrical service
- Wet sprinkler service
- New LED Lighting (35' candle)



[View Property Video](#)

**Get more
information**

Todd Prevost
Principal
+1 615 727 7440

avisonyoung.com

Industrial For Lease

640 Massman Drive, Nashville, TN

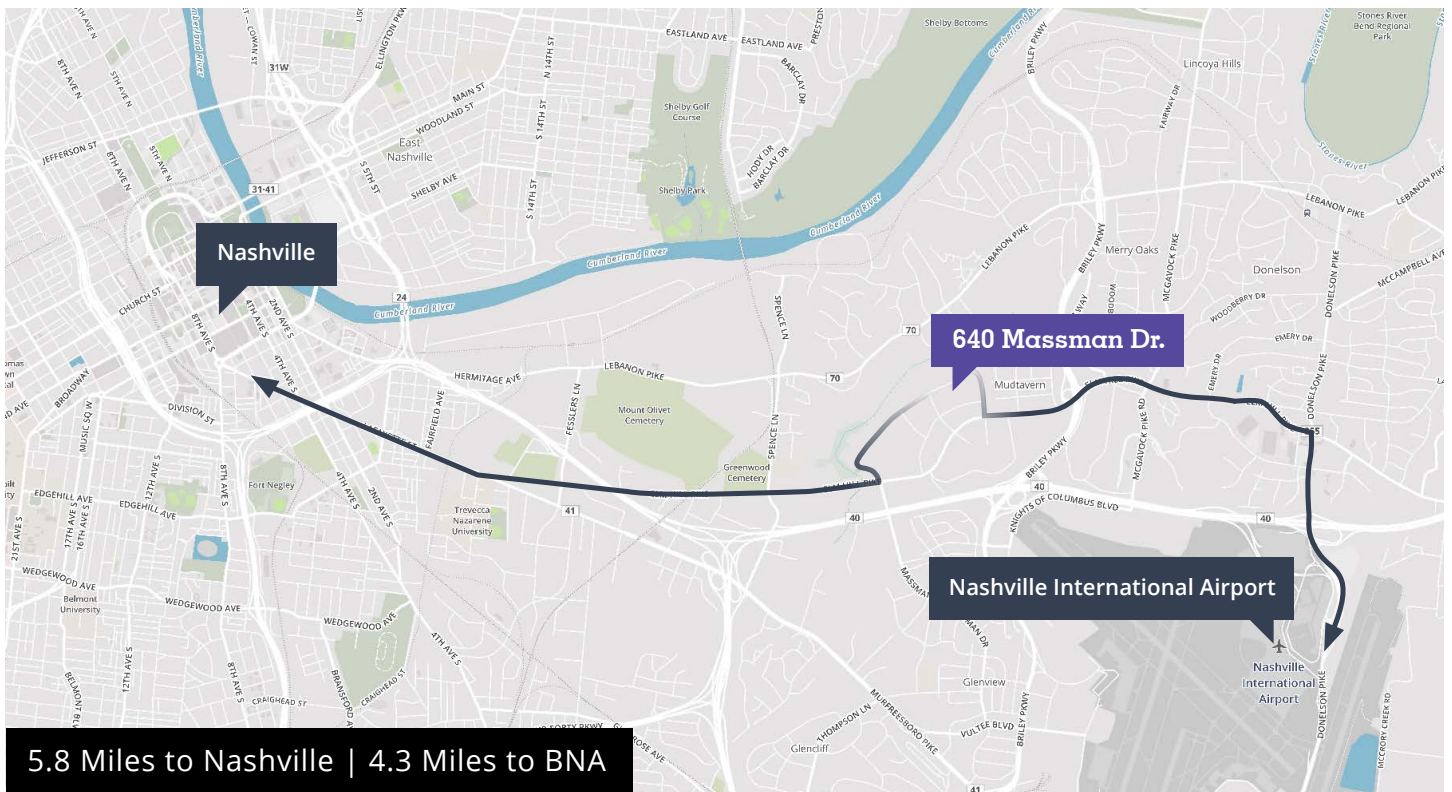

Todd Prevest
Principal
+1 615 727 7440



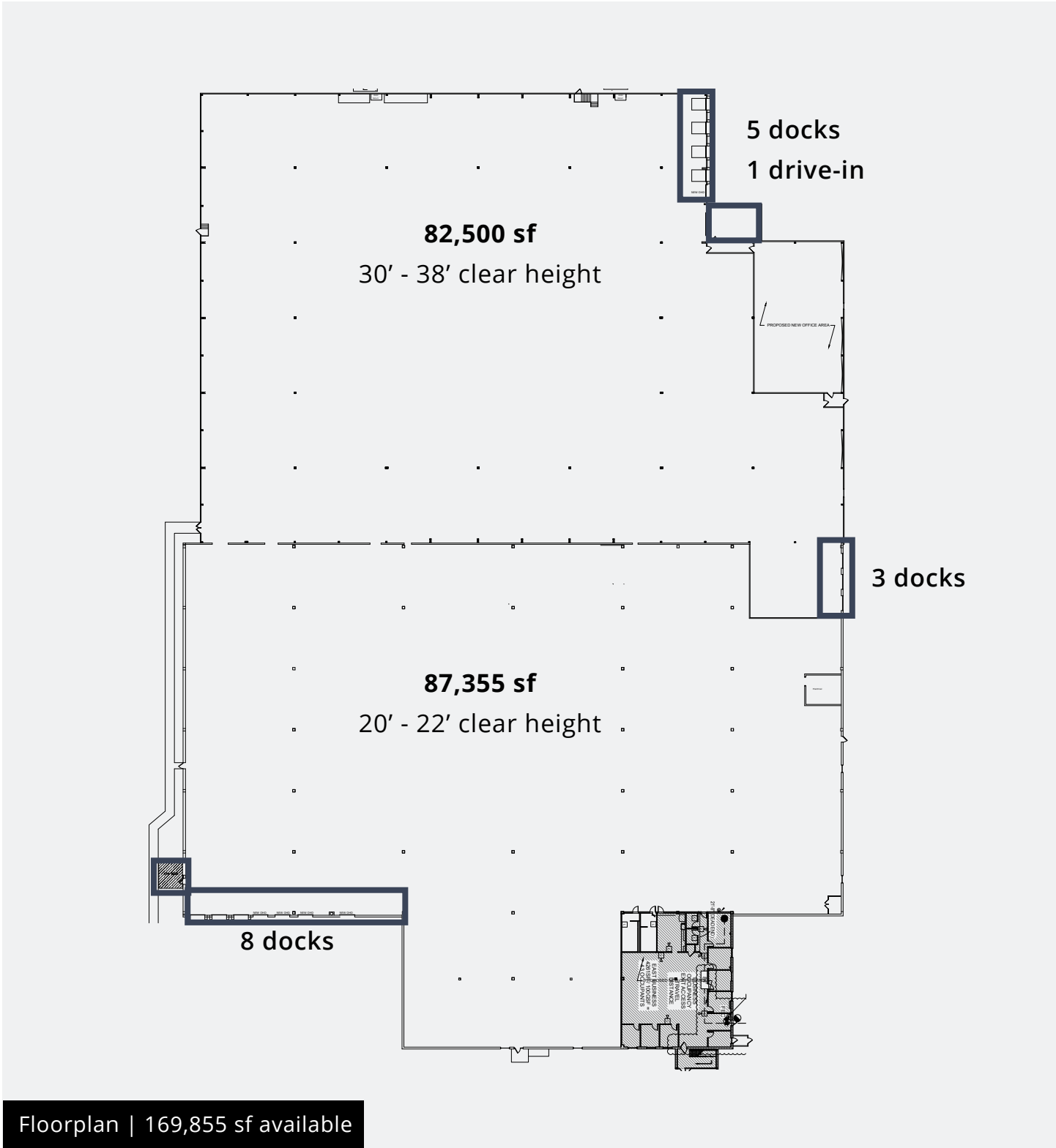

Todd Prevost
Principal
+1 615 727 7440

