



FOR LEASE | 9,900 SF (Divisible to 4,500 SF)
801 SE Hawthorne Blvd
 Portland, OR 97214

Ownership will consider Lease
 with Option to Purchase



Ideal for
 Wholesale/Retail, Service, Flex

PROPERTY HIGHLIGHTS

- ±9,900 SF (divisible to 4,500 SF)
- Warehouse: 3,980 SF | Office 5,920 SF
- One drive-in door (9 x 12)
- Zoned IG1 - General Industrial 1
- Quick access to I-5, I-84 and Hwy 99E
- Transit and bike friendly
- Base Rent: \$14,250 / month, NNN

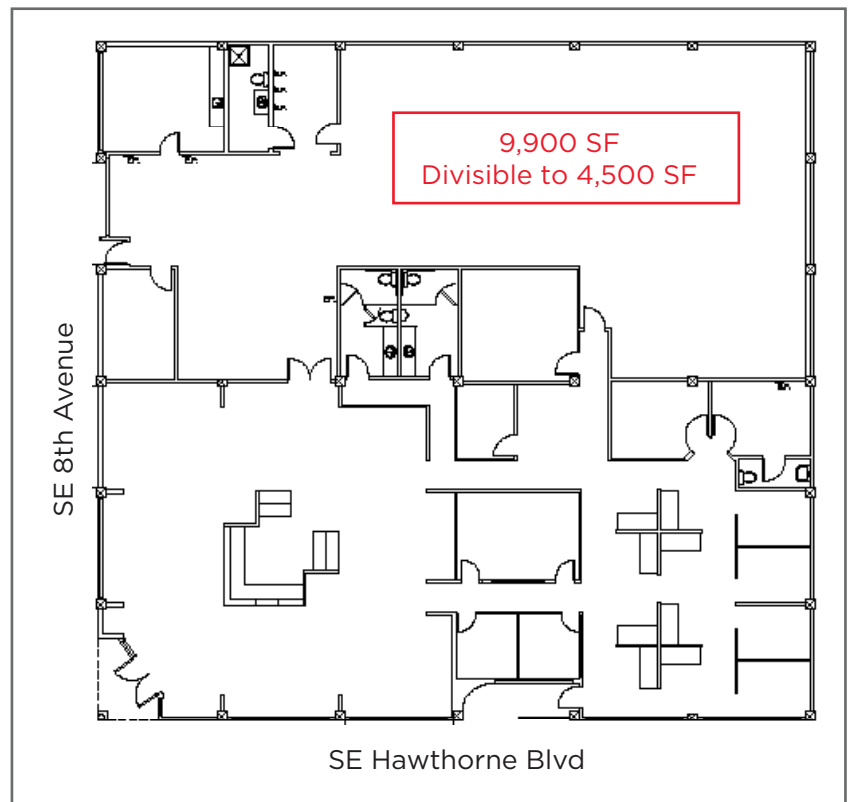

Brad Carnese
 Senior Director
 (503) 279 1750
 brad.carnese@cushwake.com

Doug Deurwaarder
 Executive Director
 (503) 279 1752
 doug.deurwaarder@cushwake.com

200 SW Market St, Suite 200
 Portland, OR 97201
 503 279 1700
 cushmanwakefield.com



FOR LEASE | 9,900 SF (Divisible to 4,500 SF)

801 SE Hawthorne Blvd

Portland, OR 97214



Biker's Paradise
Flat as a pancake,
excellent bike lanes



Walker's Paradise
Daily errands do not
require a car



Excellent Transit
Transit is convenient
for most trips

Bus Stops	○	1-2 blocks
Streetcar		3-4 blocks
Bike Route		Adjacent
Interstate 5		0.8 mile
Interstate 84		1.2 miles
Downtown		1 mile

Brad Carnese
Senior Director
(503) 279 1750
brad.carnese@cushwake.com

Doug Deurwaarder
Executive Director
(503) 279 1752
doug.deurwaarder@cushwake.com

Cushman & Wakefield Copyright 2019. No warranty or representation, express or implied, is made to the accuracy or completeness of the information contained herein, and same is submitted subject to errors, omissions, change of price, rental or other conditions, withdrawal without notice, and to any special listing conditions imposed by the property owner(s). As applicable, we make no representation as to the condition of the property (or properties) in question.