

Property Owner**Name:** FM DEVELOPMENT GROUP INC**Mailing Address:** 303 N WALNUT ST STE 2
HARRISON, AR 72601**Type:** (CI) Comm. Impr.**Over 65 Freeze:** No**Tax Dist:** (1C) Harrison**Size (Acres):** 0.680**Extended Legal:** PT SW SE**Property Information****Physical Address:** 520 PINE N**Subdivision:** HARRISON CITY ACREAGE 4-18-20**Block / Lot:** -- / --**S-T-R:** 04-18-20**Market and Assessed Values:**

	Estimated Market Value	Full Assessed (20% Mkt Value)	Taxable Value
Land:	\$74,050	\$14,810	\$14,810
Building:	466350	93270	93270
Total:	\$540,400	\$108,080	\$108,080

Taxes:

Estimated Taxes:	\$5,512
Homestead Credit:	\$0

Note: Tax amounts are estimates only. Contact the county tax collector for exact amounts.

Land:

Land Use	Size	Units
PINE	29621	Sq. Ft.

Special Assessments:

Assessment	Tax Amount
S	\$18.00
Totals: \$18.00	

Not a Legal Document.
Subject to terms and conditions.

www.datascoutpro.com

Deed Transfers:

Date	Book	Page	Deed Type	Stamps	Est. Sale	Grantee	Code	Type
12/27/2007	08	003016	Warr. Deed	1237.50	\$375,000	FM DEV GROUP INC		Improved
12/6/2007	08	003015	Warr. Deed	1237.50	\$375,000	FM DEV GROUP INC		Improved
11/20/2007	07	008432	Warr. Deed	0.00	\$0	MILAM & LEDGEMORE 1/2 IN EA		Improved
11/20/2007	07	008326	Warr. Deed	2326.50	\$705,000	MILAM & LEDGEMORE 1/2 I- EA		Improved
6/29/2006	06	005030	Warr. Deed	3465.00	\$1,050,000	ST JOHN'S HEALTH SYSTEM		Improved
2/25/2000	00	001308		66.00	\$20,000	MOFFETT		
2/25/2000	00	001307		66.00	\$20,000	MOFFETT		
2/25/2000	00	001306		66.00	\$20,000	MOFFETT		

Details for Commercial Card 1:**Business Name(s):** MALLETT STEPHANIE**Number of Units:****Site Work:** Excavate; Fill; Prep;**Foundation:** Conc.Blk**Floor Struct:** WJSheath**Struct. Frame:** Wood**Exterior Walls:** BrickVen**Ext. Wall Load:** NonLoadB**Roof Struct.:** Wood.J&D**Roof Cover:** CompShng**Total Floor Area:** 7094**Floor Cover:** Carpet**Ceilings:** Acoust**Interior Finish:** DryWall**Insulation:** Ceilings; Walls;**Appliances:****Plumbing:** None**Electric:** Avg.B**Misc:**

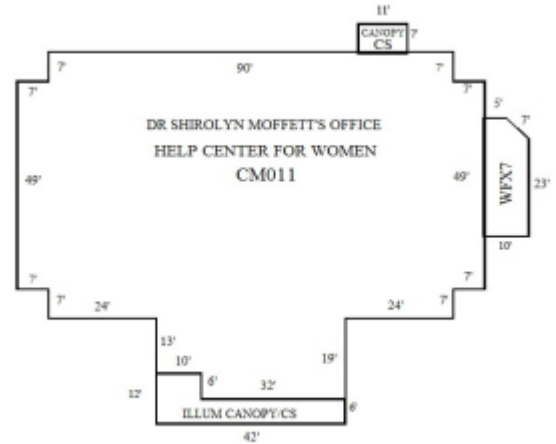

Sketch by Apex IT Windows™

Building: 1

Age/YC	Condition	Effective Age	Stories	Grade
2002		12	1	
Avg. Floor Area:		Common Wall:		
Avg. Perimeter:		Total Floor Area: 7094		
No. Floors:		Total Height:		
Avg. Floor Hgt:		Unit Multiplier: 1		
Occupancy		Heating/Cooling	Sprinkler	
Primary	Office Buildings - Medical (100%)	N/A	N/A	
Secondary	N/A	N/A	N/A	

Outbuildings and Yard Improvements:

Item	Type	Size/Dim	Unit Multi.	Quality	Age
Canopies	FABRIC	1			
Canopies	Office/Bank steel frame sec 15	312			
Canopies	Office/Bank wood frame sec 15	77			
Fence, Wood	6' solid board	145			
Lighting	Post Lantern (ea.)	4			
Paving	Asphalt, 3"-2" base	15194			
Paving	Concrete, 4" reinforced	77			
Paving	Concrete, 4" reinforced	267			
Paving	Concrete, 4" reinforced	312			
STORAGE	UPPER LEVEL STORAGE ROOM	744			
Walls, Masonry	Common brick, 8" thick	24			

Map:



Not a Legal Document.
Subject to terms and conditions.
www.datascoutpro.com