

Medical Office Space Near 108th & 159th For Lease

10743 W. 159th St. | Orland Park, IL

\$14.50/SF NNN

Investment Highlights

- Three medical office spaces for lease
- A: 869 SF office with 5 exam rooms, reception and waiting area
- C: 1,314 SF office with separate entrance, 4 exam rooms, private office, reception/waiting room, medical records area, and handicap bathroom
- D: 502 SF mezzanine office with room for 4 offices and storage
- Part of Winterset Office Park
- Co-tenancy with pediatric practice
- Common area lunchroom
- Ample parking for patients and staff
- Est. CAM/Taxes: \$13.85/SF

Property Highlights

Near the corner of 108th Ave. and 159th St., three medical office spaces ranging from 502 to 1,816 square feet are available for lease in the Winterset Office Park. The units are move-in ready with a common area lunchroom. Unit A features five exam rooms, a reception area and waiting room. Unit C has four exam rooms, a private office, medical records area, storage and handicap bathroom. Unit D is a mezzanine space with four offices.

Part of the southwest suburbs of Chicago, Orland Park is a growing, prosperous city. The city has three major commercial corridors, including 159th St. (US Hwy. 7).

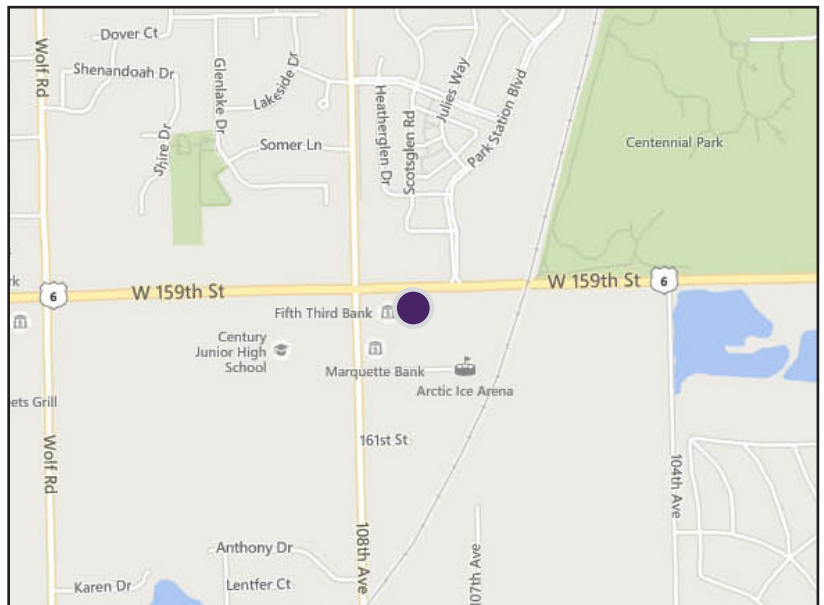

Disclaimer: Millennium Properties R/E is the owner's designated agent and makes no warranties or representations as to the accuracy or completeness of the information contained herein. The information has been obtained sources deemed reliable; however, it is up to the purchaser to conduct due diligence prior to sale.

Michael Mintz

Vice President

(312) 338 - 2578

mmintz@mpirealestate.com

**MILLENNIUM
PROPERTIES R/E**

Floor Plan: Units A & C

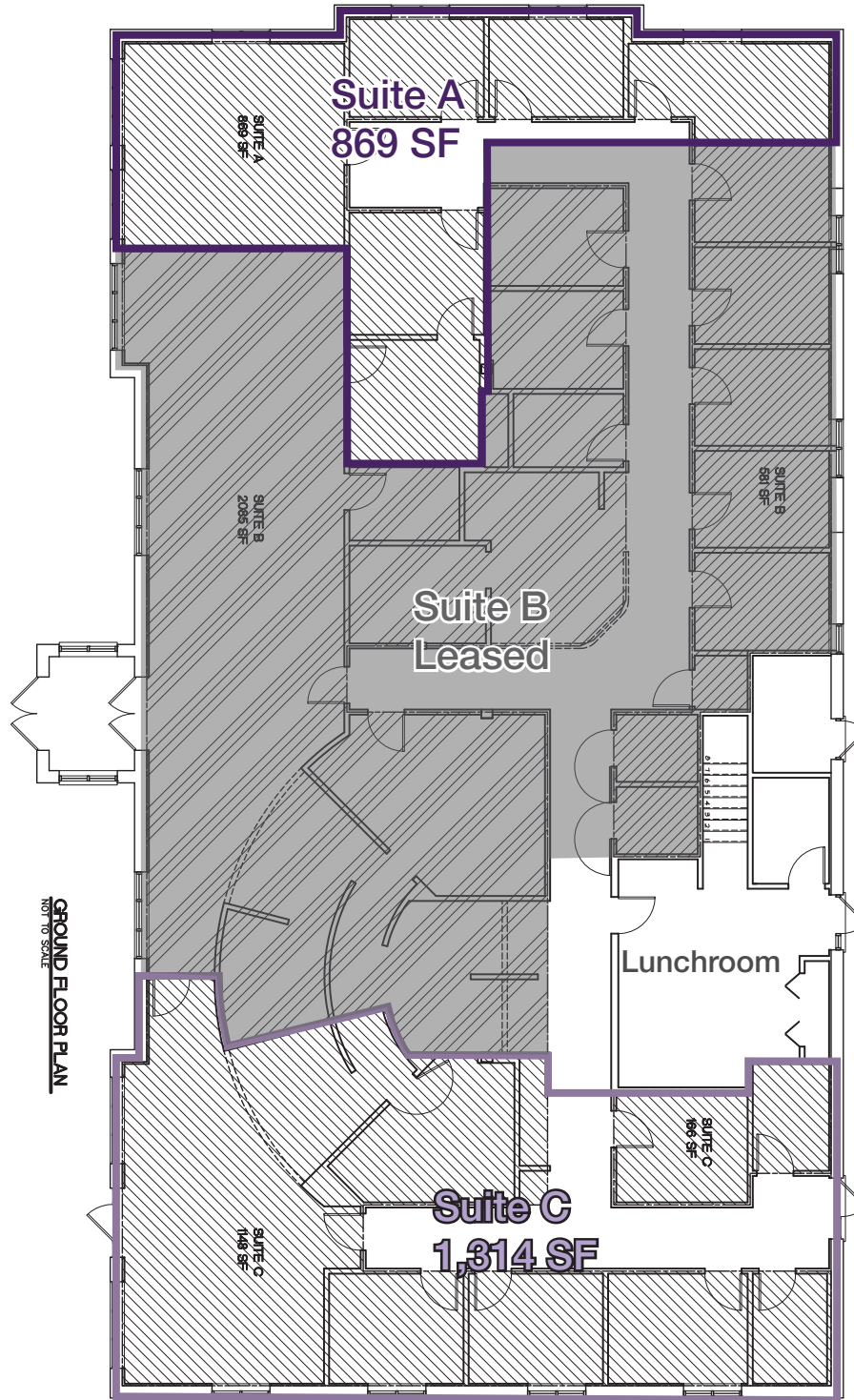

Disclaimer: Millennium Properties R/E is the owner's designated agent and makes no warranties or representations as to the accuracy or completeness of the information contained herein. The information has been obtained sources deemed reliable; however, it is up to the purchaser to conduct due diligence prior to sale.

