

8561 East Avenue

4,402± SF Office Space For Sale or Lease

Mentor, Ohio 44060 (Lake County)



8561 East Avenue, Mentor, Ohio 44060

Property Features:

- 4,402± SF Total Building
- .65± Acres
- Twelve (12) Total Offices (more possible)
- Subdivision Possible -
 - 2,380± SF - Unit 1
 - 2,000± SF - Unit 2
- Conference Room
- Full Kitchen
- One (1) Full Restroom
- One (1) Full Restroom with Shower
- Storage Area
- Outdoor Storage Shed
- Fenced Trash Area
- Large Parking Area
- Covered Outdoor Area with Picnic Table
- Close Proximity to SR 2 and Interstate 90 via SR 615 (Center St)

Sale Priced at \$375,000.00
Lease Price \$10.00 psf NNN

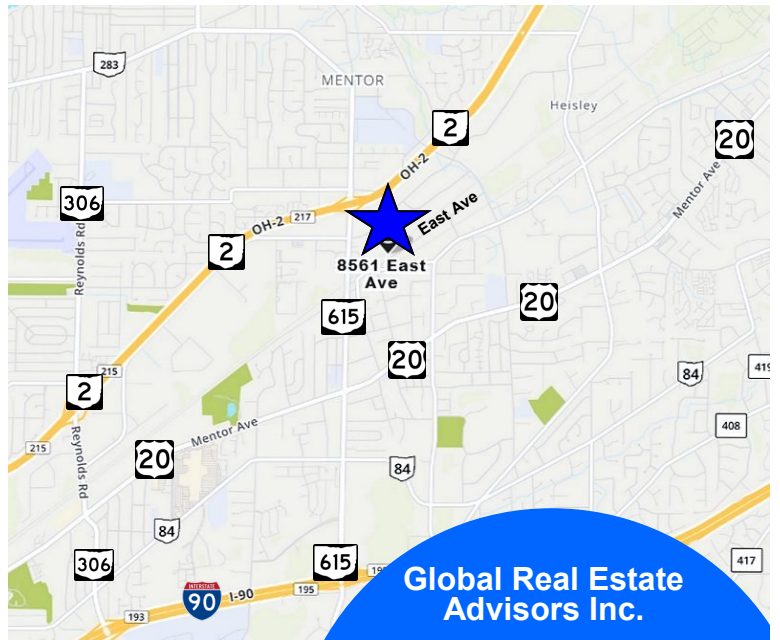

**Global Real Estate
Advisors Inc.**

Bruce Languth
440-255-5552 x 228
440-221-6297 Cell

Bruce@GlobalCommercialRE.com

Neil Sawicki, SIOR, Broker
440-255-5552 x 221
Neil@GlobalCommercialRE.com



GLOBAL

www.GlobalCommercialRE.com
8585 East Ave., Mentor, Ohio 44060

Real Estate Advisors Inc.
BROKER

This information has been secured from sources we believe are reliable, but we make no representations or warranties, expressed or implied, as to the accuracy of the information. References to condition, square footage or age are approximate. Buyer or Tenant acknowledges that they are relying on their own investigations and are not relying on Broker provided information. Procuring broker shall only be entitled to a commission, calculated in accordance with the rates approved by our principal only if such procuring broker executes a brokerage agreement acceptable to us and our principal and the conditions as set forth in the brokerage agreement are fully and unconditionally satisfied. Although all information furnished regarding property for sale, rental, or financing is from sources deemed reliable, such information has not been verified and no express representation is made nor is any to be implied as to the accuracy thereof and it is submitted subject to errors, omissions, change of price, rental or other conditions, prior sale, lease or financing, or withdrawal without notice and to any special conditions imposed by our principal.

8561 East Avenue

4,402± SF Office Space For Sale or Lease

Mentor, Ohio 44060 (Lake County)



GLOBAL

www.GlobalCommercialRE.com
8585 East Ave., Mentor, Ohio 44060

Real Estate Advisors Inc.
BROKER

**Global Real Estate
Advisors Inc.**

Bruce Languth
440-255-5552 x 228
440-221-6297 Cell

Bruce@GlobalCommercialRE.com

Neil Sawicki, SIOR, Broker
440-255-5552 x 221
Neil@GlobalCommercialRE.com

This information has been secured from sources we believe are reliable, but we make no representations or warranties, expressed or implied, as to the accuracy of the information. References to condition, square footage or age are approximate. Buyer or Tenant acknowledges that they are relying on their own investigations and are not relying on Broker provided information. Procuring broker shall only be entitled to a commission, calculated in accordance with the rates approved by our principal only if such procuring broker executes a brokerage agreement acceptable to us and our principal and the conditions as set forth in the brokerage agreement are fully and unconditionally satisfied. Although all information furnished regarding property for sale, rental, or financing is from sources deemed reliable, such information has not been verified and no express representation is made nor is any to be implied as to the accuracy thereof and it is submitted subject to errors, omissions, change of price, rental or other conditions, prior sale, lease or financing, or withdrawal without notice and to any special conditions imposed by our principal.

8561 East Avenue

4,402± SF Office Space For Sale or Lease

Mentor, Ohio 44060 (Lake County)

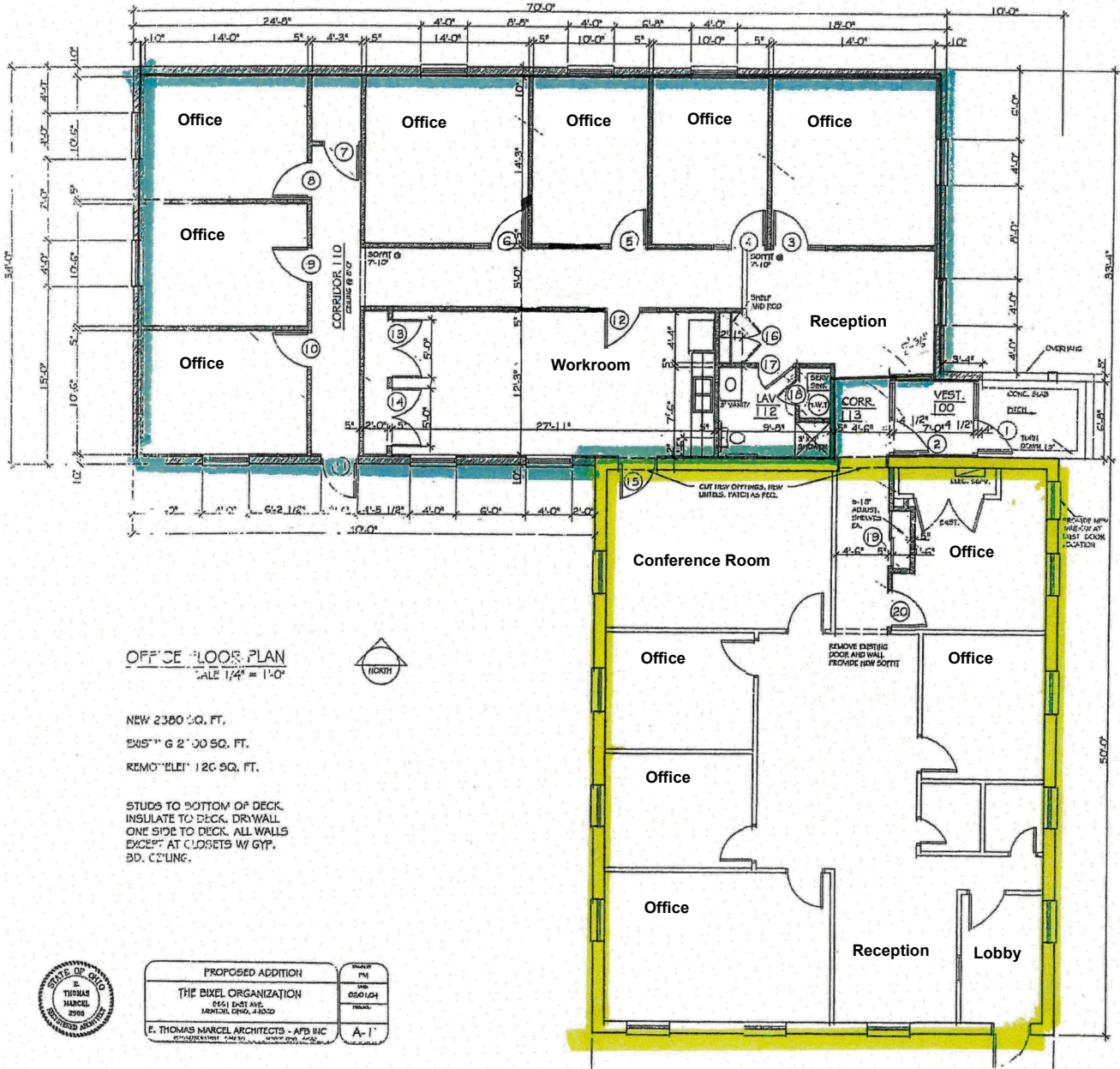

Global Real Estate
Advisors Inc.

Bruce Languth
440-255-5552 x 228
440-221-6297 Cell

Bruce@GlobalCommercialRE.com

Neil Sawicki, SIOR, Broker
440-255-5552 x 221
Neil@GlobalCommercialRE.com



www.GlobalCommercialRE.com
8585 East Ave., Mentor, Ohio 44060

Real Estate Advisors Inc.
BROKER

This information has been secured from sources we believe are reliable, but we make no representations or warranties, expressed or implied, as to the accuracy of the information. References to condition, square footage or age are approximate. Buyer or Tenant acknowledges that they are relying on their own investigations and are not relying on Broker provided information. Procuring broker shall only be entitled to a commission, calculated in accordance with the rates approved by our principal only if such procuring broker executes a brokerage agreement acceptable to us and our principal and the conditions as set forth in the brokerage agreement are fully and unconditionally satisfied. Although all information furnished regarding property for sale, rental, or financing is from sources deemed reliable, such information has not been verified and no express representation is made nor is any to be implied as to the accuracy thereof and it is submitted subject to errors, omissions, change of price, rental or other conditions, prior sale, lease or financing, or withdrawal without notice and to any special conditions imposed by our principal.

8561 East Avenue

4,402± SF Office Space For Sale or Lease

Mentor, Ohio 44060 (Lake County)



www.GlobalCommercialRE.com
8585 East Ave., Mentor, Ohio 44060

Real Estate Advisors Inc.
BROKER

Global Real Estate
Advisors Inc.

Bruce Languth

440-255-5552 x 228

440-221-6297 Cell

Bruce@GlobalCommercialRE.com

Neil Sawicki, SIOR, Broker

440-255-5552 x 221

Neil@GlobalCommercialRE.com

This information has been secured from sources we believe are reliable, but we make no representations or warranties, expressed or implied, as to the accuracy of the information. References to condition, square footage or age are approximate. Buyer or Tenant acknowledges that they are relying on their own investigations and are not relying on Broker provided information. Procuring broker shall only be entitled to a commission, calculated in accordance with the rates approved by our principal only if such procuring broker executes a brokerage agreement acceptable to us and our principal and the conditions as set forth in the brokerage agreement are fully and unconditionally satisfied. Although all information furnished regarding property for sale, rental, or financing is from sources deemed reliable, such information has not been verified and no express representation is made nor is any to be implied as to the accuracy thereof and it is submitted subject to errors, omissions, change of price, rental or other conditions, prior sale, lease or financing, or withdrawal without notice and to any special conditions imposed by our principal.