



ZOLTAR BUILDING

12901 16th AVENUE N | PLYMOUTH, MN 55441



Newmark
Knight Frank

ZOLTAR BUILDING

12901 16th AVENUE N | PLYMOUTH, MN 55441



FOR SALE OR LEASE



SITE SIZE:

2.41 AC

AVAILABLE SPACE:

5,873 SF to 23,973 SF

16,066 SF - Office

7,907 SF - Warehouse

23,973 SF - Total

ASKING PRICE:

\$2,375,000 (\$99/SF)

ASKING RATES:

\$9.75/SF - Office

\$4.75/SF - Warehouse

2019 EST. TAX & CAM:

\$3.76/SF

PROPERTY HIGHLIGHTS

- Approx. 23,973 rentable square feet
- 60 free surface parking stalls
- Four (4) exterior docks
- Two (2) drive-in doors
- 13' 2" clear height
- Zoned I-2 General Industrial
- Easy access to I-494 and Hwy 55
- Located just 12 miles northwest of Minneapolis
- Plymouth is home to a thriving industrial-commercial base

FLOOR PLAN

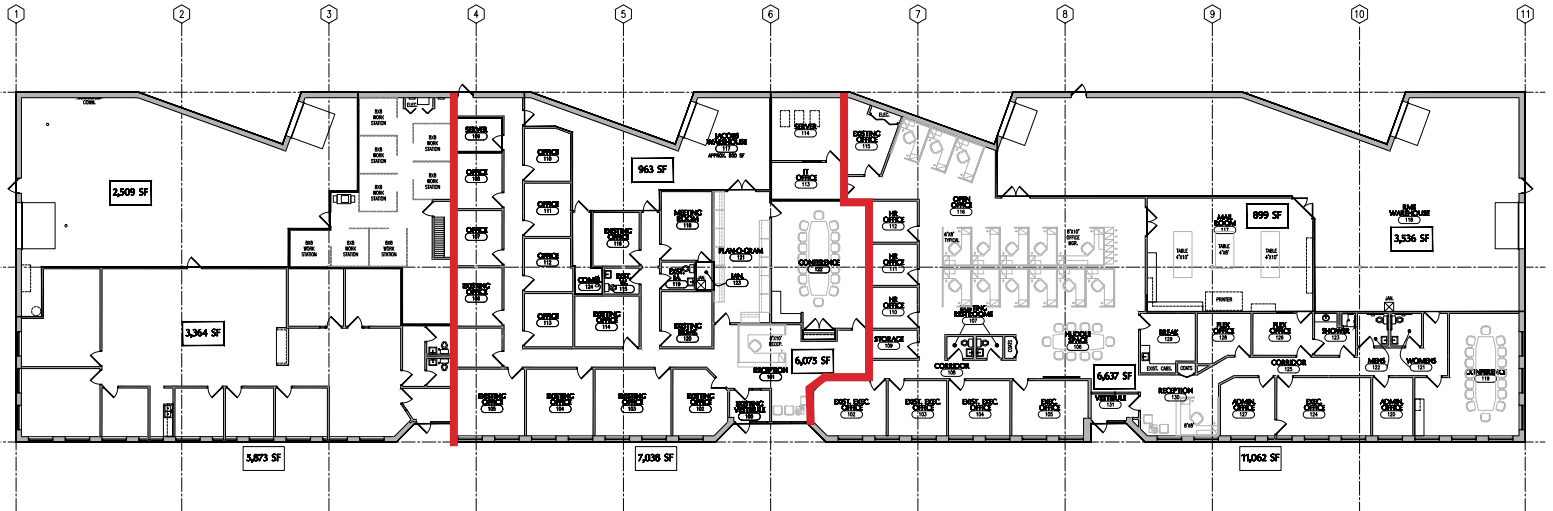

Suite A
 3,367 SF - Office
 2,506 SF - Warehouse
 5,873 SF - Total
 1 Dock & 1 Drive-In

Suite B
 6,075 SF - Office
 963 SF - Warehouse
 7,038 SF - Total
 1 Dock

Suite C
 7,526 SF - Office
 3,536 SF - Warehouse
 11,062 SF - Total
 2 Docks & 1 Drive-In

AERIAL



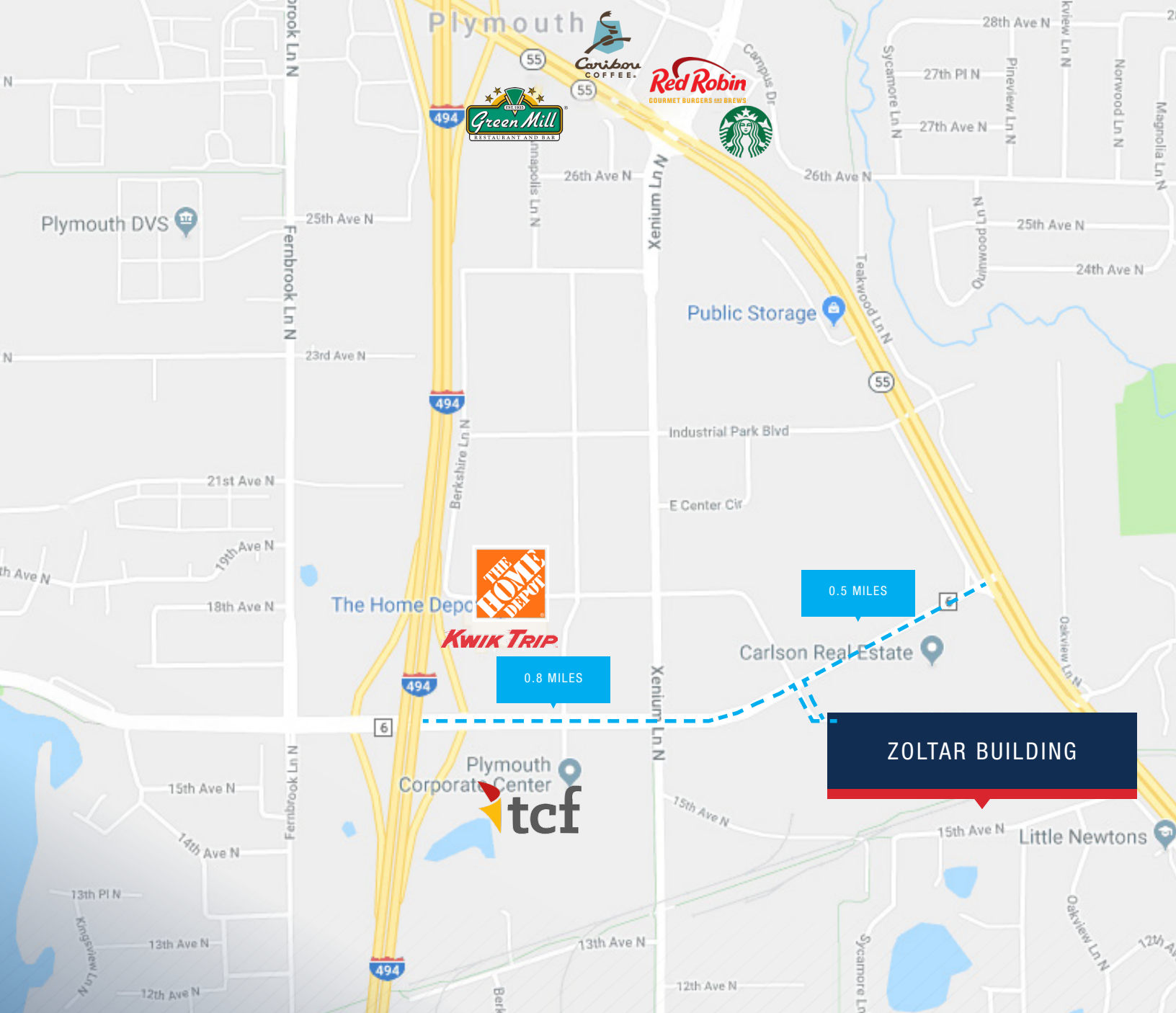

ZOLTAR BUILDING

PETER TANIS, CCIM
Managing Director
T +1 612 430 9941
peter.tanis@ngkf.com

BRIAN NETZ
Senior Managing Director
T +1 612 430 9947
brian.netz@ngkf.com

KYLE DELAROSBY
Associate
T +1 612 440 0039
kyle.delarosby@ngkf.com

www.ngkf.com

The information contained herein has been obtained from sources deemed reliable but has not been verified and no guarantee, warranty or representation, either express or implied, is made with respect to such information. Terms of sale or lease and availability are subject to change or withdrawal without notice.

