

# 13257 KIRKHAM WAY POWAY, CA 92064

33,653 SF LIGHT INDUSTRIAL BUILDING  
FOR SALE/LEASE



CORNER OF KIRKHAM WAY & TECH CENTER COURT



## PROPERTY FEATURES

<b>FOR SALE/LEASE</b>	33,653 SF
<b>LEASE RATE</b>	\$.85/SF NNN
<b>NNN</b>	\$.13/SF
<b>SALE RATE</b>	\$5,000,000

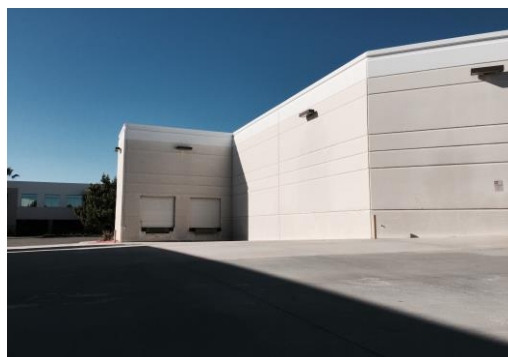

## PROPERTY FEATURES

- 25,980 SF Warehouse
- 4,612 SF Office
- 3,061 SF Mezzanine
- 22' Min/24' Average Clear Height
- 1600 A 120/208 3 Phase Power
- 2 Dock High and 3 Grade Level Truck Loading Doors
- Fully Sprinklered, .45/3000 GPM
- Good Divisibility
- 2014 Energy Efficient Warehouse Lighting – T5 w/Occupancy Sensors
- Great Window Line
- Concrete Parking
- 2/1,000 Parking Ratio

For more information, please contact:

**MICKEY MORERA**  
Executive Director  
(858) 558 5639  
mickey.morera@cushwake.com  
Lic. #950071

**ERIC HUTCHISON**  
Principal  
(619) 246 6161  
eric@commercialwestrealty.com  
Lic. #01197250

**CUSHMAN & WAKEFIELD  
OF SAN DIEGO, INC.**  
Lic. #01329963  
4747 Executive Drive, 9<sup>th</sup> Floor  
San Diego, CA 92121  
www.cushmanwakefield.com

**Commercial West Realty**  
DRE Corporate Lic #01834910  
909 San Dieguito Dr.  
Encinitas, California 92024  
office: (619) 717-6009  
www.commercialwestrealty.com

The depiction in the included photograph of any person, entity, sign, logo or property, other than Cushman & Wakefield's (C&W) client and the property offered by C&W, is incidental only, and is not intended to connote any affiliation, connection, association, sponsorship or approval by or between that which is incidentally depicted and C&W or its client. This listing shall not be deemed an offer to lease, sublease or sell such property; and, in the event of any transaction for such property, no commission shall be earned by or payable to any cooperating broker except if otherwise provided pursuant to the express terms, rates and conditions of C&W's agreement with its principal, if, as and when such commission (if any) is actually received from such principal. (A copy of the rates and conditions referred to above with respect to this property is available upon request.)

# 13257 KIRKHAM WAY

## Light Industrial Building For Sale/Lease

33,653 SF  
AVAILABLE

### FLOOR PLAN

- 2 Loading Docks with Levelers
- 5 Motorized Truck Doors
- 8 6'x6' Operable Warehouse Vent Windows
- Excellent Skylight Coverage

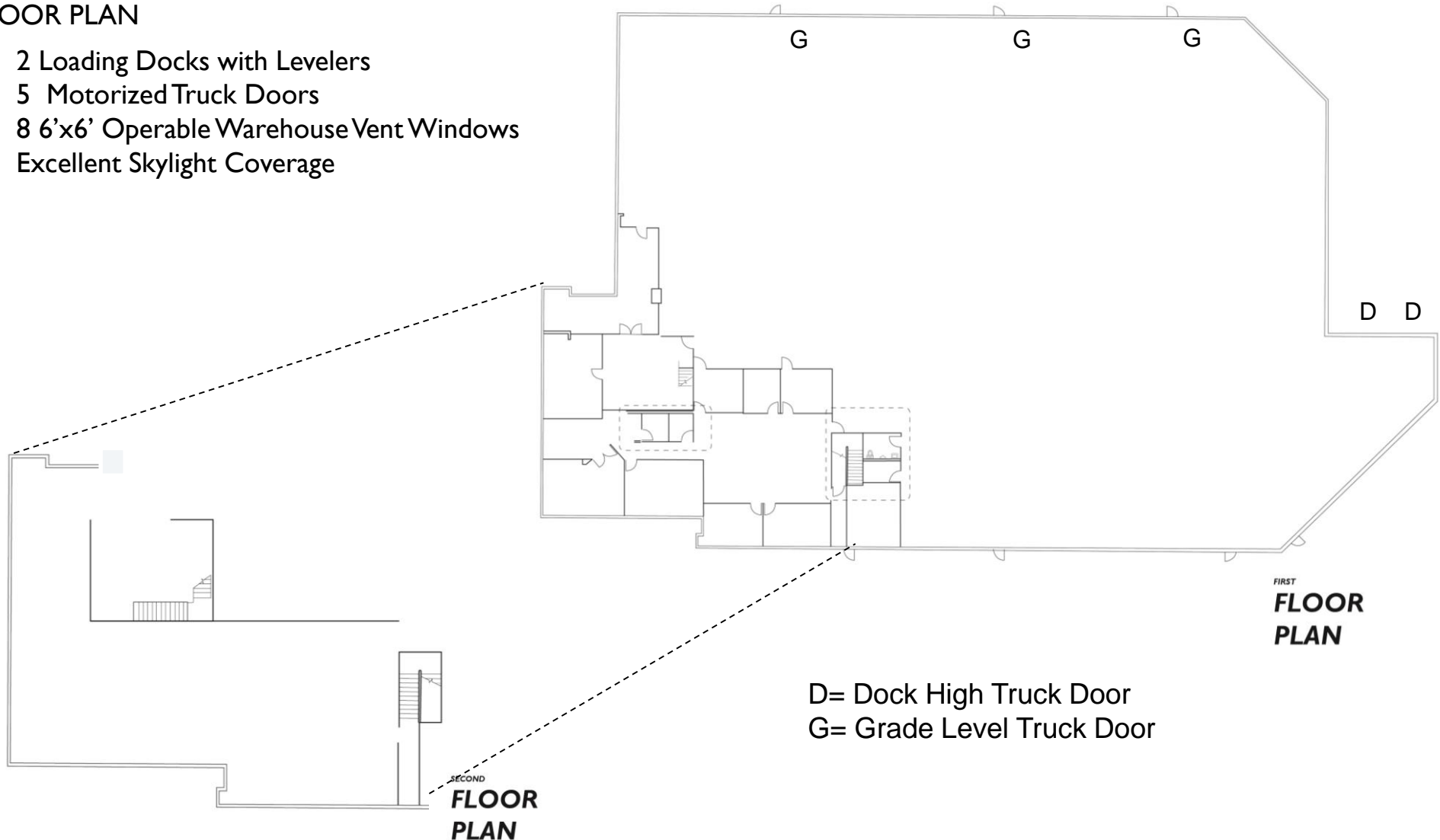

D= Dock High Truck Door  
G= Grade Level Truck Door

For more information, please contact:

**MICKEY MORERA**  
Executive Director  
(858) 558 5639  
mickey.morera@cushwake.com  
Lic. #950071

**ERIC HUTCHISON**  
Principal  
(619) 246 6161  
eric@commercialwestrealty.com  
Lic. #01197250

**CUSHMAN & WAKEFIELD  
OF SAN DIEGO, INC.**

Lic. #01329963  
4747 Executive Drive, 9<sup>th</sup> Floor  
San Diego, CA 92121  
[www.cushmanwakefield.com](http://www.cushmanwakefield.com)

**Commercial West Realty**

DRE Corporate Lic #01834910  
909 San Dieguito Dr.  
Encinitas, California 92024  
office: (619) 717-6009  
[www.commercialwestrealty.com](http://www.commercialwestrealty.com)

The depiction in the included photograph of any person, entity, sign, logo or property, other than Cushman & Wakefield's (C&W) client and the property offered by C&W, is incidental only, and is not intended to connote any affiliation, connection, association, sponsorship or approval by or between that which is incidentally depicted and C&W or its client. This listing shall not be deemed an offer to lease, sublease or sell such property; and, in the event of any transaction for such property, no commission shall be earned by or payable to any cooperating broker except if otherwise provided pursuant to the express terms, rates and conditions of C&W's agreement with its principal, if, as and when such commission (if any) is actually received from such principal. (A copy of the rates and conditions referred to above with respect to this property is available upon request.)

# 13257 KIRKHAM WAY

## Light Industrial Building For Sale/Lease

33,653 SF  
AVAILABLE

### SITE PLAN

**APN:** 320-220-15-00

**Lot Size:** 1.97 Acre  
85,813 SF

**Parking:** 68 Spaces

**Divisibility:** Additional glass entry & sewer line placement

**Power:** Expandable with existing second meter box and conduit

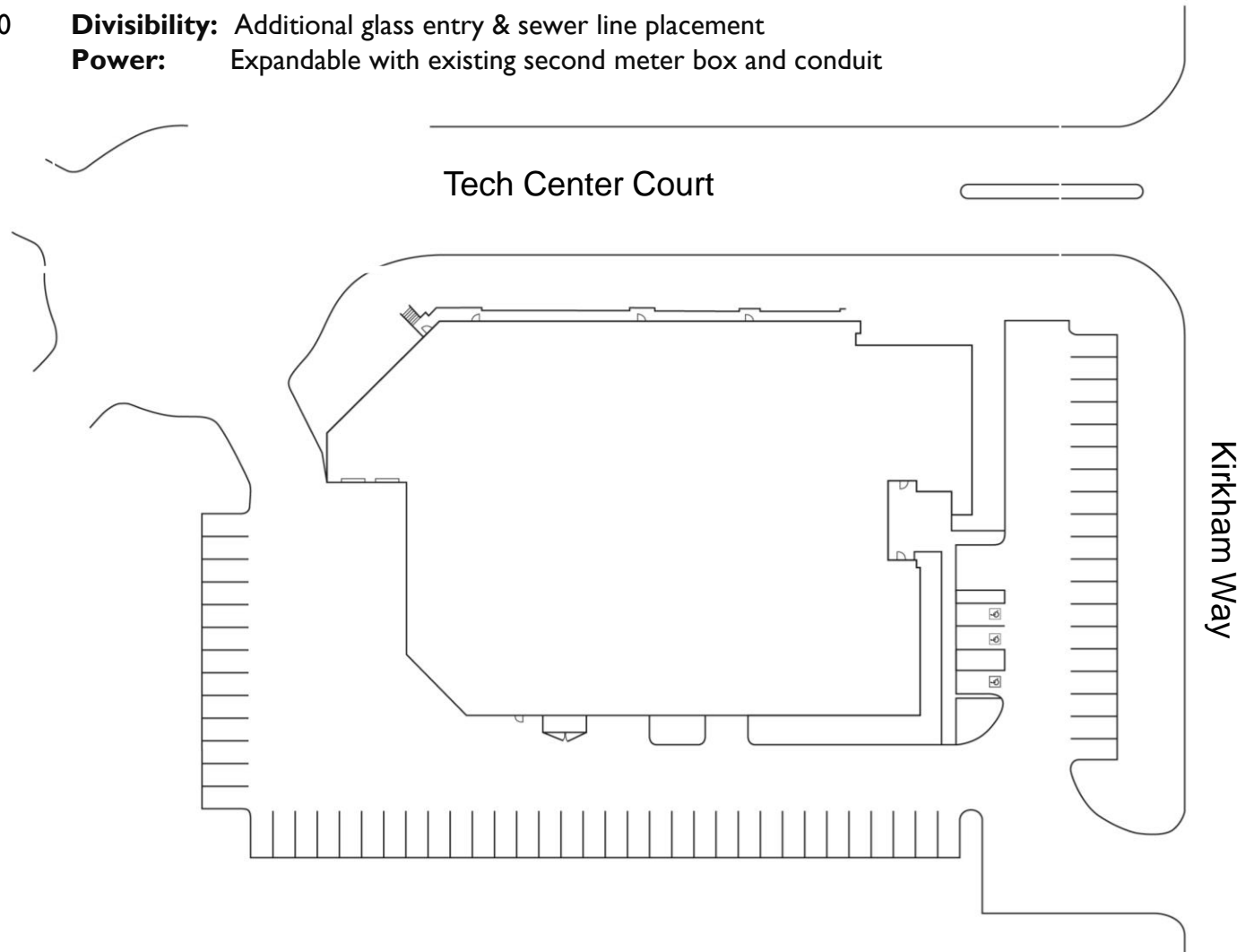

For more information, please contact:

**MICKEY MORERA**  
Executive Director  
(858) 558 5639  
mickey.morera@cushwake.com  
Lic. #950071

**ERIC HUTCHISON**  
Principal  
(619) 246 6161  
eric@commercialwestrealty.com  
Lic. #01197250

**CUSHMAN & WAKEFIELD  
OF SAN DIEGO, INC.**

Lic. #01329963

4747 Executive Drive, 9<sup>th</sup> Floor  
San Diego, CA 92121

[www.cushmanwakefield.com](http://www.cushmanwakefield.com)

**Commercial West Realty**

DRE Corporate Lic #01834910  
909 San Dieguito Dr.  
Encinitas, California 92024

office: (619) 717-6009

[www.commercialwestrealty.com](http://www.commercialwestrealty.com)

The depiction in the included photograph of any person, entity, sign, logo or property, other than Cushman & Wakefield's (C&W) client and the property offered by C&W, is incidental only, and is not intended to connote any affiliation, connection, association, sponsorship or approval by or between that which is incidentally depicted and C&W or its client. This listing shall not be deemed an offer to lease, sublease or sell such property; and, in the event of any transaction for such property, no commission shall be earned by or payable to any cooperating broker except if otherwise provided pursuant to the express terms, rates and conditions of C&W's agreement with its principal, if, as and when such commission (if any) is actually received from such principal. (A copy of the rates and conditions referred to above with respect to this property is available upon request.)



# 13257 KIRKHAM WAY

## Light Industrial Building For Sale/Lease

33,653 SF  
AVAILABLE

### AERIAL OVERVIEW



For more information, please contact:

**MICKEY MORERA**  
Executive Director  
(858) 558 5639  
mickey.morera@cushwake.com  
Lic. #950071

**ERIC HUTCHISON**  
Principal  
(619) 246 6161  
eric@commercialwestrealty.com  
Lic. #01197250

**CUSHMAN & WAKEFIELD  
OF SAN DIEGO, INC.**  
Lic. #01329963  
4747 Executive Drive, 9<sup>th</sup> Floor  
San Diego, CA 92121  
[www.cushmanwakefield.com](http://www.cushmanwakefield.com)

**Commercial West Realty**  
DRE Corporate Lic #01834910  
909 San Dieguito Dr.  
Encinitas, California 92024  
office: (619) 717-6009  
[www.commercialwestrealty.com](http://www.commercialwestrealty.com)

The depiction in the included photograph of any person, entity, sign, logo or property, other than Cushman & Wakefield's (C&W) client and the property offered by C&W, is incidental only, and is not intended to connote any affiliation, connection, association, sponsorship or approval by or between that which is incidentally depicted and C&W or its client. This listing shall not be deemed an offer to lease, sublease or sell such property; and, in the event of any transaction for such property, no commission shall be earned by or payable to any cooperating broker except if otherwise provided pursuant to the express terms, rates and conditions of C&W's agreement with its principal, if, as and when such commission (if any) is actually received from such principal. (A copy of the rates and conditions referred to above with respect to this property is available upon request.)