

PRIME RETAIL SPACE ADJACENT TO KOHL'S

Altamonte Springs, FL 32714 | 945 W State Road 436, | State Rd 436 & State Rd 434 | #798

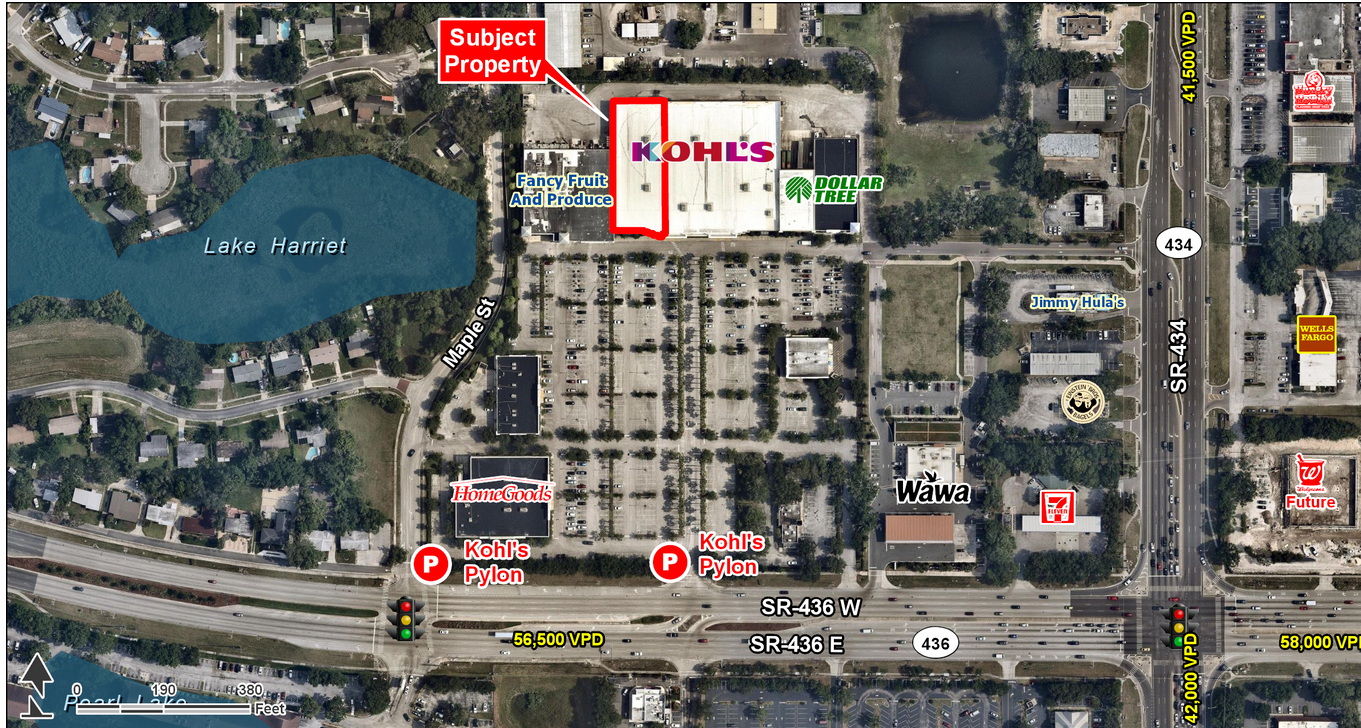

- GLA: 172,072
- 24,100 SF available
- Jr. Anchor space available next to Kohl's
- Located on the NWQ of State Road 436 and State Road 434
- Excellent co-tenancy including HomeGoods, Fancy Fruit, Dollar Tree

DEMOGRAPHICS	1 MILE	3 MILES	5 MILES
2018 TOTAL POPULATION	13,390	104,730	215,789
2018 DAYTIME POPULATION	13,803	112,122	236,115
2018 AVERAGE HH INCOME	68,439	79,410	76,731
2018 MEDIAN HH INCOME	54,470	57,113	54,710

TRAFFIC COUNTS	
State Road 436	56,500 VPD
State Road 434	41,500 VPD

AVAILABLE SF:
24,100 SF

FRONTAGE:
APPROX 97' 9"

ZONING:
COMMERCIAL

RATES:
CALL FOR DETAILS

AREA ANCHORS



FOR MORE INFORMATION, CONTACT EXCLUSIVE AGENT(S):
GAVIN WALSH • gavin.walsh@tscg.com • 407.788.0543



PRIME RETAIL SPACE ADJACENT TO KOHL'S

Altamonte Springs, FL 32714 | 945 W State Road 436, | State Rd 436 & State Rd 434 | #798

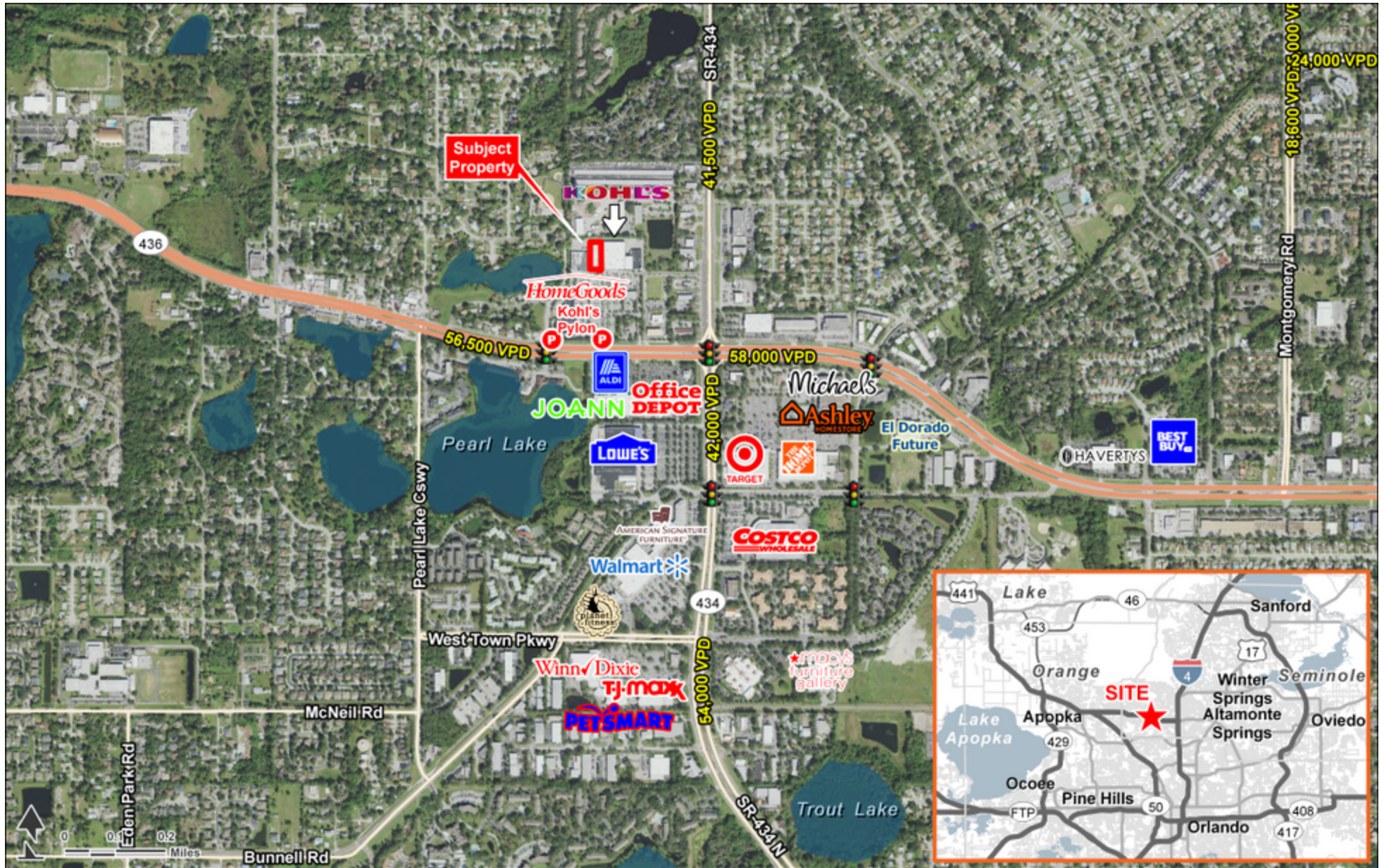

FOR MORE INFORMATION, CONTACT EXCLUSIVE AGENT(S):
GAVIN WALSH • gavin.walsh@tscg.com • 407.788.0543



PRIME RETAIL SPACE ADJACENT TO KOHL'S

Altamonte Springs, FL 32714 | 945 W State Road 436, | State Rd 436 & State Rd 434 | #798



FOR MORE INFORMATION, CONTACT EXCLUSIVE AGENT(S):
GAVIN WALSH • gavin.walsh@tscg.com • 407.788.0543



Demographics: Esri 2018 No warranty expressed or implied has been made as to the accuracy of the information provided herein, no liability assumed for error or omissions.

PRIME RETAIL SPACE ADJACENT TO KOHL'S

Altamonte Springs, FL 32714 | 945 W State Road 436, | State Rd 436 & State Rd 434 | #798

#10798 Altamonte Springs, FL
Updated: 3/14/18

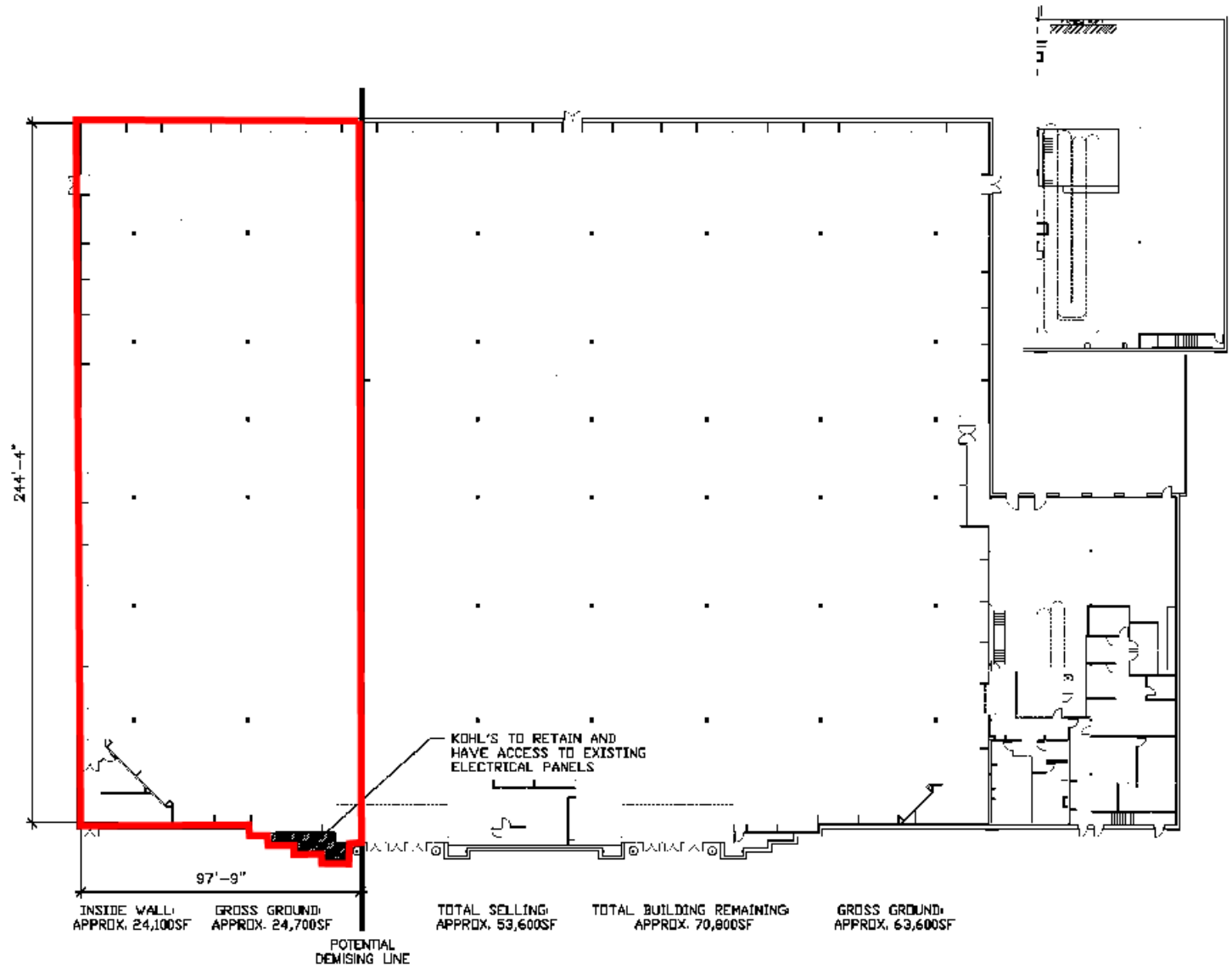

FOR MORE INFORMATION, CONTACT EXCLUSIVE AGENT(S):
GAVIN WALSH • gavin.walsh@tscg.com • 407.788.0543

