

MCKEE MEDICAL CENTER

2360 MCKEE ROAD, SAN JOSE, CA

±1,381 SF MEDICAL OFFICE FOR SALE

CLARK STEELE

+1 408 436 3653

clark.steele@cushwake.com

LIC #01995379

CARRICK YOUNG

+1 408 436 3645

carrick.young@cushwake.com

LIC #02018252



**CUSHMAN &
WAKEFIELD**

HIGHLIGHTS

- Suite 7: ±1,381 RSF
- 2nd Floor Unit Near Elevator
- Private Employee Entrance
- Plumbing in All Exam Rooms
- Extensive Glass Line & Corner Unit
- Ample Parking On-Site
- Elevator Served
- Shared Common Waiting Areas
- 1/3 Mile to Regional Medical Center
- Restaurants, Coffee Shops and More Amenities Nearby
- Direct Access to Highway 680

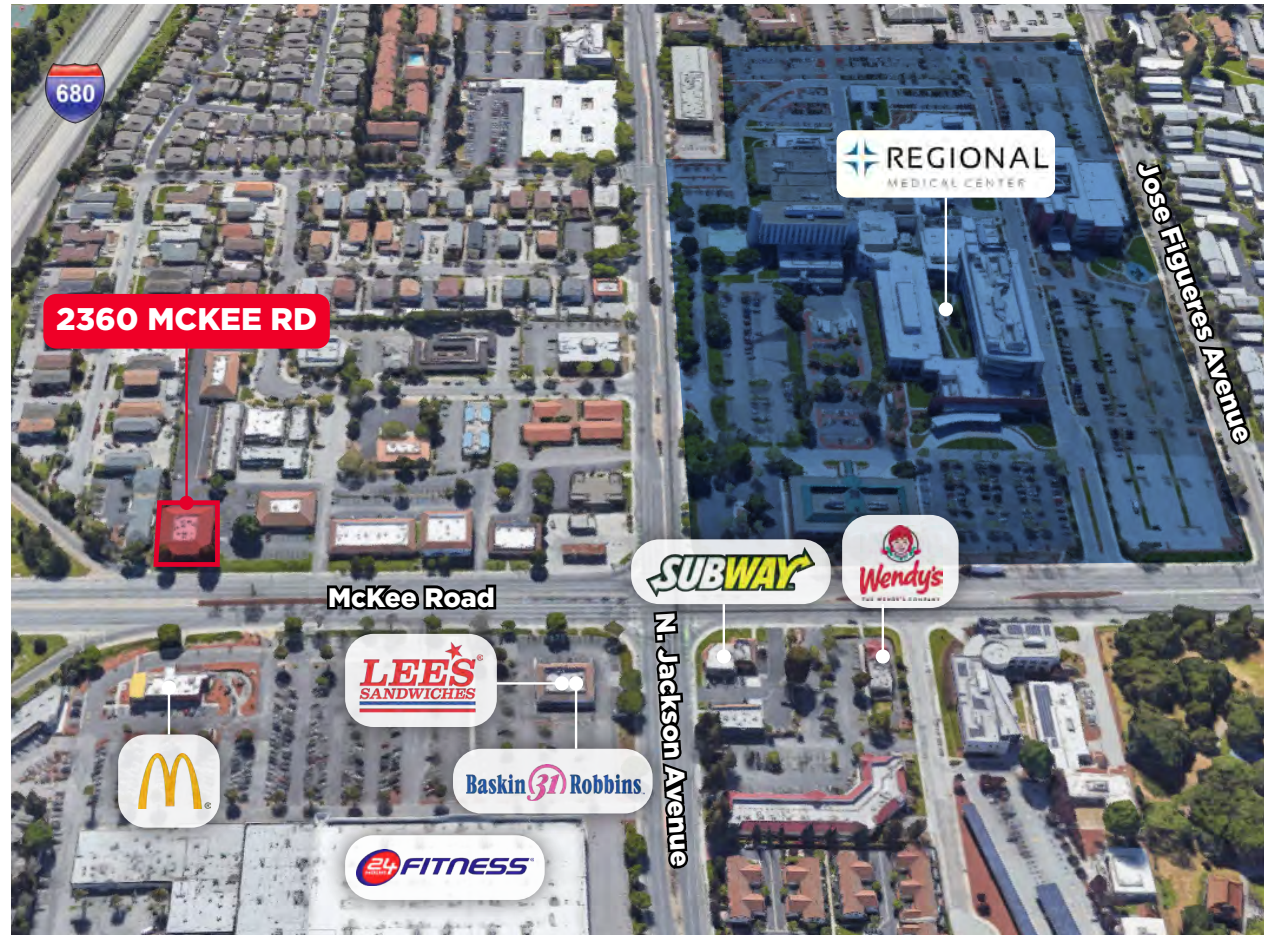



FLOOR PLAN

- ±1,381 RSF
- Lobby/Reception Area
- 5 Exam Rooms
- All Exam Rooms Plumbed
- Break Room
- Private Employee Entrance
- Storage

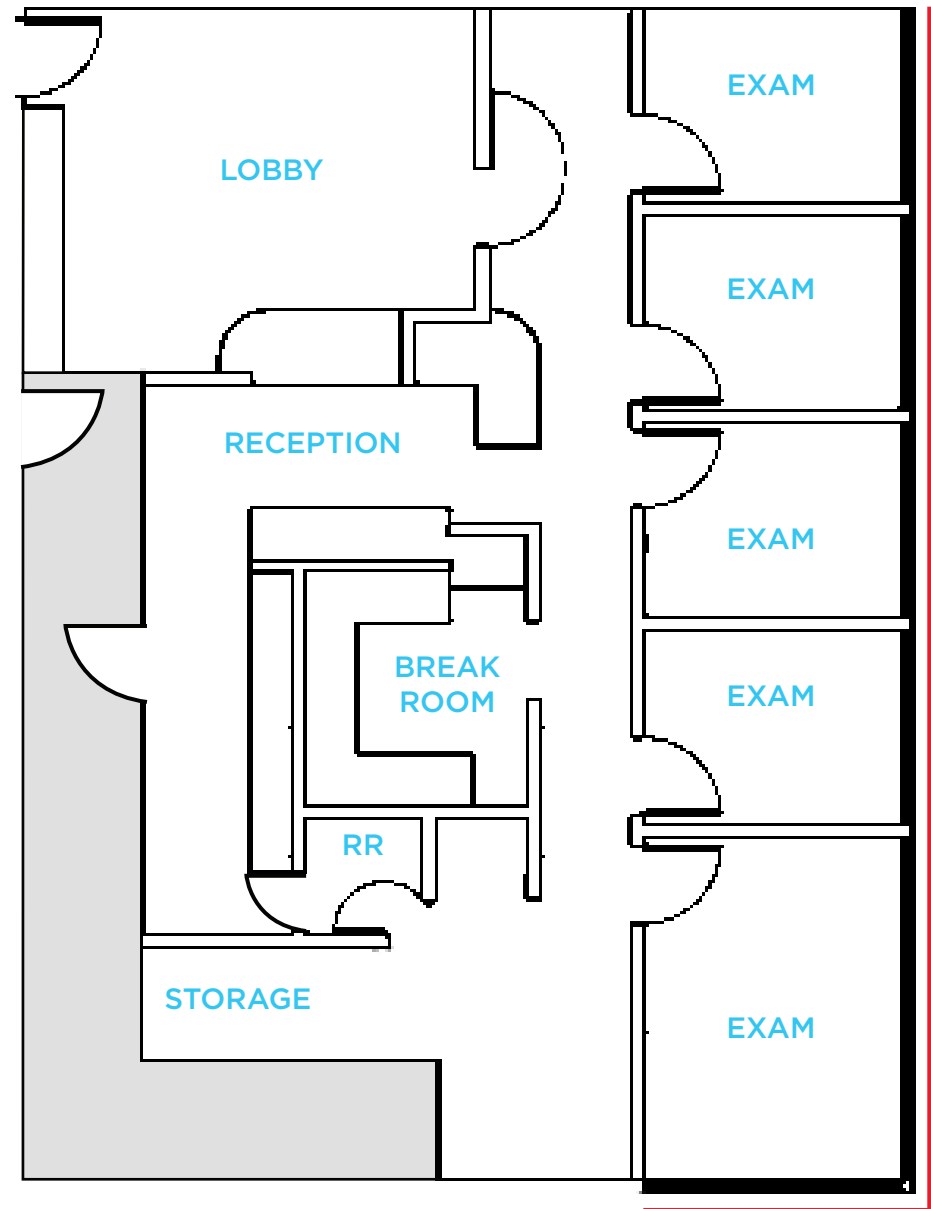

- WINDOW LINE
- COMMON AREA

MCKEE MEDICAL CENTER

2360 MCKEE ROAD, SAN JOSE, CA

CLARK STEELE

+1 408 436 3653

clark.steele@cushwake.com

LIC #01995379

CARRICK YOUNG

+1 408 436 3645

carrick.young@cushwake.com

LIC #02018252

