

60 W 56TH STREET

LOCATED BETWEEN FIFTH AND SIXTH AVENUES

Tel: 957-9081/2

GLAZE
TERIYAKI

RETAIL
SPACE
GLAZE
AVAILABLE

CONTACT EXCLUSIVE AGENT:

212.223.2200

Zelnik & Company
REAL ESTATE

APPROXIMATE SIZE:

768 sq. ft. - Ground Fl

763sq. ft. - Basement

FRONTAGE:

12'

ASKING RENT:

Upon request

NEIGHBORS INCLUDE:

Benihana

Starbucks

Chipotle

Zibetto Espresso Bar

Davidoff of Geneva

Chase

Fresh & Co

COMMENTS:

- Formerly GLAZE
- All uses considered
- Venting in place
- Visible from Sixth Avenue
- Available for immediate possession

1/4 mile radius



89,622

Employees



\$215,523

Avg. Household Income



7,148

Residential Population

MASS TRANSPORTATION:

57th Street (F)

2,254,820 annual riders

MIDTOWN RETAIL SPACE AVAILABLE

60 W 56TH STREET

Located between Fifth & Sixth Avenues



BASEMENT

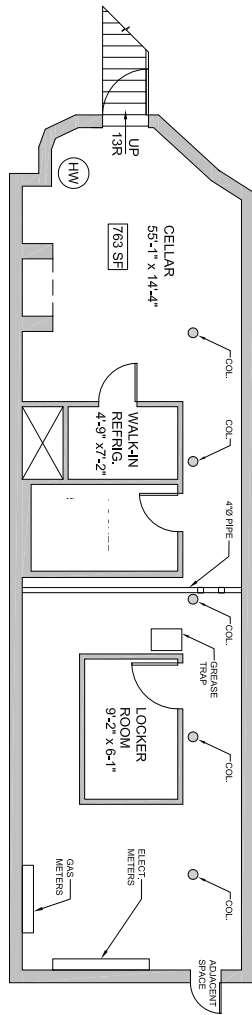

GROUND

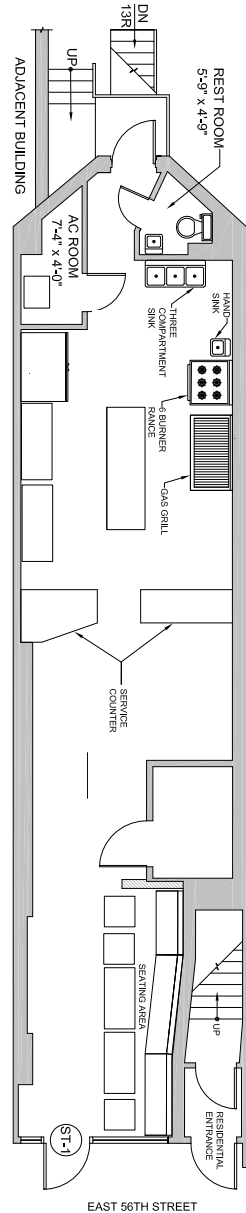

CONTACT EXCLUSIVE AGENTS

Cory G. Zelnik
cory@zelnikco.com

Zelnik & Company LLC
(212) 223-2200

Jason Turner
jason@zelnikco.com