



4,500 SQ. FT. FORMER COMMERCIAL KITCHEN FOR LEASE

7326 S. BROADWAY, LOS ANGELES, CA 90003

Commercial Asset Group
4558 Sherman Oaks Ave, 2nd Floor
Sherman Oaks, CA 91403
Phone: 818.385.1414

Paul Herman
Managing Director
Phone: 818.304.8386
Email: paulh@cag-re.com

cag | COMMERCIAL
ASSET GROUP



4,500 SQ. FT. FREE STANDING CONCRETE BLOCK BUILDING

7326 S. BROADWAY, LOS ANGELES, CA 90003

Highlights:

- Located 2 Blocks From the 110 Freeway
- 10 Minutes from DTLA
- Previously Used as Commercial Kitchen
- Zone: C2

Improvements Include:

- Commercial Hood and Floor Drains
- 200+ Sq. Ft. Walk-In Cooler
- 500 Sq. Ft. of Offices
- 2 Restrooms
- Full HVAC
- 200 Amp 240 Volt 3 Phase Power
- 1,900 Sq. Ft. Fenced Yard

Lease Terms:

\$1.00 PSF Industrial Gross/(\$4,500.00) Per Month
3-5 Years w/Annual Cost of Living Adjustments
Sec. Deposit Subject to Financials

- Prior Food Uses Included Coffee Roasting and Head Start Lunch Prep
- Possible Uses Include Commercial/Test/Prep Kitchen, Commissary, Catering...
- Prospective Tenants to Verify All Uses w/City of Los Angeles
- Prospective Tenants to Verify All Food Uses w/LA County Health Dept.
- Landlord/Broker DO NOT WARRANT Suitability of Any Uses

SITE PLAN

7326 S. BROADWAY, LOS ANGELES, CA 90003

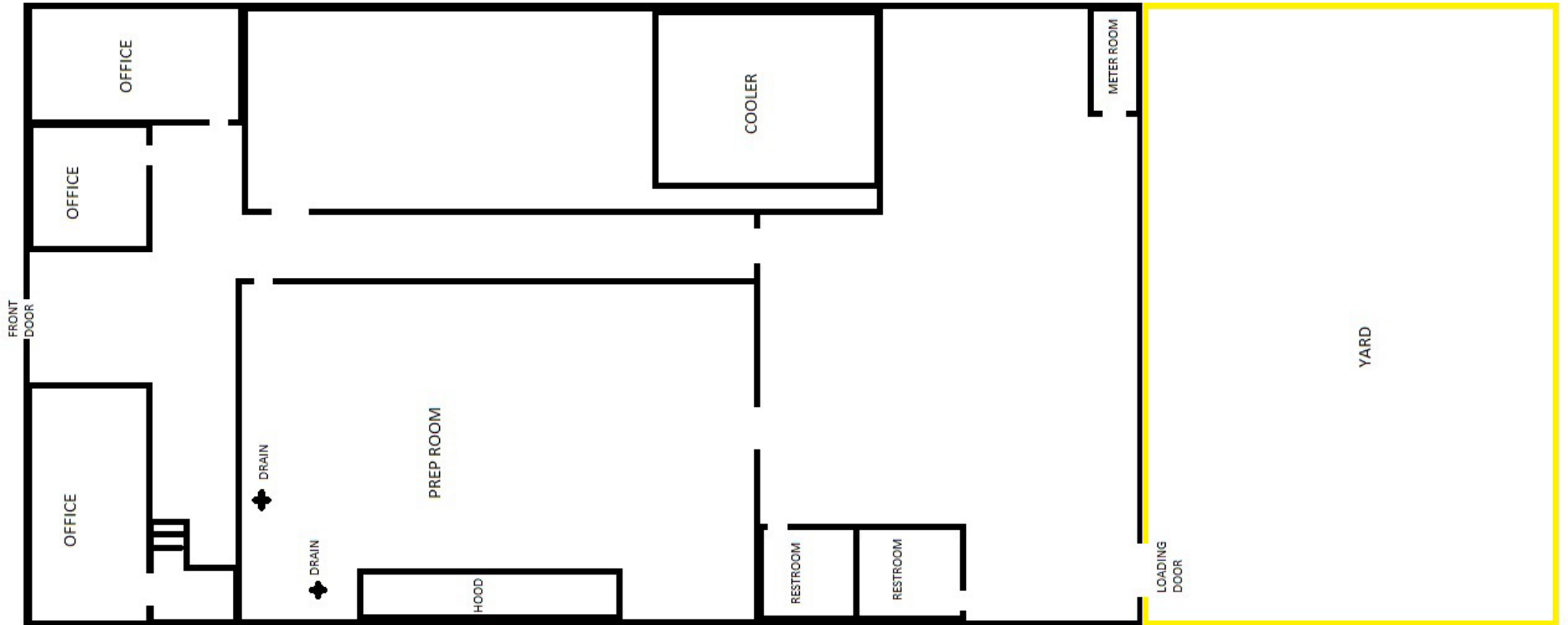

AERIALS

7326 S. BROADWAY, LOS ANGELES, CA 90003

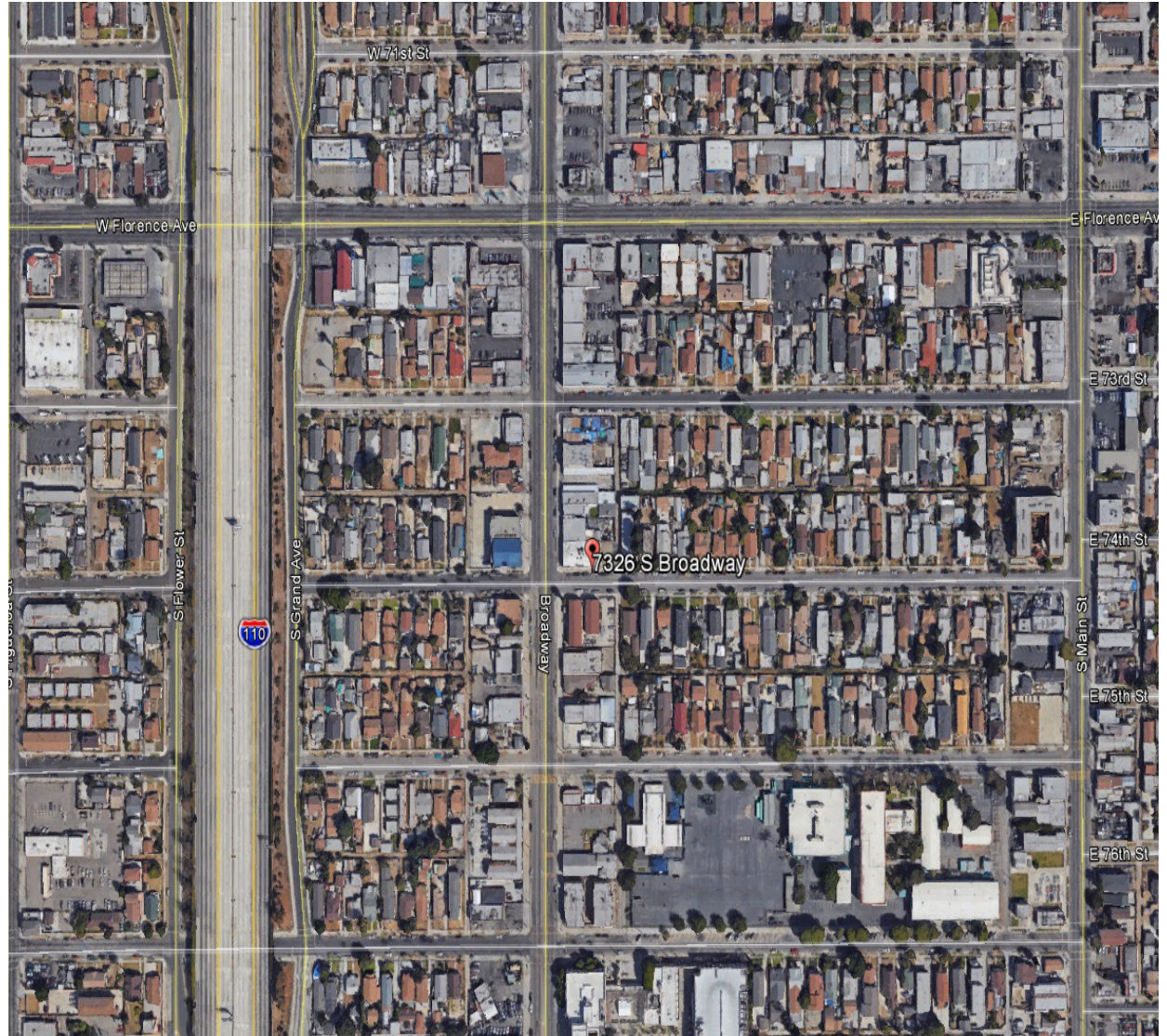
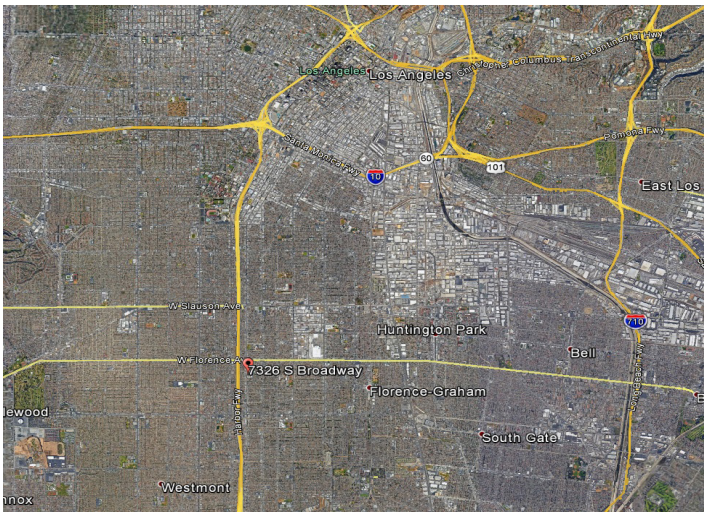



For more information, please call.



Commercial Asset Group
4558 Sherman Oaks Ave, 2nd Floor
Sherman Oaks, CA 91403
Phone: 818.385.1414
www.cag-re.com
Lic. 01876070

Paul Herman
Managing Director
Phone: 818.304.8386
Email: paulh@cag-re.com
Lic. 01398183

These materials are based on information and content provided by others, which we believe are accurate. No guarantee, warranty or representation is made by Commercial Asset Group, Inc. or its personnel. All interested parties must independently verify accuracy and completeness. As well, any projections, assumptions, opinion, or estimates are used for example only and do not represent the current or future performance of the identified property. Your tax, financial, legal and toxic substance advisors should conduct a careful investigation of the property and its suitability for your needs, including land use limitations. The property is subject to prior lease, sale, change in price, or withdrawal from the market without notice.