

2599

Broadway

Southwest Corner of West 98th Street

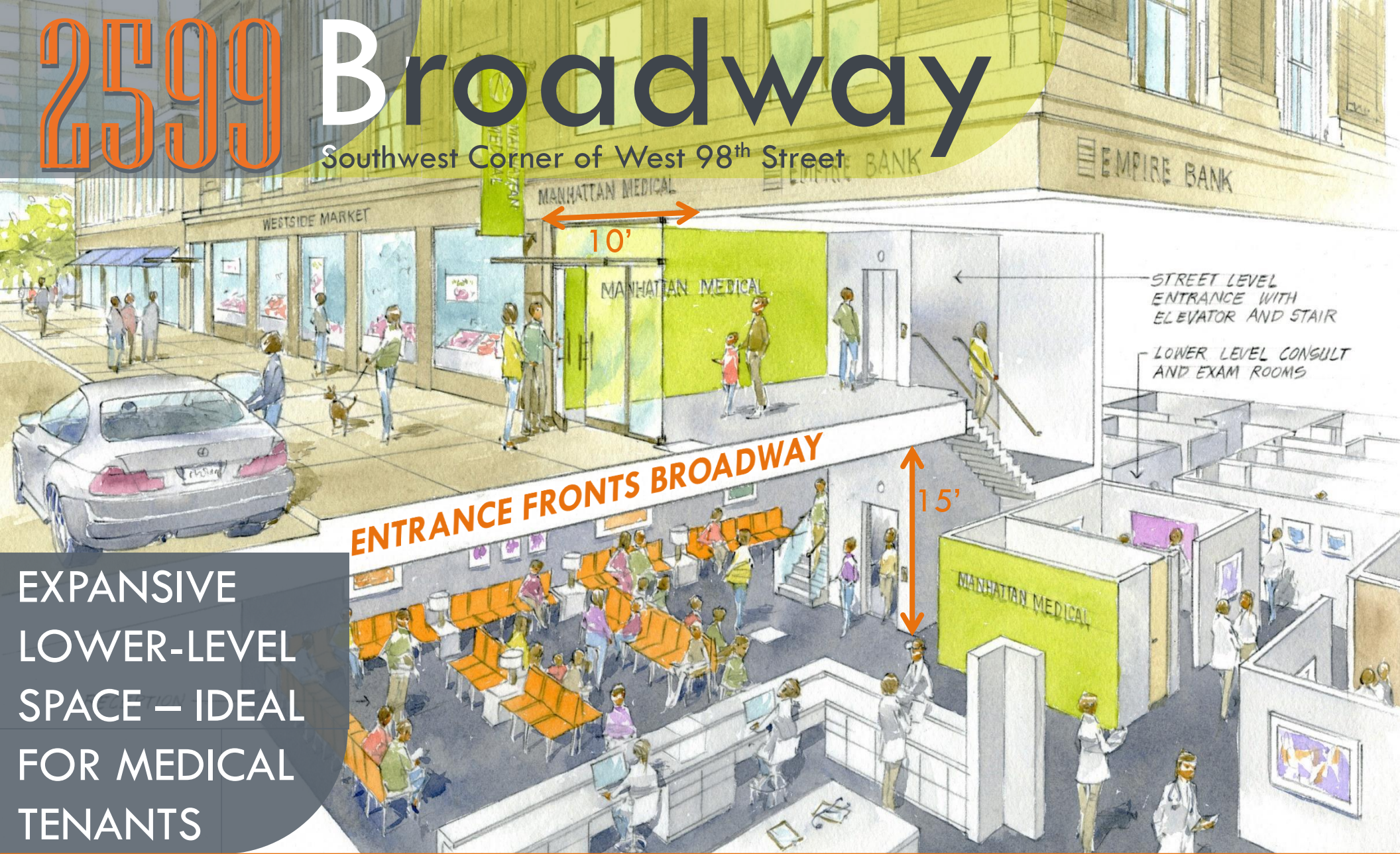

EXPANSIVE
LOWER-LEVEL
SPACE – IDEAL
FOR MEDICAL
TENANTS

2599

Broadway

Southwest Corner of West 98th Street

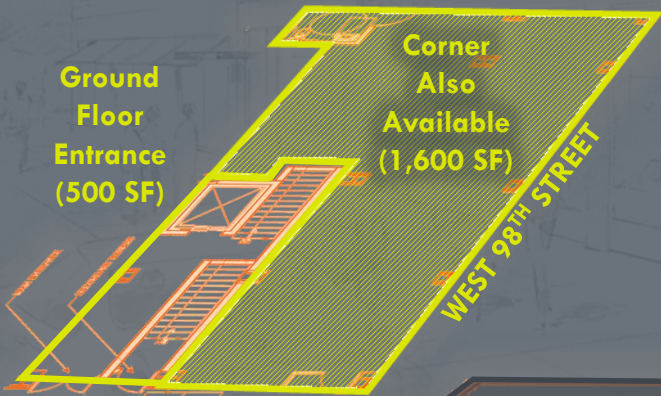

Floor Plans



BROADWAY

(Leased)



Area Map

STREET LEVEL ENTRANCE WITH ELEVATOR AND STAIR

LOWER LEVEL CONSULT AND EXAM ROOMS

2599

Broadway

Southwest Corner of West 98th Street

Approximate Size:

500 SF – Vestibule

3,000 SF – Lower Level

Frontage:

Approximately 10 Feet

Ceiling Height:

Approximately 15 Feet

Asking Rent:

Upon Request

Possession:

Arranged

Neighboring Tenants:

Westside Market, Paris Baguette, 16 Handles, Earth Café, Walgreens, Citibank, Chase Bank

Comments:

- Rare lower level space with high ceilings and wide column spacing
- Two blocks from the 1-2-3 line express subway stop at 96th Street
- Can be combined with 1,600 SF ground floor space on the corner

RECEPTION

For More Information, Please Contact Exclusive Agent:

Lucas Kooyman

212.372.2384

lkooyman@ngkf.com



www.ngkf.com

The information contained herein has been obtained from sources deemed reliable but has not been verified and no guarantee, warranty or representation, either express or implied, is made with respect to such information. Terms of sale or lease and availability are subject to change or withdrawal without notice.