



2301
JFK

MAJOR TENANT BRANDING SIGNAGE OPPORTUNITY



NEW TROPHY CONSTRUCTION

- Only a 75,000 SF lease needed to break ground on the building
- Breathtaking views of Schuylkill River, Art Museum, Boathouse Row and Center City
- Floor to ceiling glass with 9 foot ceilings
- Easy access in and out of the City
- Steps from 30th Street Station
- Typical floor plate – 18,500 SF

www.2301jfk.com

NEWMARK

2301
JFK

MAJOR TENANT BRANDING SIGNAGE OPPORTUNITY

30TH
STREET
STATION

JFK BOULEVARD

RIVER WALK

23RD STREET

NEW TROPHY CONSTRUCTION

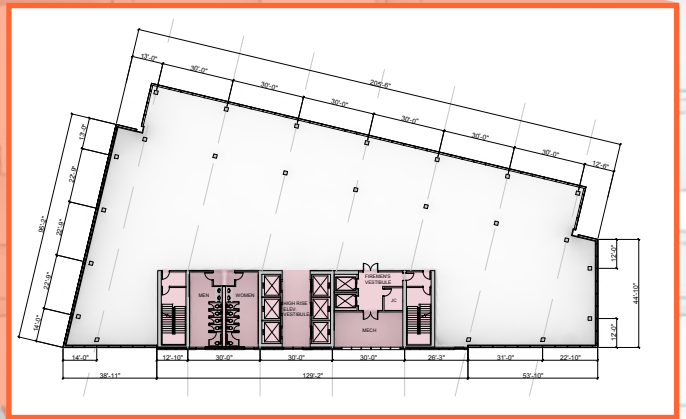

WALK SCORE

 **97**

Walker's Paradise

BIKE SCORE

 **84**

Very Bikeable

TRANSIT SCORE

 **100**

Rider's Paradise

- Next door to the brand new River Walk Apartments and marquee Giant Food
- Abundant parking next door

www.2301jfk.com

FOR MORE INFORMATION

Craig Scheuerle
Executive Managing Director
215-246-2752
cscheuerle@ngkf.com

Jack Soloff
Senior Managing Director
215-246-2764
jsoloff@ngkf.com

NEWMARK

One Commerce
2005 Market Street, Suite 900
Philadelphia, PA 19103
215-561-8300 | nmrk.com

The information contained herein has been obtained from sources deemed reliable but has not been verified and no guarantee, warranty or representation, either express or implied, is made with respect to such information. Terms of sale or lease and availability are subject to change or withdrawal without notice.