



15,216 SF High-Image Industrial Building Including 2,169 SF of Office

- Campus-like setting
- Storage mezzanine (not included in SF)
- Interior truck well with leveller (60' x 15')
- 18' ceiling height
- 1 - 12' x 14' power door
- 600A/240V electrical service
- 38 parking spaces
- High efficiency lighting

Asking Lease Rate \$6.50/SF NNN

Sale Possible

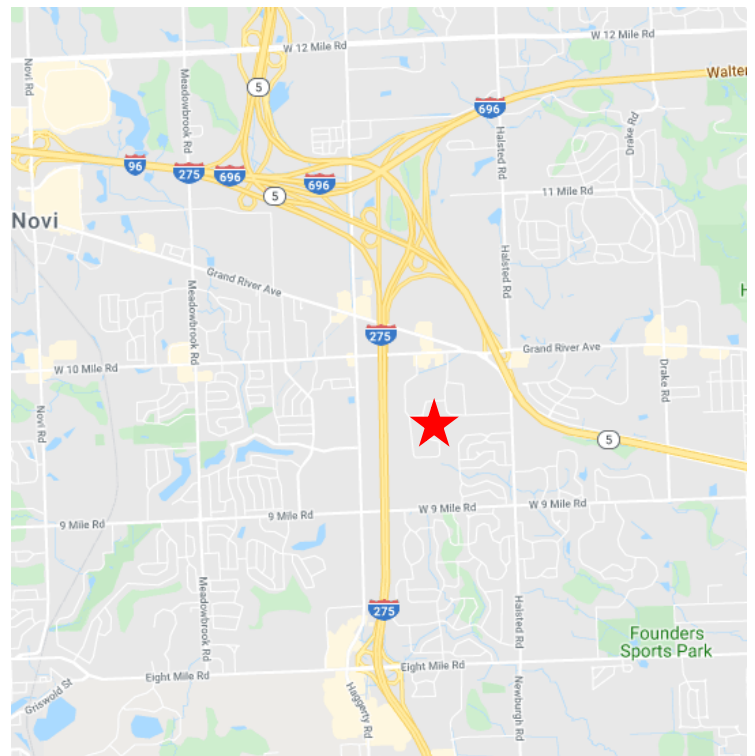

For more information, please contact:

Tony Avendt
Senior Director
+1 248 358 6115
tony.avendt@cushwake.com

Steve Kozak
Director
+1 248 358 6107
steve.kozak@cushwake.com

27777 Franklin Road, Suite 1050
Southfield, MI 48034
+1 248 358 6100
cushmanwakefield.com

**23035 Commerce Drive
Freeway Industrial Park
Farmington Hills, MI 48335**



Building Information

<i>Rentable Square Feet:</i>	15,216	<i>SubMarket:</i>	I-696/I-96 Corridor Submarket
<i>Office Square Feet:</i>	2,169	<i>Building Type:</i>	Warehouse/Distribution
<i>Number of Floors:</i>	1	<i>Sprinklers:</i>	Yes
<i>Year Built:</i>	1983	<i>Loading:</i>	Dock(1) Grade(1)
<i>Status:</i>	Built	<i>Power:</i>	600 Amps/240 Volts
<i>Acres:</i>	1.00	<i>Clear Height:</i>	18' 0"
<i>Operating Cost Estimate:</i>	\$1.59	<i>Column Spacing:</i>	35' x 40'
<i>Taxes:</i>	\$1.00	<i>Crane Served:</i>	N/A
<i>Insurance:</i>	\$0.20	<i>Rail Served:</i>	No
<i>CAM:</i>	\$0.39		
<i>Comment:</i>	Tenant contracts directly for snow/ice, and lawncare. Estimate reflects \$0.35/sf plus \$657 annual association fee.		

Space Information

<i>Largest Contiguous SF:</i>	15,216
<i>Direct Asking Rental Rate:</i>	\$6.50 Triple Net
<i>Leasing Agent Company:</i>	Cushman & Wakefield
<i>Leasing Agent Contact:</i>	Tony Avendt, Steve Kozak
<i>Leasing Agent Phone:</i>	(248) 358-6115
<i>Tenant Improvements:</i>	N/A

List of Availabilities - 23035 Commerce Drive

SF Avail/Off Avail	Divisible To	Asking Rental Rate/Type	Suite	Loading	Poss Date	Direct/Sublease/ Term/ Exp Date
15,216 / 2,169	No	\$6.50 Triple Net	N/A	Dock(1) Grade(2)		Yes

This report contains information available to the public and has been relied upon by Cushman & Wakefield on the basis that it is accurate and complete. Cushman & Wakefield accepts no responsibility if this should prove not to be the case. No warranty or representation, express or implied, is made to the accuracy or completeness of the information contained herein, and same is submitted subject to errors, omissions, change of price, rental or other conditions, withdrawal without notice, and to any special listing conditions imposed by our principals.

Prepared by Cushman & Wakefield

04/07/2020



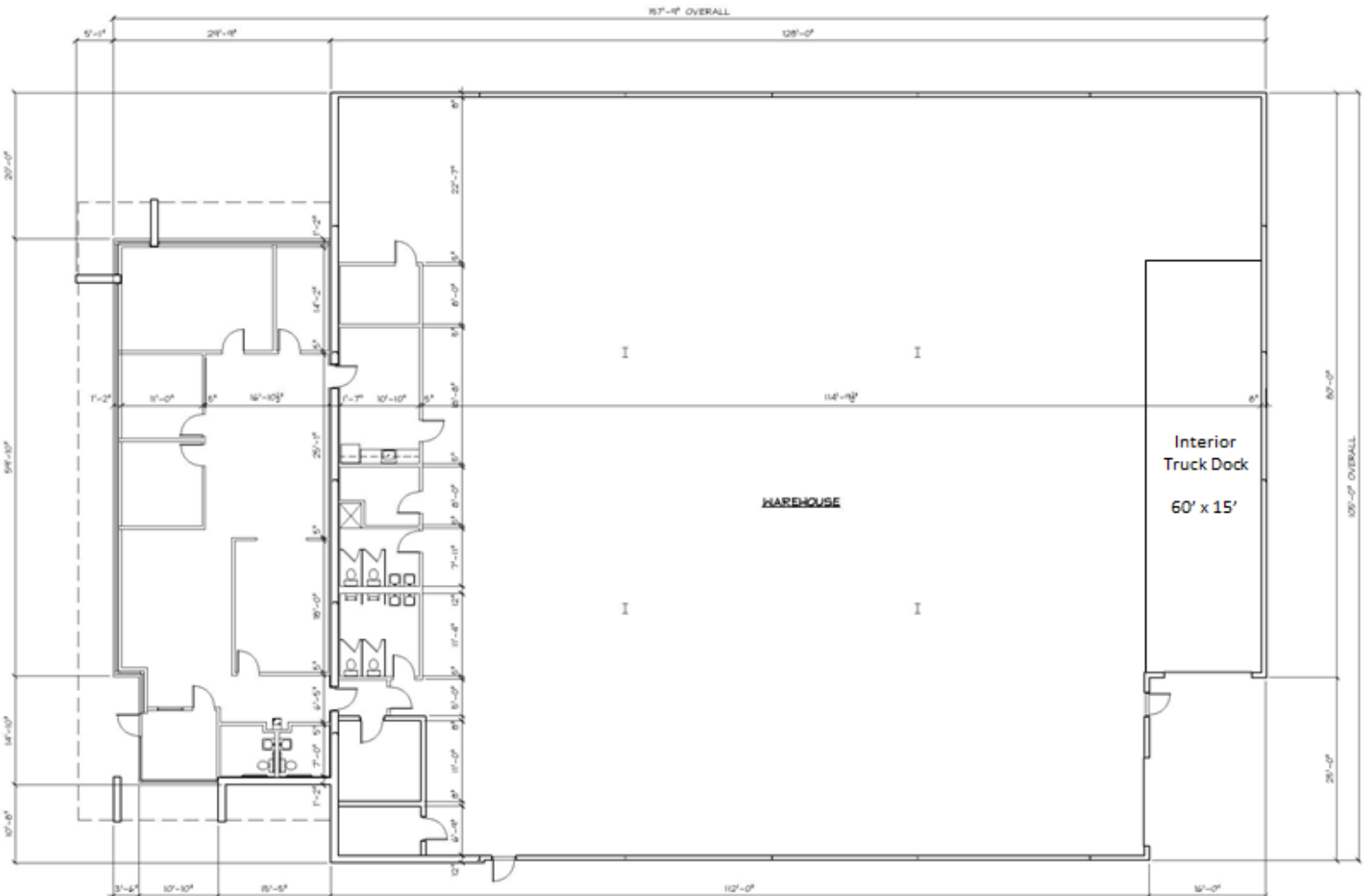

23035 COMMERCE RD.

OFFICE AREA	2,169 S.F.
WAREHOUSE AREA	13,047 S.F.
TOTAL	15,216 S.F.

FLOOR PLAN

SCALE: 1/8" = 1'-0"

0 4' 8' 12'

SCALE: 1/8" = 1'-0"



FOR SALE OR LEASE

23035 Commerce Drive

Farmington Hills, Michigan

