

FOR LEASE

# THE DISTRICT

6300 E HAMPDEN AVE, DENVER, CO 80222

## PROPERTY INFO

- + Approximately 2,372 SF available
- + Currently built out as a fast casual restaurant
- + Great southwest facing outdoor patio
- + Building and monument signage on Hampden with almost 60,000 VPD
- + Signalized access off Hampden Ave & Locust St
- + 85 dedicated retail surface parking spaces in addition to a parking garage
- + Shared access with King Soopers anchored center
- + Part of a 276 unit apartment project
- + Call for pricing and additional information



Available space fronts Hampden Ave with nearly 60,000 VPD.



Southwest facing outdoor patio.

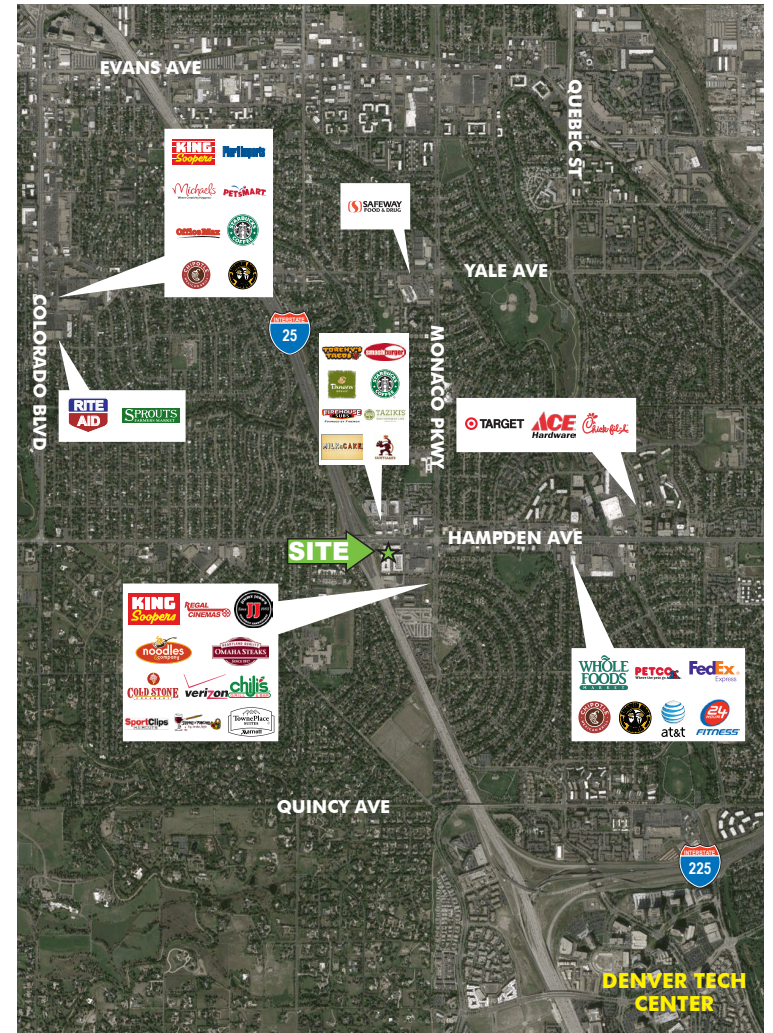

FOR LEASE

# THE DISTRICT

6300 E HAMPDEN AVE, DENVER, CO 80222

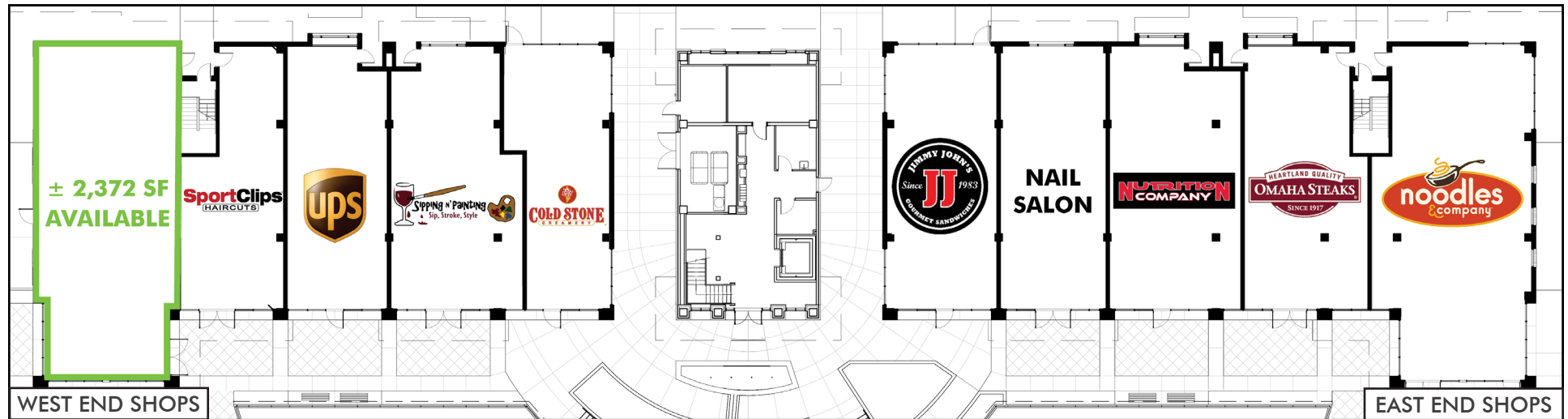

## Demographics (2020)

	1 mile	2 mile	3 mile
Population	14,811	64,340	131,758
Average HH Income	\$132,576	\$110,216	\$110,515
Employees	8,299	38,525	78,460
Daytime Population	16,159	74,965	152,944
Businesses	713	3,105	7,676

Source: ESRI 2020

## Traffic Counts

	Cars/Day
Hampden Ave	57,986 cars/day (DRCOG, 2018)
I-25	242,000 cars/day (CDOT, 2018)

## CONTACT US

### Michael Kendall

Vice President  
+1 303 264 1914  
michael.b.kendall@cbre.com

### Cameron Flint

Associate  
+1 303 264 1908  
cameron.flint@cbre.com

© 2020 CBRE, Inc. All rights reserved. This information has been obtained from sources believed reliable, but has not been verified for accuracy or completeness. You should conduct a careful, independent investigation of the property and verify all information. Any reliance on this information is solely at your own risk. CBRE and the CBRE logo are service marks of CBRE, Inc. All other marks displayed on this document are the property of their respective owners, and the use of such logos does not imply any affiliation with or endorsement of CBRE. Photos herein are the property of their respective owners. Use of these images without the express written consent of the owner is prohibited.

[www.cbre.us/colorado](http://www.cbre.us/colorado)

**CBRE**