

MULTI-USE INDUSTRIAL BUILDING FOR SALE

±4,456 SF

\$1,495,000 (\$336/SF)

2835 SEBASTOPOL ROAD
SANTA ROSA | CALIFORNIA



2835 SEBASTOPOL ROAD

SANTA ROSA | CALIFORNIA

office highlights

1st floor ±900 sf

- Heat and air conditioning
- Waiting room
- Two private offices

2nd floor mezzanine ±816 sf

- Large open meeting room or back office

warehouse highlights

±2,100 sf

- 16.5 ft - 17.5 ft. clear height
- Six grade-level roll-up bay doors; including two drive through doors
- Two gas heaters
- Six skylights
- Restrooms
- Storage area

Back building ±640 sf metal warehouse

- Two grade level roll-up doors

- APN 035- 251 047

- Lot size: For ±26,571 sf

- Parking: Front of building 40 cars

Back of building 17 cars

- Built in 1995

- Steel Structured Varco-Pruden Building with metal siding

- Roof: Metal

- Zoned : IL Light industrial with use permit for used car sales, and allowed use with permits for cannabis manufacturing, distribution dispensary and cultivation

- Fenced yard on three sides (fences do not represent property lines)



photogallery



2835 SEBASTOPOL ROAD
SANTA ROSA | CALIFORNIA



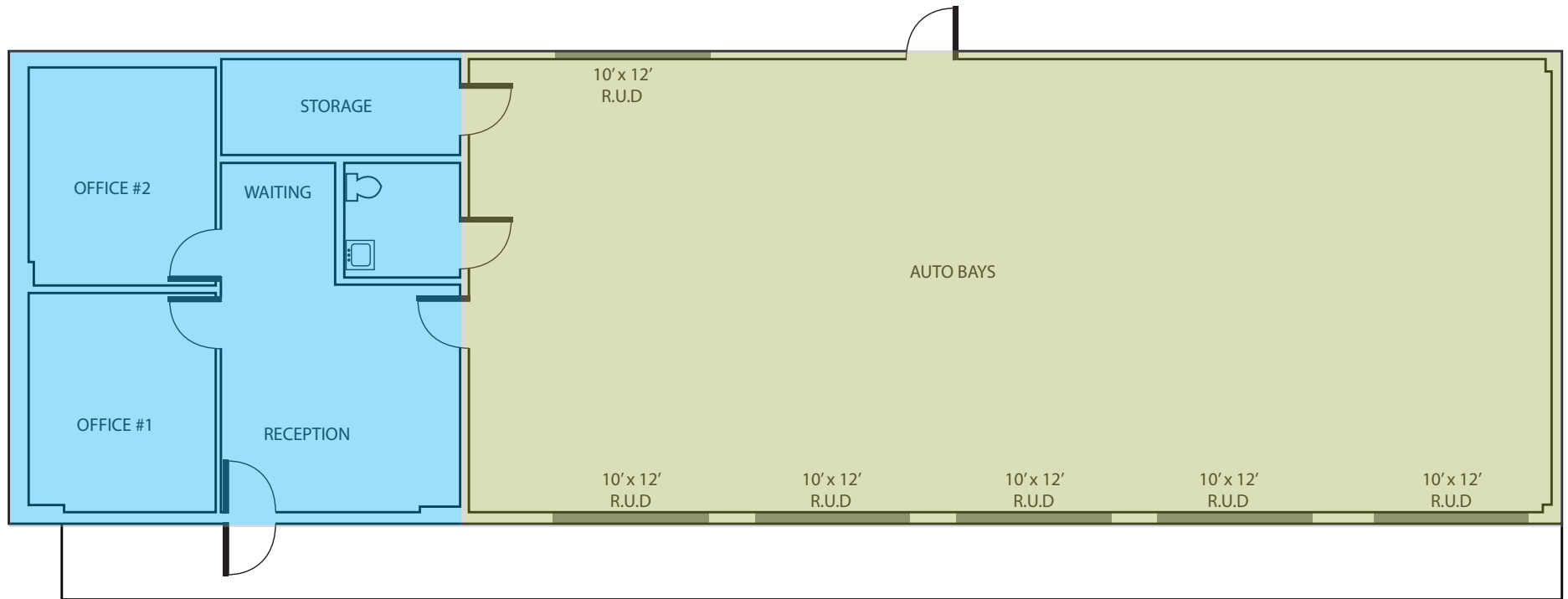

2835 SEBASTOPOL ROAD SANTA ROSA | CALIFORNIA



2835 Sebastopol Rd.
Santa Rosa



MULTI-USE INDUSTRIAL BUILDING FOR SALE

2835 SEBASTOPOL ROAD
SANTA ROSA | CALIFORNIA



BARRY PALMA, CCIM
bpalma@ngkf.com
CA RE LIC #00901364

111 Santa Rosa Avenue, Suite 110
Santa Rosa, CA 95404
707.583.8400

ngkf.com

The distributor of this communication is performing acts for which a real estate license is required. The information contained herein has been obtained from sources deemed reliable but has not been verified and no guarantee, warranty or representation, either express or implied, is made with respect to such information. Terms of sale or lease and availability are subject to change or withdrawal without notice. 10/2020