



# BELTWAY SOUTHWEST BUSINESS PARK – BLDG 4

14453 HILLCROFT ST.  
HOUSTON, TX 77085

SHELL COMPLETE



112,500 SF – REAR LOAD DISTRIBUTION SPACE

## Property Highlights

- Located in a 75-acre, master-planned, deed-restricted, corporate park in the Southwest Houston Submarket, with frontage on Fort Bend Tollway and Beltway 8
- ±56,250 SF available
- Can be subdivided to 18,000 SF
- Dock-high, rear-load configuration
- 19 overhead doors with 1 ramp
- 28' Clear height
- ESFR sprinkler systems
- 260' shared truck court
- Ample parking (253 parking spaces) – 2.25/1,000 SF ratio
- Secured truck court
- Tiltwall concrete construction

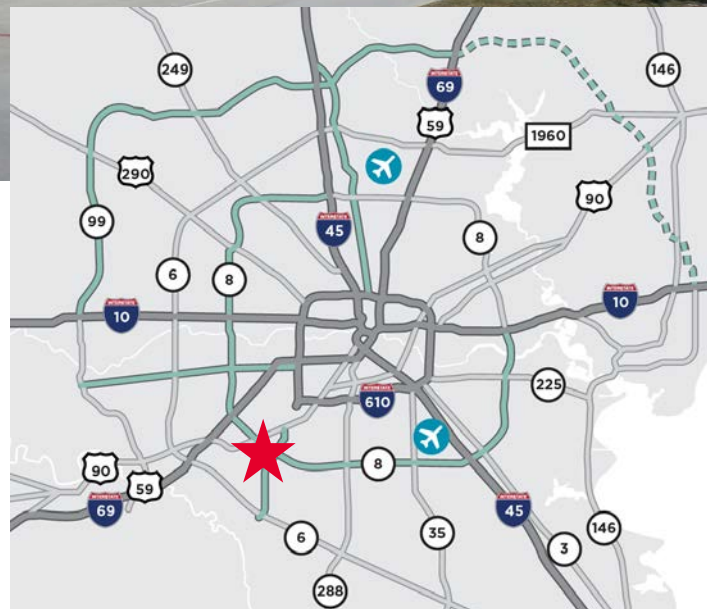

**Beau Kaleel, SIOR**  
713.963.2844  
[beau.kaleel@cushwake.com](mailto:beau.kaleel@cushwake.com)

**Brooke Forrest**  
713.331.1735  
[brooke.forrest1@cushwake.com](mailto:brooke.forrest1@cushwake.com)

CUSHMAN & WAKEFIELD  
1330 Post Oak Blvd, Suite 2700  
Houston, TX 77056  
phone: +1 713 877 1700



# BELTWAY SOUTHWEST BUSINESS PARK – BLDG 4

14453 HILLCROFT ST.  
HOUSTON, TX 77085

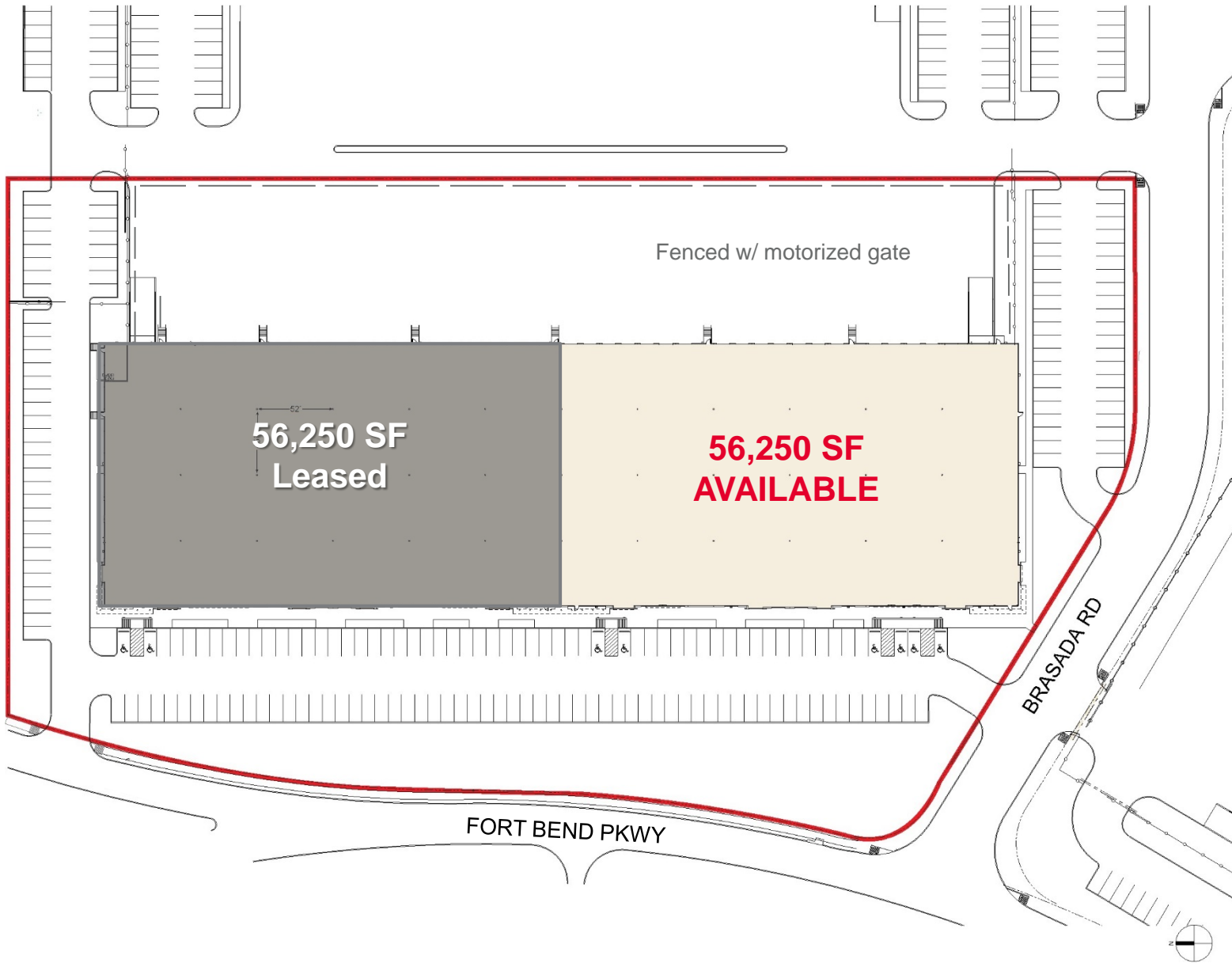

**Beau Kaleel, SIOR**  
713.963.2844  
[beau.kaleel@cushwake.com](mailto:beau.kaleel@cushwake.com)

**Brooke Forrest**  
713.331.1735  
[brooke.forrest1@cushwake.com](mailto:brooke.forrest1@cushwake.com)

**CUSHMAN & WAKEFIELD**  
1330 Post Oak Boulevard | Suite 2700  
Houston, TX 77056  
[www.cushmanwakefield.com](http://www.cushmanwakefield.com)

# BELTWAY SOUTHWEST BUSINESS PARK – BLDG 4

14453 HILLCROFT ST.  
HOUSTON, TX 77085

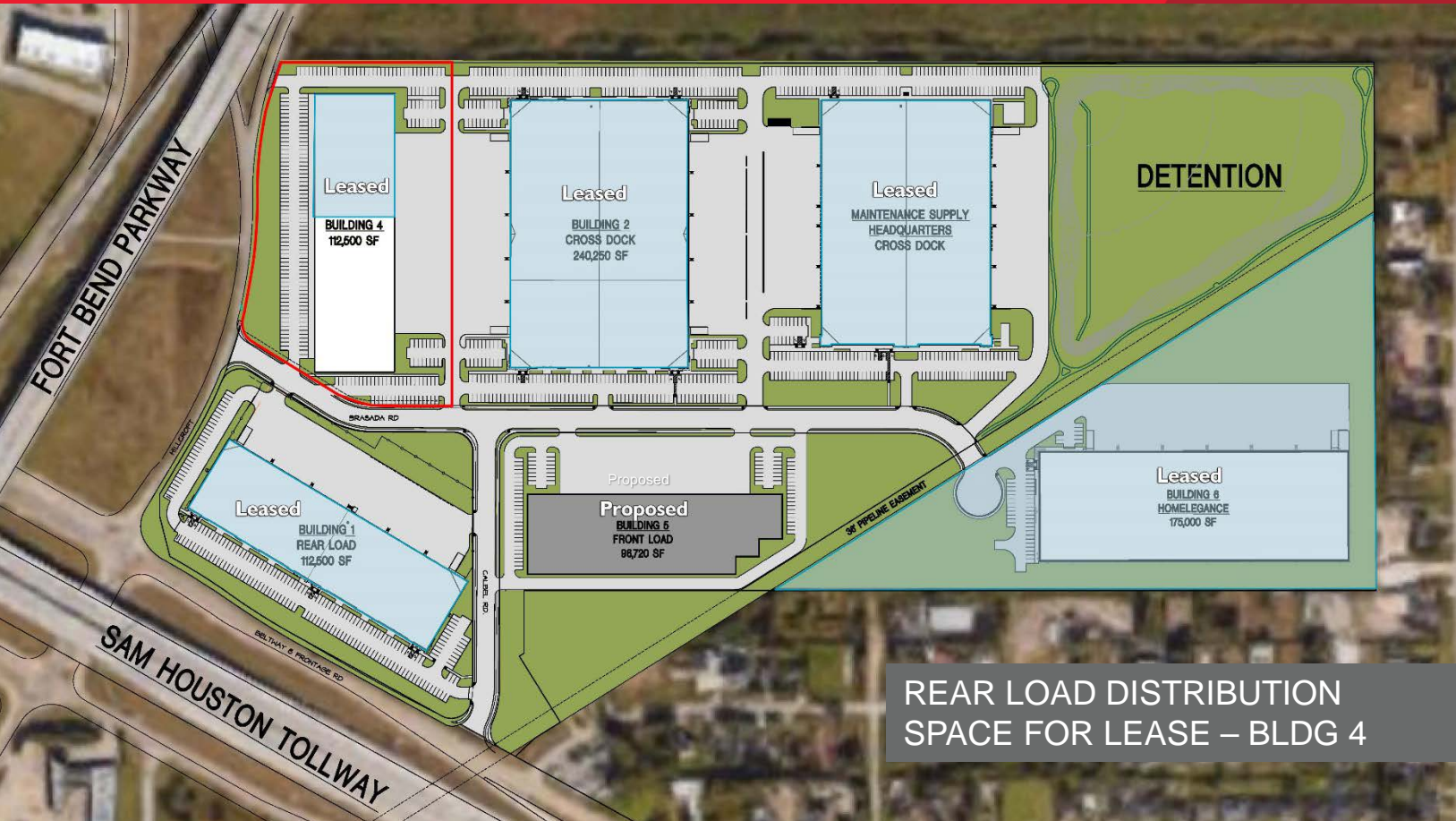

**REAR LOAD DISTRIBUTION  
SPACE FOR LEASE – BLDG 4**

## PROXIMITY TO SELECT LOCATIONS IN REGION

DESTINATION	DISTANCE	DRIVE TIME
CBD	17 miles	21 minutes
Texas Medical Center	10 miles	15 minutes
Galleria/Uptown	11 miles	15 minutes
Port of Houston	18 miles	20 minutes
Katy	23 miles	24 minutes
Sugar Land	11 miles	12 minutes
I-45	15 miles	17 minutes
US-59	5 miles	6 minutes

**Beau Kaleel, SIOR**  
713.963.2844  
[beau.kaleel@cushwake.com](mailto:beau.kaleel@cushwake.com)

**Brooke Forrest**  
713.331.1735  
[brooke.forrest1@cushwake.com](mailto:brooke.forrest1@cushwake.com)

**CUSHMAN & WAKEFIELD**  
1330 Post Oak Boulevard | Suite 2700  
Houston, TX 77056  
[www.cushmanwakefield.com](http://www.cushmanwakefield.com)



**BEAU KALEEL, SIOR**  
 (713) 963 2844  
 beau.kaleel@cushwake.com

**Brooke Forrest**  
 713.331.1735  
 brooke.forrest1@cushwake.com



**CUSHMAN & WAKEFIELD**  
 1330 Post Oak Boulevard | Suite 2700  
 Houston, TX 77056  
 www.cushmanwakefield.com

Cushman & Wakefield copyright 2015. No warranty or representation, express or implied, is made to the accuracy or completeness of the information contained herein, and same is submitted subject to errors, omissions, change of price, rental or other conditions, withdrawal without notice, and to any special listing conditions imposed by the property owner(s). As applicable, we make no representation as to the condition of the property (or properties) in question.