

Glen Harbor Business Park



Availability

Suite

- Suite 2
- Suite 9

Square Feet

- ±2,756 sf
- ±4,023 sf

Building

- ±26,475 sf
- Built: 1999

Parking

- 3.5:1,000 sf
- Covered available for each suite: \$30/mo./stall

Rate & Term

- Suite 2: \$0.99/sf, MG
- Suite 9: \$0.91/sf, MG
- TI's: negotiable

Zoning

- M-1, City of Glendale

Features

- Part of an 8-unit, multi-tenant industrial building
- 0.5 miles to Loop-101, Westgate Entertainment District, and the State Farm Stadium
- 12 ft x 14 ft grade-level loading doors
- Clear height: 16 ft
- Power: 400-2,000 Amps, 120/208 volt, 3-phase

Kevin Helland

D 480 423 7942
C 623 293 1543
kevin.helland@avisonyoung.com

2720 E Camelback Road
Suite 150
Phoenix, AZ 85016
avisonyoung.com

Suite 2: ±2,756 sf

Includes paint booth, one large office, and a restroom.

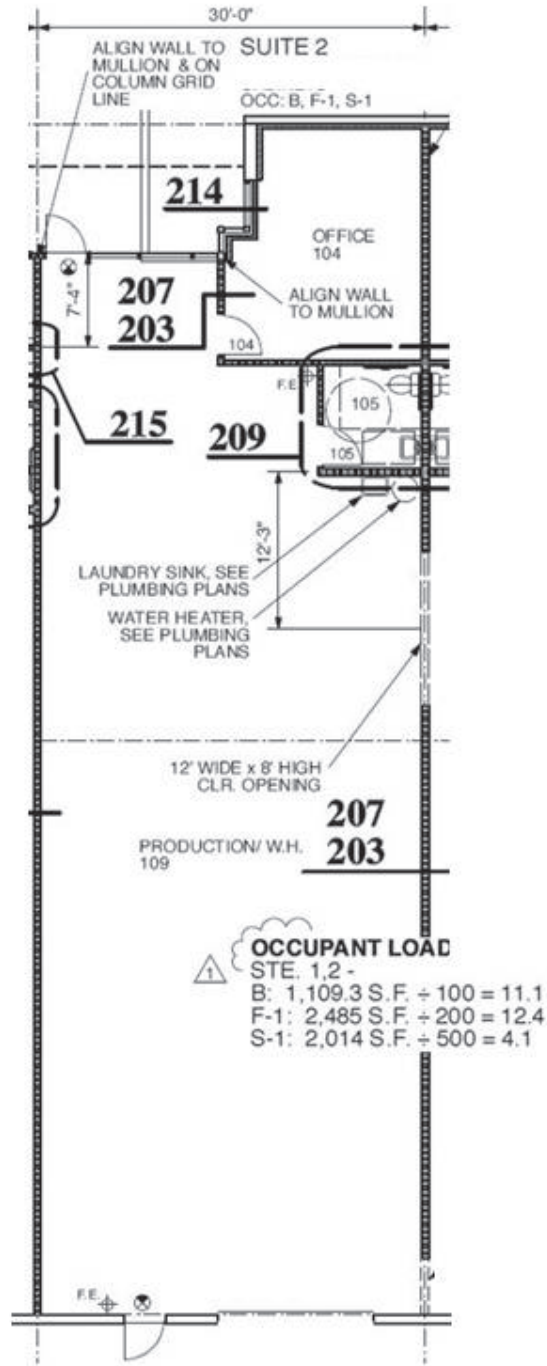

Suite 9: ±4,023 sf

