

## Pro Sales Building

4230 "B" Street NW  
Auburn, WA

### Stand Alone Building

10,796 SF total (0.75 acres)

8,920 SF footprint divisible to  
4,460 SF bays

3,007 SF office (2 story)

1,882 SF 1st floor

1,126 SF 2nd floor

750 SF mezzanine storage

M1 zoning

4 DH and 2 GL doors overall  
±22' ceiling height

Small fenced yard (1,408 SF)

Building is divisible

400 amp 208 volt electrical

\$0.44 shell, NNN

\$0.75 office, NNN

Available now



### Contacts

**Tony Miltenberger**  
206.248.7307  
tonym@kiddermathews.com

## Pro Sales Building

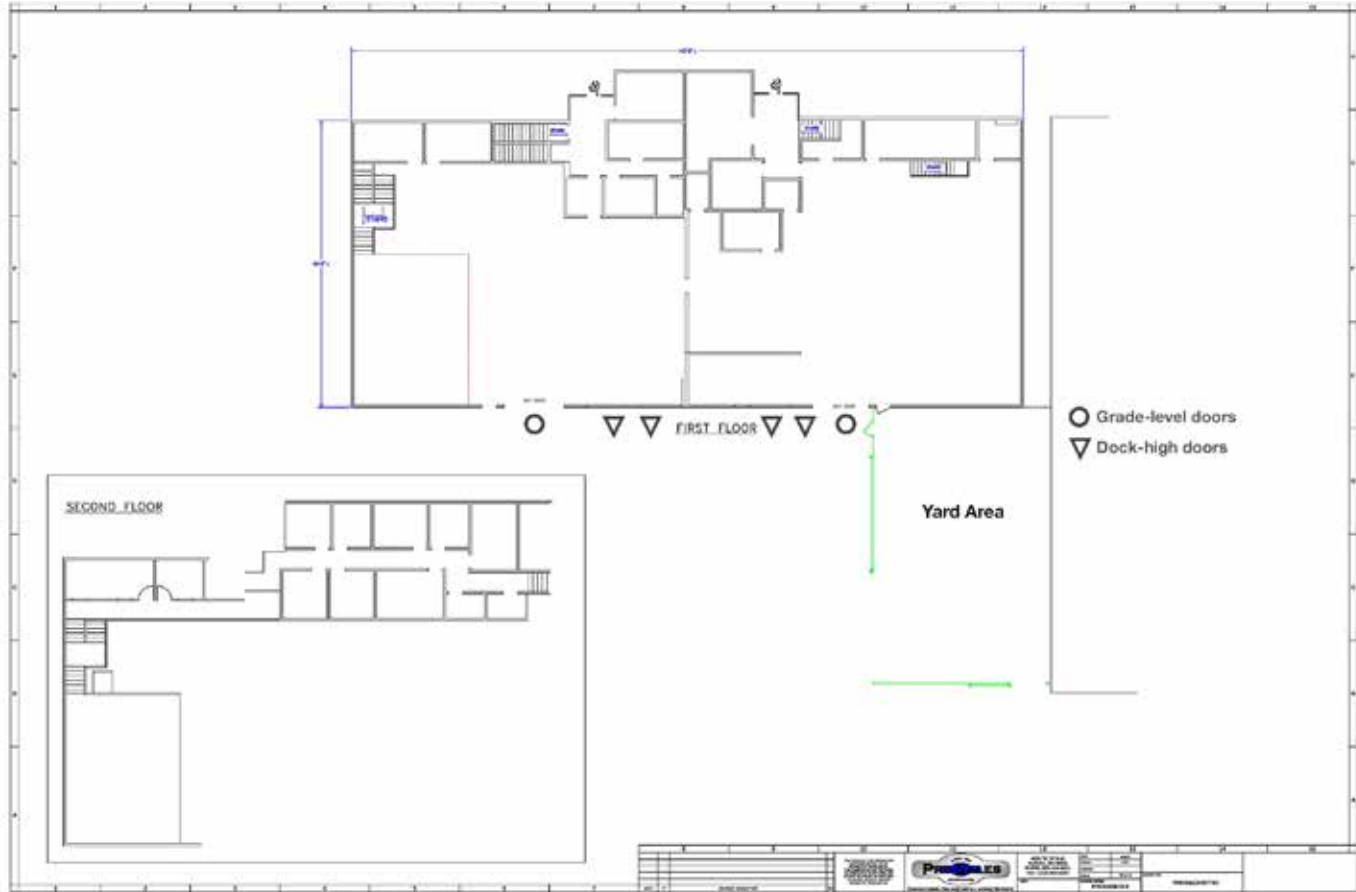

**SOUTH VIEW**



**NORTH VIEW**



**WEST VIEW**



**EAST VIEW**



### Contact

**Tony Miltenberger**  
206.248.7307  
tonym@kiddermathews.com