



SIGNATURE ASSOCIATES
KNOW SIGNATURE | KNOW RESULTS

Office For Sale or Lease

Property Name:
Location: 14950 E. Jefferson Ave
City, State: Grosse Pointe Park, MI
Cross Streets: Fisher St.
County: Wayne

BUILDING SIZE / AVAILABILITY

Total Building Sq. Ft.: 7,720	Total Available Sq. Ft.: 7,720	Class:
Typical Floor Plate: 3,860	Min / Max Cont. Sq. Ft.: 250 / 7,720	No. of Floors: 2

PROPERTY INFORMATION

Zoning: OS	Parking: 15 - Front & Rear
Exterior Construction: Block/Brick	Power: 110/220 Volts
Structural System: Steel	Security Systems: Yes
Roof: Gable	Restrooms: M & W
Floors / Covering: Tile / Carpet	Sprinklers: No
Heating: Gas	Signage: Yes
Air-Conditioning: Yes	Delivery Area: Yes
Ceiling Height: 10'	Date Available: TBD
Year Built: 1997	Acreage: 0.303

Current Tenants:

PRICING INFORMATION

Lease Rate: See Comments	Rentable/Usable: N/A	Lease Term: N/A
Sale Price: \$695,000	Total Taxes: \$21,890 (2018)	Impr Allowance: N/A
Options: N/A	Parcel #: 39-009-02-0182-000	Deposit: N/A

Tenant Responsibility:

Comments: Multi-tenant office building. Across the street from the Schaap/Manoogian Center for Performing Arts (under construction). Elevator serving 1st and 2nd floors and full basement. Professional appearance. Basement storage. 15 on-site parking space. Lease individual offices or a suite. Range is \$950 - \$1,200/Month.

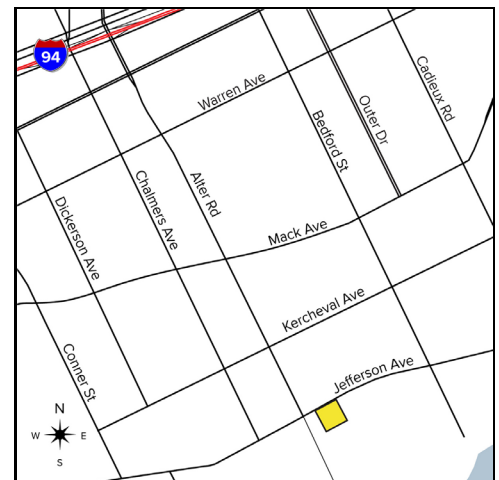

Broker: SIGNATURE ASSOCIATES

Agent(s):

Chris Monsour, (248) 948-0107, cmonsour@signatureassociates.com
Dave Miller, (248) 948-4183, dmiller@signatureassociates.com