

W. SILVERBELL ROAD ORION TWP., MICHIGAN

LAND FOR SALE
16.45 Acres Available



**SIGNATURE
ASSOCIATES**
KNOW SIGNATURE | KNOW RESULTS

DEVELOPMENT LAND



PROPERTY FEATURES

- 16.45 acres available
- Outstanding location with main road visibility on both Lapeer Road and Silverbell Road
- Adjacent to Milosch Chrysler Dodge Jeep & Ram, detention basin on site
- Zoned Commercial Business, Industrial; very flexible
- Lake Orion schools
- Land flat and balanced; utilities on site
- Sale Price: \$3,290,000 (\$199,963.53/acre)



For more information, please contact:

STEVE GORDON
(248) 948 0101
sgordon@signatureassociates.com

JOE BANYAI
(248) 948 0108
jbanyai@signatureassociates.com

SIGNATURE ASSOCIATES
One Towne Square, Suite 1200
Southfield, MI 48076
www.signatureassociates.com

W. Silverbell Road – Orion Twp., Michigan

Land For Sale

16.45
Acres
AVAILABLE

Site Plan

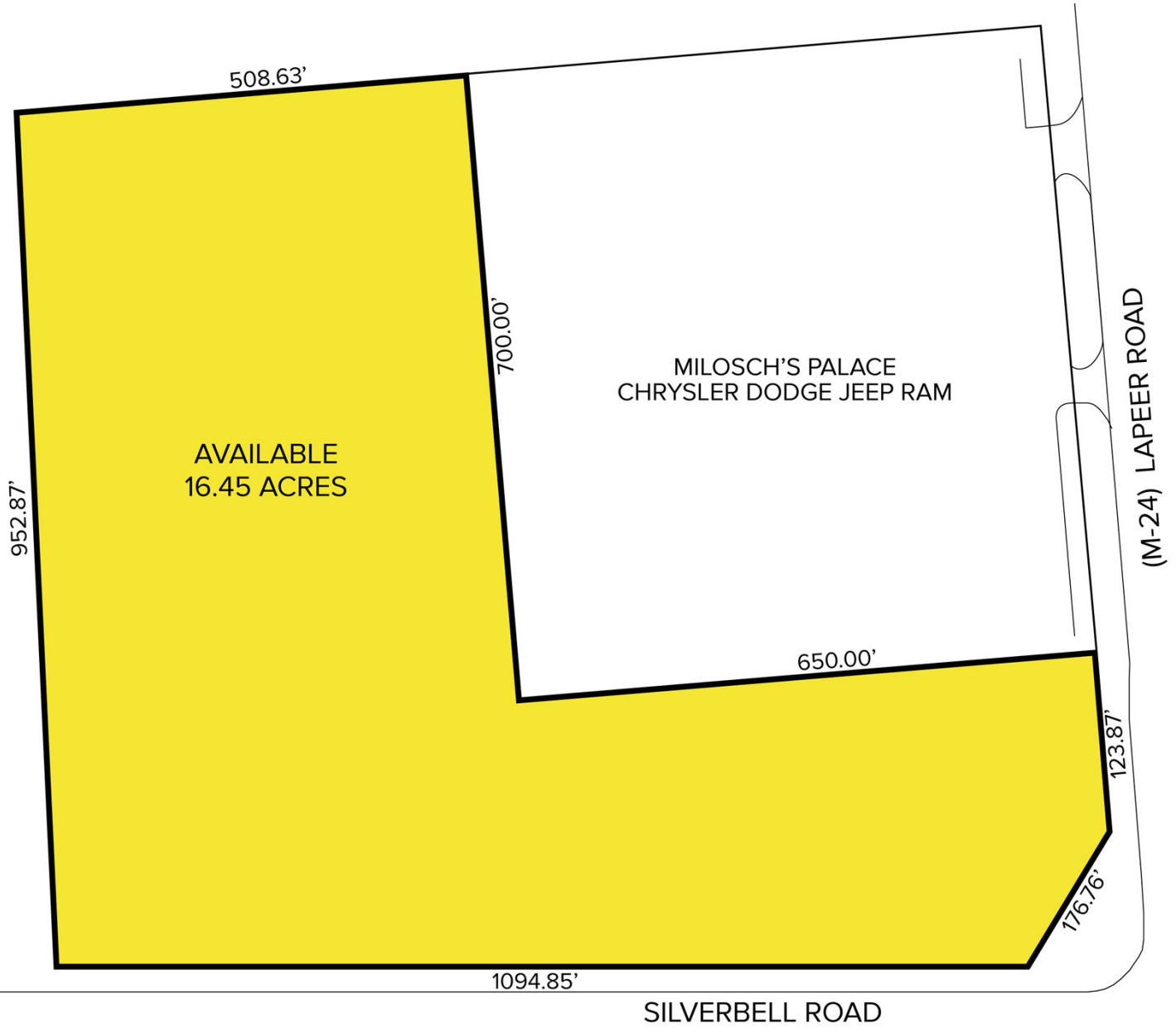

For more information, please contact:

STEVE GORDON

(248) 948 0101

sgordon@signatureassociates.com

JOE BANYAI

(248) 948 0108

jbanyai@signatureassociates.com

SIGNATURE ASSOCIATES

One Towne Square, Suite 1200

Southfield, MI 48076

www.signatureassociates.com