

Northwest Corporate Park, Bldg B

6007 6th Avenue South, Seattle, WA 98108



Owned by:

Exclusively marketed by:



John Vernon
+1 425 586 5638
jvernon@nai-psp.com

Tamir Ohayon
+1 425 586 5627
tohayon@nai-psp.com

Bob Swain, CCIM
+1 425 586 5622
bswain@nai-psp.com

6007 6th Avenue South Seattle, WA

Northwest Corporate Park, Bldg B

NAI Puget Sound Properties is pleased to present an opportunity to lease a prime commercial industrial space in Georgetown.

- **8,100 SF warehouse**
- **22' clear height**
- **25' side bay dimension (25' x 60' column spacing)**
- **Strategic design district location**
- **6 dock high positions (3 double doors)**
- **Superior freeway access & proximity to Seattle CBD**
- **Rates:**
 - \$1.20 shell
 - Potential BTS Office
- **Exterior Improvement recently completed:**
 - Energy efficient storefronts
 - New dock bumpers & dock doors with viewing windows
 - New canopies over all docks
 - New building signage identifiers, and updated landscaping

62
Walk Score

IG2-85
Zoning

Property Overview

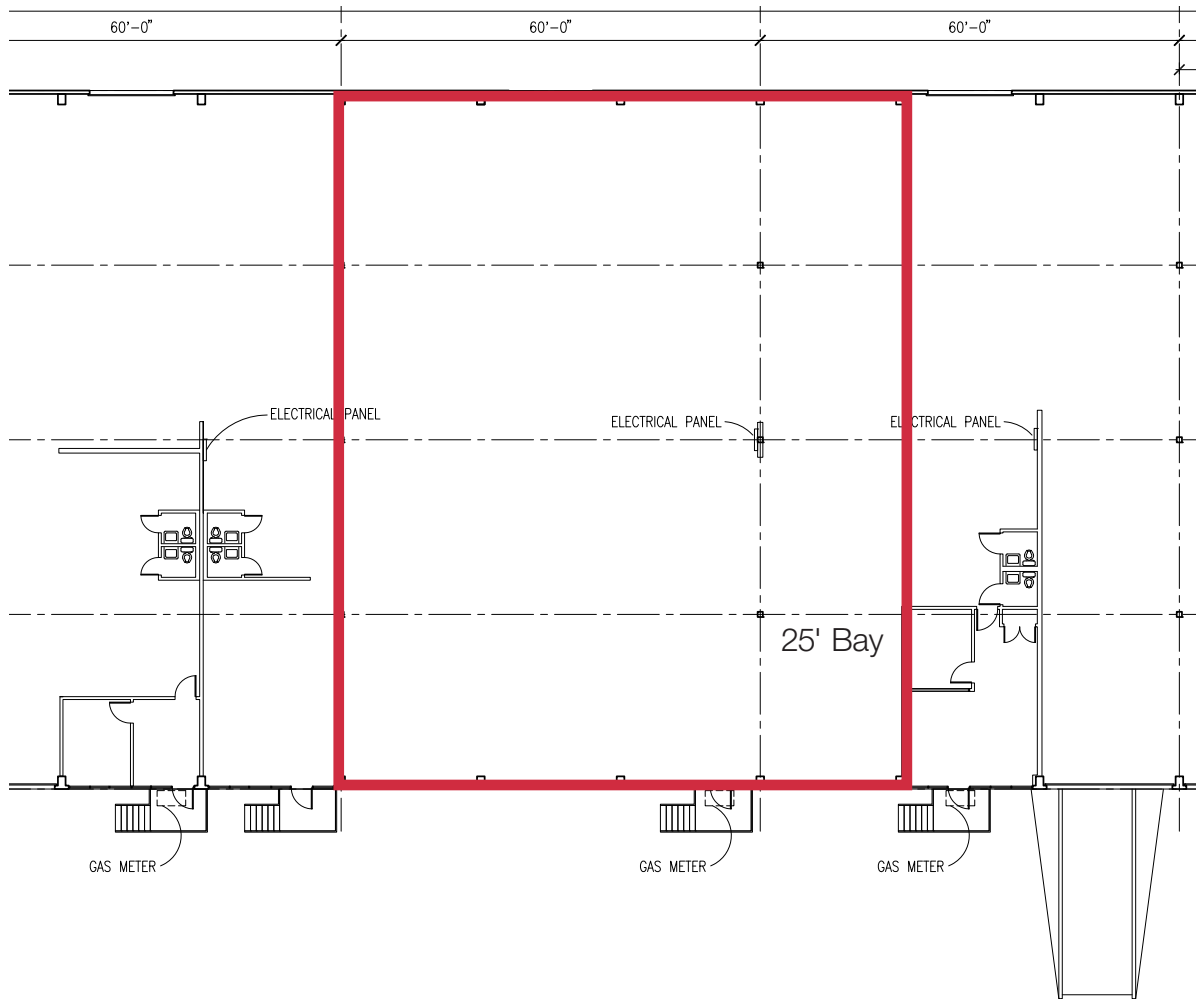

GEORGETOWN

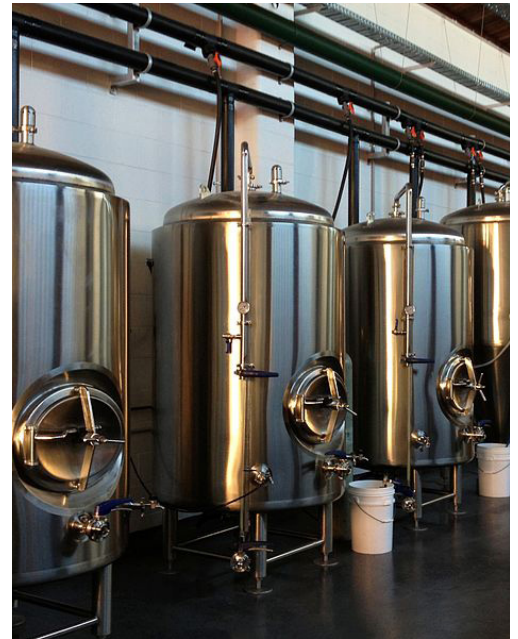

Located within the industrial market, Georgetown is one of Seattle's oldest neighborhoods. Don't let the label fool you, the neighborhood has a sizable number of office and retail establishments in addition to manufacturing-oriented businesses. Food connoisseurs can enjoy an array of dining options in addition to an assortment of breweries in the area.

Due to its convenient location near the Port of Seattle and the urban core, Georgetown has seen robust growth and leasing activity with low vacancy rates. The area is centrally located with easy access to I-5, Boeing Field, Hwy 99 and minutes from downtown Seattle.

Location Overview

Superior freeway

access to I-5 and

East Marginal Way

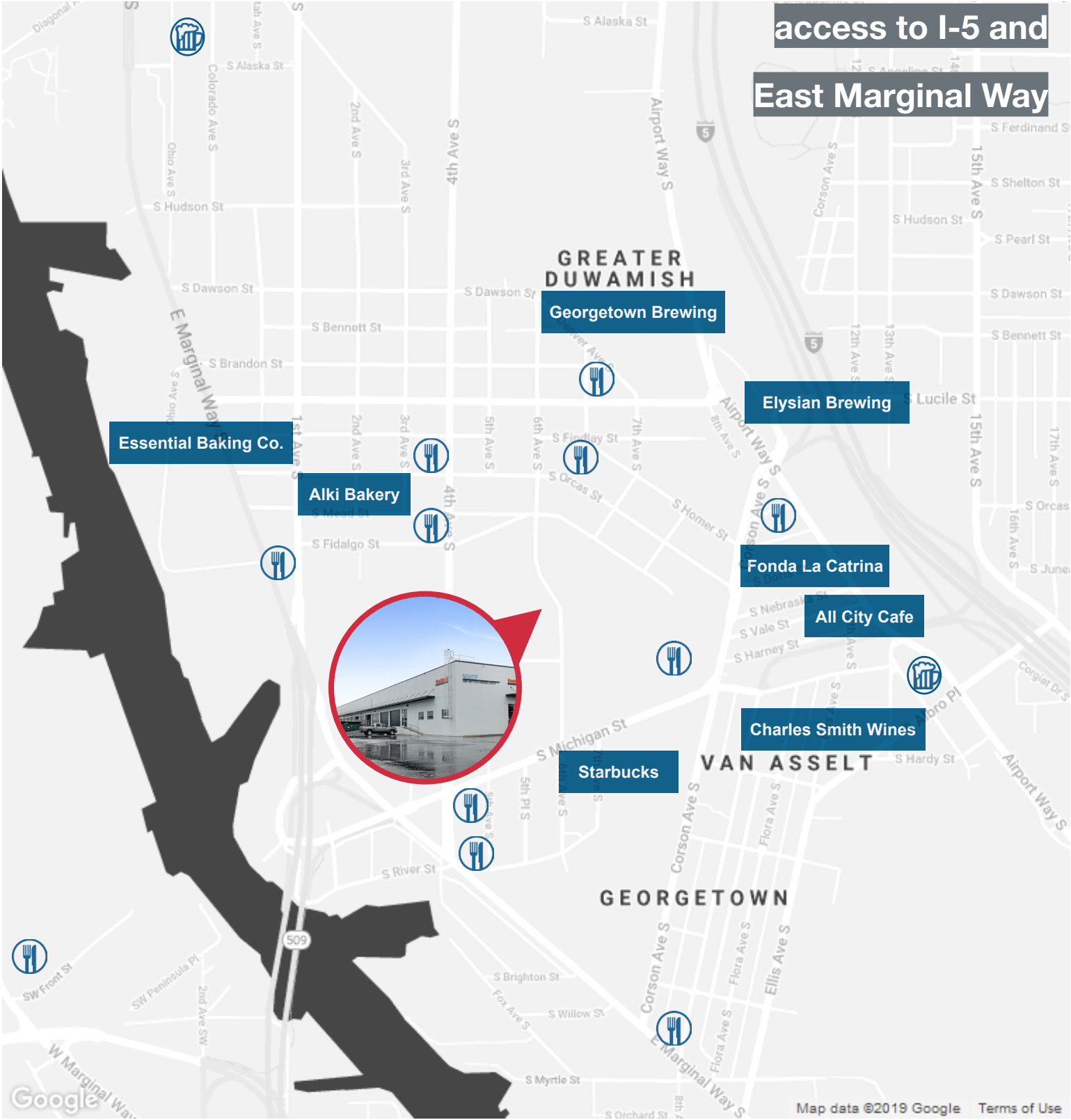

Exclusively marketed by:

John Vernon

+1 425 586 5638
jvernon@nai-psp.com

Tamir Ohayon

+1 425 586 5627
tohayon@nai-psp.com

Bob Swain, CCIM

+1 425 586 5622
bswain@nai-psp.com

NAI Puget Sound
Properties

PrincipalSM