

Available For Lease  
**4,200 SF**  
**Office/Warehouse**

**NAI Heartland**



**6457 Universal Ave**

Kansas City, Missouri

For more information:

**Joe O'Neill**

+1 913 890 2010

joe@nai-heartland.com

**Nathan Anderson, SIOR, CCIM**

+1 913 890 2001

nathan@nai-heartland.com

### Property Features

- 4,200 SF Office/Warehouse for lease
- ±750 SF Office
- Dock-high and drive-in loading
- New roof and parking lot
- Wet sprinkler system
- Adjacent to New QuikTrip Travel Center
- Available Immediately
- \$6.75 PSF Gross  
(\$2,362.50 per month) plus CAM

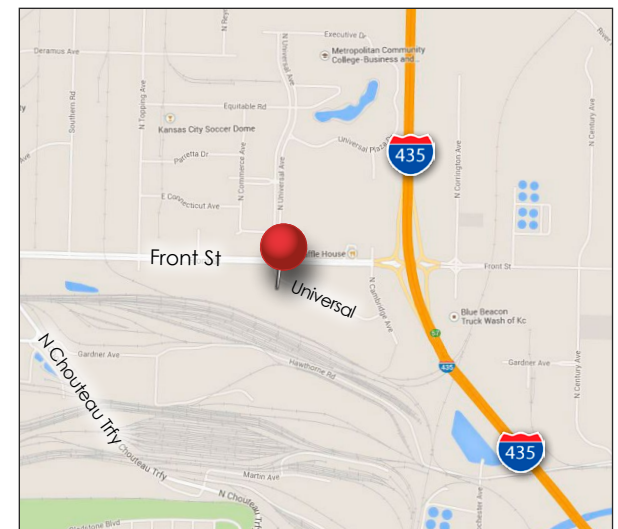

4400 College Boulevard Suite 170  
Overland Park, Kansas 66211  
913 362 1000

[nai-heartland.com](http://nai-heartland.com)

NO WARRANTY OR REPRESENTATION, EXPRESS OR IMPLIED, IS MADE AS TO THE ACCURACY OF THE INFORMATION CONTAINED HEREIN, AND THE SAME IS SUBMITTED SUBJECT TO ERRORS, OMISSIONS, CHANGE OF PRICE, RENTAL OR OTHER CONDITIONS, PRIOR SALE, LEASE OR FINANCING, OR WITHDRAWAL WITHOUT NOTICE, AND OF ANY SPECIAL LISTING CONDITIONS IMPOSED BY OUR PRINCIPALS NO WARRANTIES OR REPRESENTATIONS ARE MADE AS TO THE CONDITION OF THE PROPERTY OR ANY HAZARDS CONTAINED THEREIN ARE ANY TO BE IMPLIED.

Available For Lease

**6457 Universal Ave**

Kansas City, Missouri

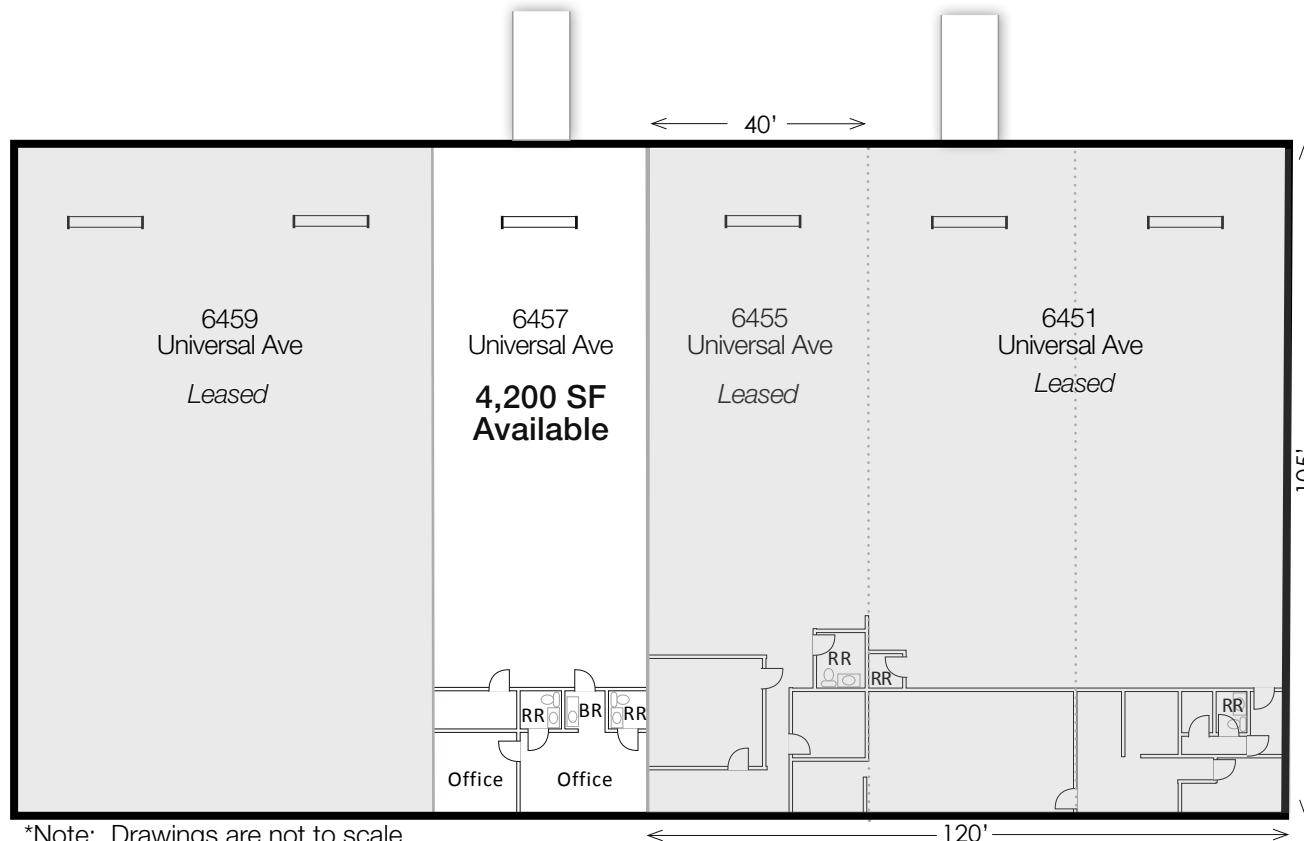

\*Note: Drawings are not to scale

Front of Building / Parking Lot

Available Space	6457 Universal
Total SF	4,200 SF
Lease Rate per SF/Year	\$6.75/SF plus CAM
Lease Rate per Month	\$2,362.50 plus CAM



4400 College Boulevard Suite 170  
Overland Park, Kansas 66211  
913 362 1000  
[nai-heartland.com](http://nai-heartland.com)

For more information:

**Joe O'Neill**  
+1 913 890 2010  
[joe@nai-heartland.com](mailto:joe@nai-heartland.com)

**Nathan Anderson, SIOR, CCIM**  
+1 913 890 2001  
[nathan@nai-heartland.com](mailto:nathan@nai-heartland.com)



Available For Lease

6457 Universal Ave

Kansas City, Missouri



4400 College Boulevard Suite 170  
Overland Park, Kansas 66211  
913 362 1000  
[nai-heartland.com](http://nai-heartland.com)

For more information:

Joe O'Neill  
+1 913 890 2010  
[joe@nai-heartland.com](mailto:joe@nai-heartland.com)

Nathan Anderson, SIOR, CCIM  
+1 913 890 2001  
[nathan@nai-heartland.com](mailto:nathan@nai-heartland.com)