



6012 Zebulon Road
Macon, Bibb County, Georgia 31210

LEASE



RESTAURANT SPACE
2,167± SQ FT

CONTACT AGENT FOR LEASE RATE

CBCMACON.COM

STEPHANIE FOLSOM CCIM
478.746.8171 Office • 478.361.8259 Cell
stephanie@cbcworldwide.com

 **COLDWELL
BANKER
COMMERCIAL**
EBERHARDT & BARRY
CBCWORLDWIDE.COM

COLDWELL BANKER COMMERCIAL EBERHARDT & BARRY 990 Riverside Drive Macon, GA 31201 (478) 746-8171

Revised 9/21/21



PROPERTY OVERVIEW

6012 Zebulon Road
Macon, Bibb County, Georgia 31210

- Subject property located one block from I-475 / Zebulon Road, Exit 9.
- **2,167± SF Restaurant Space**
 - Former Papa John's Pizza
 - **Order / Pick-Up window with designated parking spaces available**
 - Hood (6 X 10)
 - Walk-in Cooler (9 X 16)
 - Three compartment sink
 - Single sink
 - Two hand washing stations
- Food court consists of:
 - Common interior courtyard for dining
 - Margarita's Mexican Grill
 - Nu-Way
- Traffic Count:
 - 26,800 VPD on Zebulon Road
- Plenty of shared parking
- Zoned PDE



CONTACT AGENT FOR LEASE RATE



PHOTOS
6012 Zebulon Road
Macon, Bibb County, Georgia 31210





FLOOR PLANS

6012 Zebulon Road
Macon, Bibb County, Georgia 31210

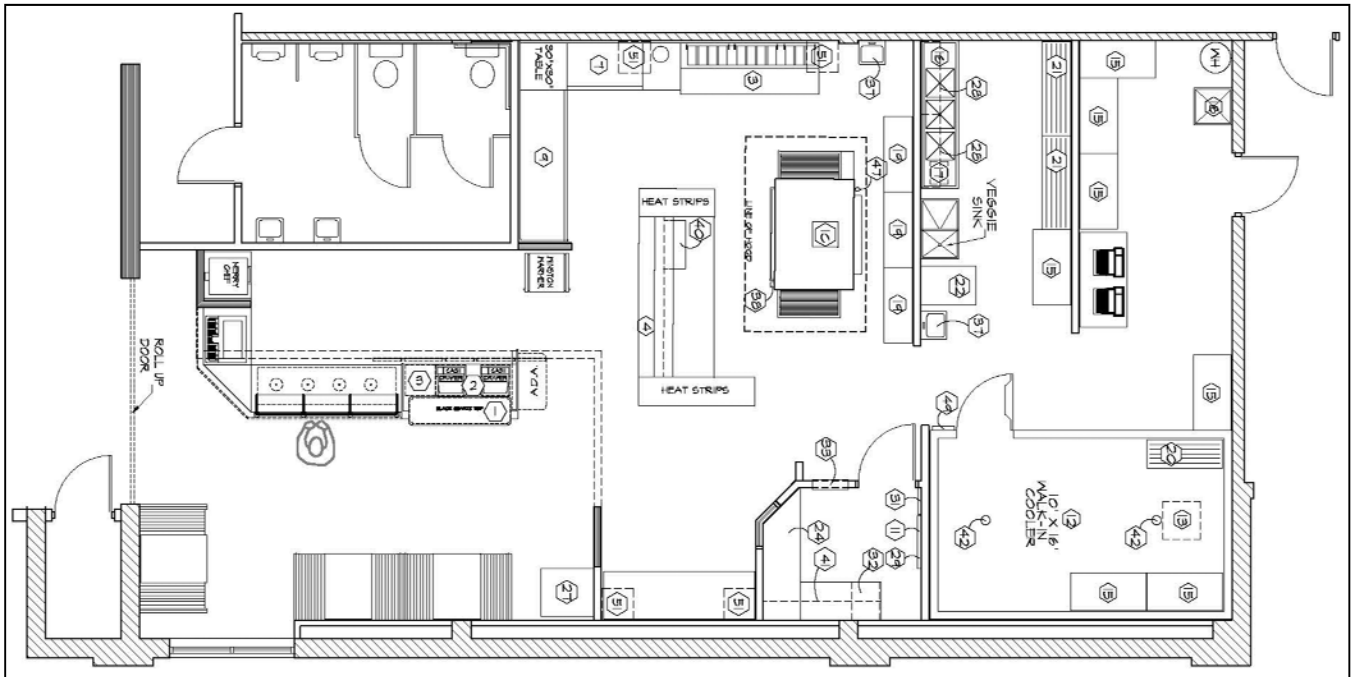
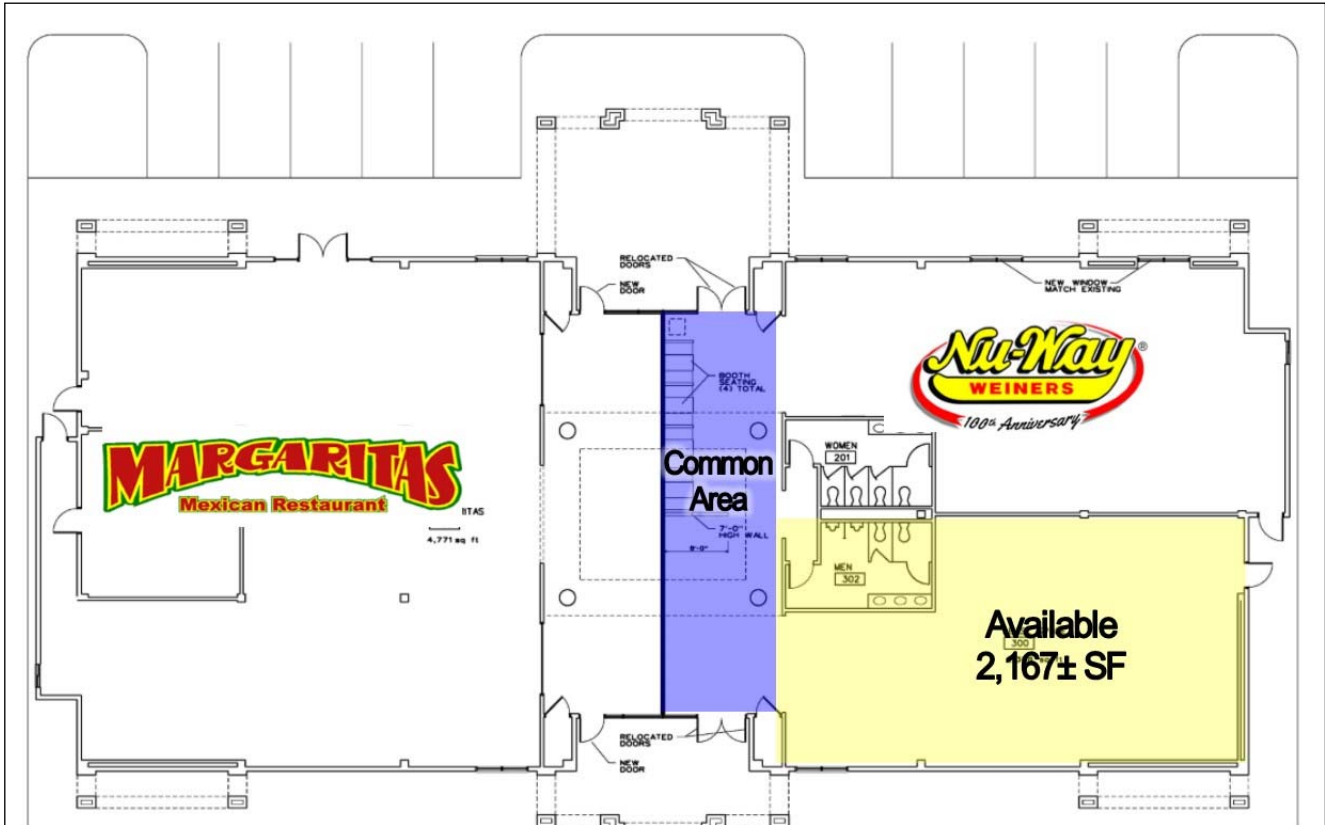

STEPHANIE FOLSOM, CCIM
478.746.8171 Office • 478.361.8259 Cell
stephanie@cbcworldwide.com

CBCMACON.COM



MAPS

6012 Zebulon Road
Macon, Bibb County, Georgia 31210

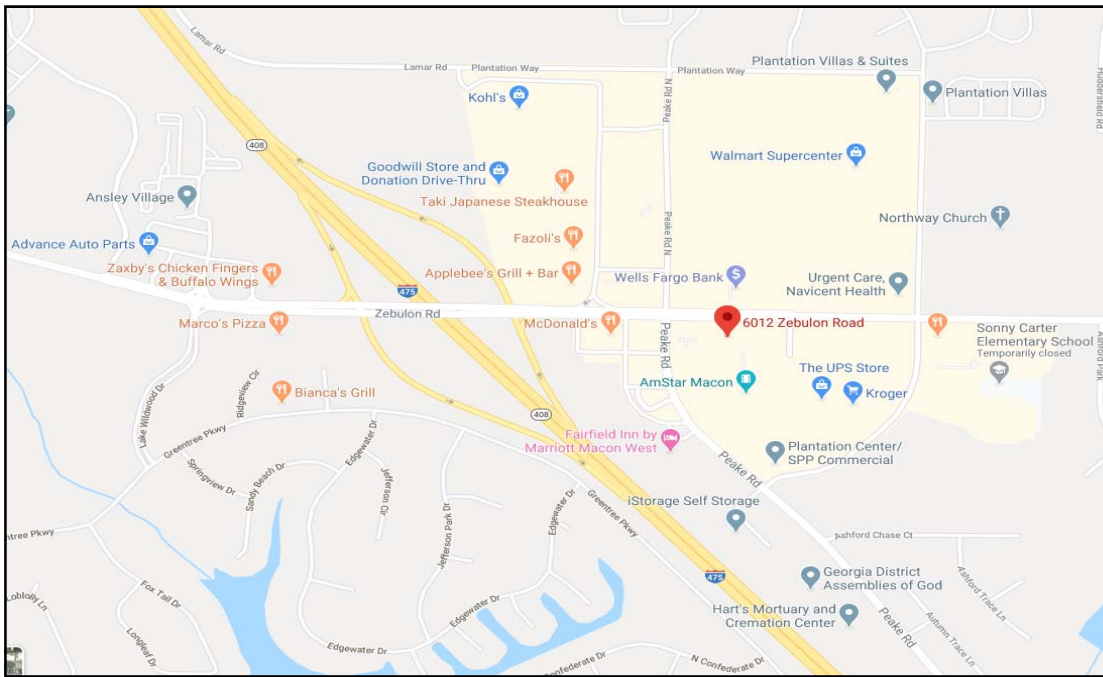

STEPHANIE FOLSOM, CCIM
478.746.8171 Office • 478.361.8259 Cell
stephanie@cbcworldwide.com

CBCMACON.COM



DEMOGRAPHICS - ONE MILE

6012 Zebulon Road
Macon, Bibb County, Georgia 31210

KEY FACTS

3,776

Population



2.5

Average Household Size

45.8

Median Age

\$87,768

Median Household Income

EDUCATION

5%

No High School Diploma



18%

High School Graduate



28%

Some College



49%

Bachelor's/Grad/Prof Degree

BUSINESS



225

Total Businesses



3,391

Total Employees

EMPLOYMENT



81%

White Collar



8%

Blue Collar



11%

Services

5.0%

Unemployment Rate

INCOME



\$87,768

Median Household Income



\$43,600

Per Capita Income



\$233,648

Median Net Worth

Households By Income

The largest group: \$100,000 - \$149,999 (23.8%)

The smallest group: \$15,000 - \$24,999 (2.9%)

Indicator ▲	Value	Diff	
<\$15,000	6.1%	-11.6%	<div style="width: 6.1%;"></div>
\$15,000 - \$24,999	2.9%	-7.8%	<div style="width: 2.9%;"></div>
\$25,000 - \$34,999	5.2%	-7.8%	<div style="width: 5.2%;"></div>
\$35,000 - \$49,999	10.8%	-3.2%	<div style="width: 10.8%;"></div>
\$50,000 - \$74,999	15.3%	+0.7%	<div style="width: 15.3%;"></div>
\$75,000 - \$99,999	16.7%	+5.9%	<div style="width: 16.7%;"></div>
\$100,000 - \$149,999	23.8%	+13%	<div style="width: 23.8%;"></div>
\$150,000 - \$199,999	10.8%	+6.6%	<div style="width: 10.8%;"></div>
\$200,000+	8.6%	+4.5%	<div style="width: 8.6%;"></div>

Bars show deviation from Bibb County



DEMOGRAPHICS - THREE MILE

6012 Zebulon Road
Macon, Bibb County, Georgia 31210

KEY FACTS

21,012

Population



2.5

Average Household Size

42.8

Median Age

\$79,183

Median Household Income

EDUCATION

5%

No High School Diploma



18%

High School Graduate



28%

Some College



49%

Bachelor's/Grad/Prof Degree

BUSINESS



444

Total Businesses



5,621

Total Employees

EMPLOYMENT



White Collar

80%



Blue Collar

10%



Services

10%

4.0%

Unemployment Rate

INCOME



\$79,183

Median Household Income



\$41,986

Per Capita Income



\$203,717

Median Net Worth

Households By Income

The largest group: \$100,000 - \$149,999 (18%)

The smallest group: \$15,000 - \$24,999 (4.5%)

Indicator ▲	Value	Diff	
<\$15,000	5.1%	-12.6%	<div style="width: 100%; height: 10px; background-color: green;"></div>
\$15,000 - \$24,999	4.5%	-6.2%	<div style="width: 100%; height: 10px; background-color: green;"></div>
\$25,000 - \$34,999	7.7%	-5.3%	<div style="width: 100%; height: 10px; background-color: green;"></div>
\$35,000 - \$49,999	13.1%	-0.9%	<div style="width: 100%; height: 10px; background-color: green;"></div>
\$50,000 - \$74,999	16.3%	+1.7%	<div style="width: 100%; height: 10px; background-color: blue;"></div>
\$75,000 - \$99,999	15.6%	+4.8%	<div style="width: 100%; height: 10px; background-color: blue;"></div>
\$100,000 - \$149,999	18%	+7.2%	<div style="width: 100%; height: 10px; background-color: blue;"></div>
\$150,000 - \$199,999	10.8%	+6.6%	<div style="width: 100%; height: 10px; background-color: blue;"></div>
\$200,000+	9%	+4.9%	<div style="width: 100%; height: 10px; background-color: blue;"></div>

Bars show deviation from Bibb County



DEMOGRAPHICS - FIVE MILE

6012 Zebulon Road
Macon, Bibb County, Georgia 31210

KEY FACTS

54,690

Population



Average Household Size

39.1

Median Age

\$63,969

Median Household Income

EDUCATION

6%

No High School Diploma



22%

High School Graduate



28%

Some College



44%

Bachelor's/Grad/Prof Degree

BUSINESS



2,133

Total Businesses



25,577

Total Employees

EMPLOYMENT



77%

White Collar



13%

Blue Collar



10%

Services



Unemployment Rate

INCOME



\$63,969

Median Household Income



\$37,799

Per Capita Income



\$123,145

Median Net Worth

Households By Income

The largest group: \$50,000 - \$74,999 (16.3%)

The smallest group: \$15,000 - \$24,999 (7.3%)

Indicator ▲	Value	Diff	
<\$15,000	8.3%	-9.4%	<div style="width: 9.4%;"></div>
\$15,000 - \$24,999	7.3%	-3.4%	<div style="width: 3.4%;"></div>
\$25,000 - \$34,999	10.1%	-2.9%	<div style="width: 2.9%;"></div>
\$35,000 - \$49,999	13.8%	-0.2%	<div style="width: 0.2%;"></div>
\$50,000 - \$74,999	16.3%	+1.7%	<div style="width: 1.7%;"></div>
\$75,000 - \$99,999	14%	+3.2%	<div style="width: 3.2%;"></div>
\$100,000 - \$149,999	14%	+3.2%	<div style="width: 3.2%;"></div>
\$150,000 - \$199,999	7.4%	+3.2%	<div style="width: 3.2%;"></div>
\$200,000+	8.9%	+4.8%	<div style="width: 4.8%;"></div>

Bars show deviation from Bibb County