

■ **Towson City Center**
Towson, Maryland



Property Highlights

- Traffic counts:
55,375 CPD on York Road (MD State Route 45)
38,132 CPD on Dulaney Valley Road
- 168,000 square foot Class A office building
- LEED Silver Design

- Located across the street from the best enclosed mall in Baltimore (Towson Town Center)
- Towson is the county seat of Baltimore County with over 8,300,000 square feet of office space
- Tremendous visibility with panoramic views
- Close proximity to Towson University (more than 21,000 students) and Goucher College (2,350 students)

Demographics (2013 Estimated)

	1 Mile	3 Mile	5 Mile
Population	19,364	113,839	311,401
Average HH Income	\$77,850	\$88,858	\$86,605

Please Contact

Geoffrey L. Mackler 410.308.6388 (direct) 410.308.0800 (office) 410.486.2733 (fax) gmackler@hrretail.com	Bradley A. Buslik 240.482.3609 (direct) 301.656.3030 (office) 301.656.6222 (fax) bbuslik@hrretail.com
---	--

Towson City Center ■ Towson, Maryland

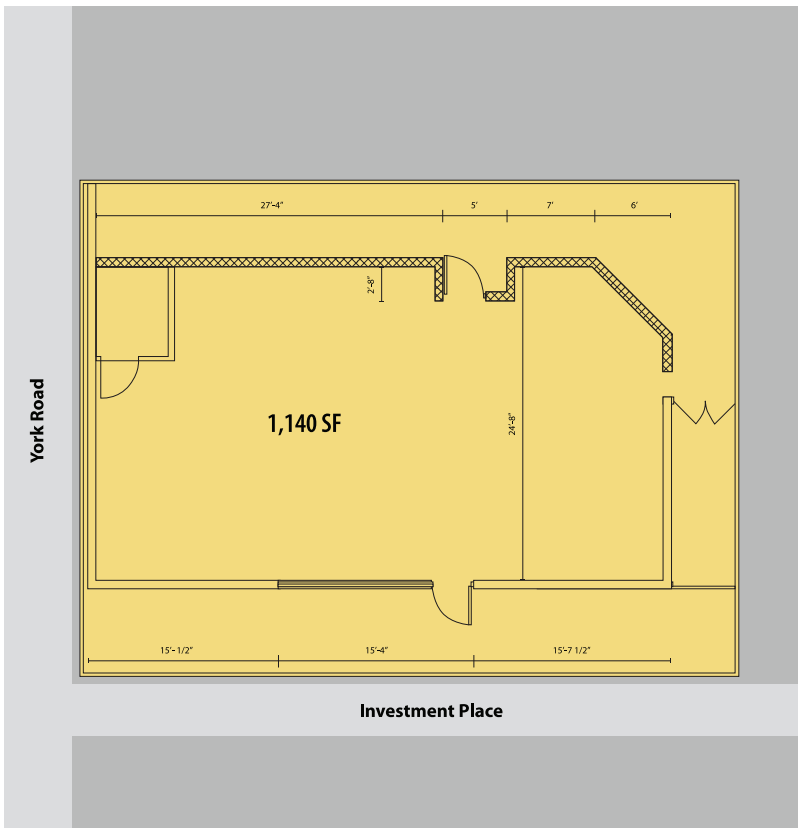
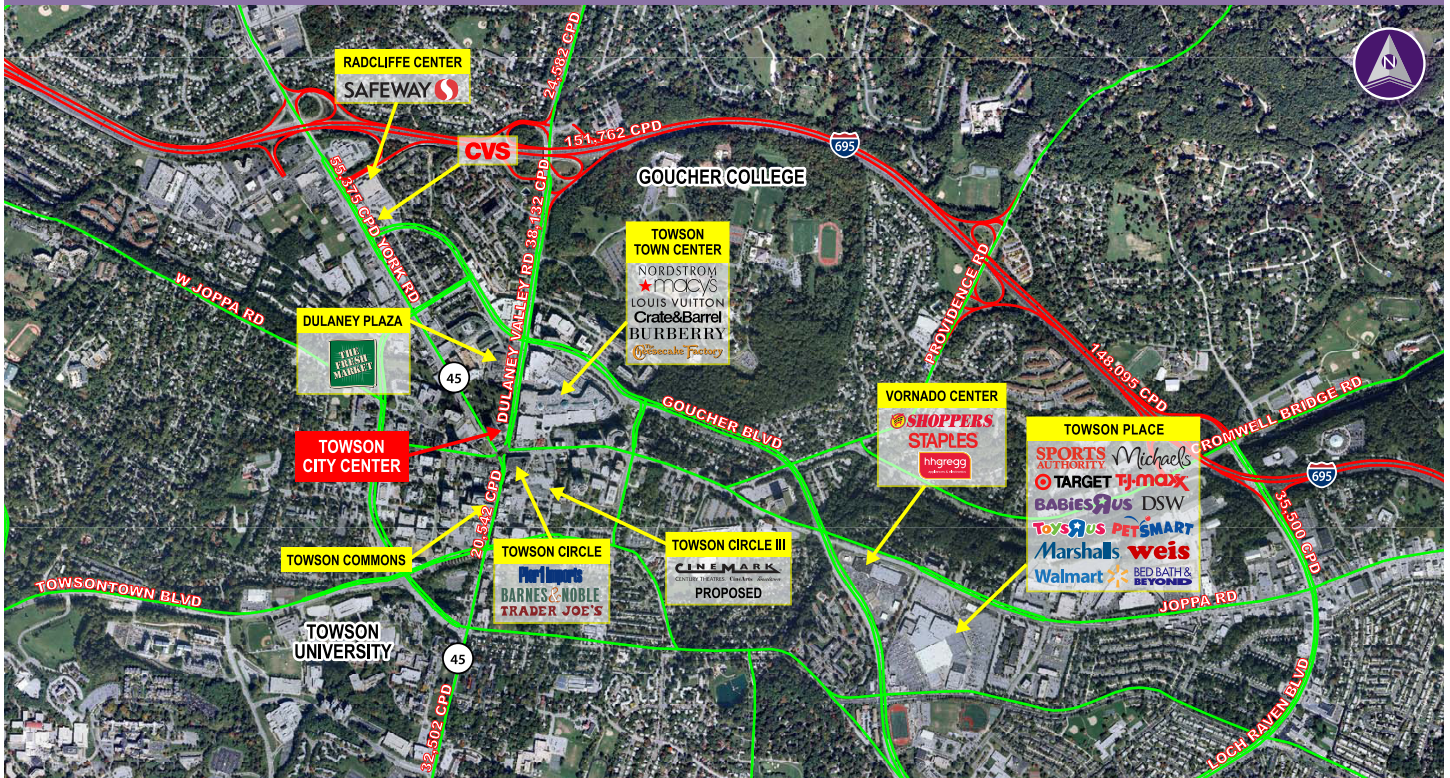

Information herein has been obtained from sources believed to be reliable. While we do not doubt its accuracy, we have not verified it and make no guarantee, warranty or representation about it. Independent confirmation of its accuracy and completeness is your responsibility. H & R Retail, Inc.