



Hi-Tech For Sale or Lease

Property Name:

Location: 2917 Waterview Drive
City, State: Rochester Hills, MI
Cross Streets: Adams Rd./Auburn Rd.
County: Oakland
Zoning: Lt. Industrial

BUILDING SIZE / AVAILABILITY

Building Type:	Built	Mezzanine:	N/A
Total Building Sq. Ft.:	17,420	Available Shop Sq. Ft.:	4,500
Available Sq. Ft.:	17,420	Available Office Sq. Ft.:	12,920
		Office Dim:	N/A
		Shop Dim:	60 x 75

PROPERTY INFORMATION

Freestanding:	Yes	Year Built:	1990 (Retrofit: 2016)
Clear Height:	16'6"	Rail:	No
Grade Level Door(s):	1: 12 x 14	Security:	Yes
Truckwells or Docks:	0	Signage:	Yes
Exterior Construction:	Brick/Block	Interior:	N/A
Structural System:	Steel	Lighting:	Fluorescent
Air-Conditioning:	100%	Bay Sizes:	N/A
Heating:	HVAC	Restrooms:	4
Availability:	Immediately	Cranes:	No
Power (Amps/Volts):	1200 Amps, 480 Volts, Heavy	Parking:	59, +/-
		Roof:	N/A
		Floors:	6" Reinforced
		Floor Drains:	No
		Acreage:	1.480
		Land Dimensions:	Irregular

PRICING INFORMATION

Lease Rate:	Monthly	Mthly Rate:	\$12,992.42/mo	Deposit:	2 Months
Lease Type:	NNN	Lease Term:	5-10 Year(s)	TD:	N/A
Sale Price:	Contact Broker	Taxes:	\$0.72/sf (2019)	Parcel #:	15-30-451-042
Imprv Allow:	N/A	Options:	N/A	Assessor #:	N/A
Tenant Responsibility:	Taxes, Insurance, & CAM				

COMMENTS

First class corporate image building completely renovated in 2016 with high-end finishes. Executive offices with private washroom, two glass entry points. Can be offered furnished or vacant. Currently 2,250 sq. ft. of shop with another 2,250 sq. ft. of shop that is carpeted. Excellent hi-tech building with direct access to M-59, seconds from I-75 and FCA World. Building has a generator.

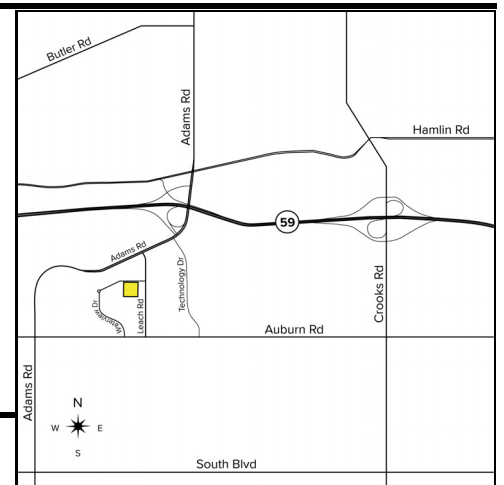

Broker: SIGNATURE ASSOCIATES

Agent(s):

Kris Pawlowski, (248) 359-3801, kpawlowski@signatureassociates.com
 Dave Miller, (248) 948-4183, dmiller@signatureassociates.com