

545

**CORPORATE DR
ESCONDIDO
CA**

FOR LEASE



**FOR
LEASE**

**545 CORPORATE DRIVE
ESCONDIDO, CA 92029**



OFFERING SUMMARY

LEASE RATE:	\$1.50 SF/M (MG)
MONTHLY RATE:	\$3,300
SPACE AVAILABLE:	2,200 SF
PER OFFICE RATE:	\$700/M

PROPERTY OVERVIEW

Newer modern building with nicely appointed second floor office space

PROPERTY HIGHLIGHTS

- 5 x Large Private Offices
- 1 Office has a Private Restroom with a Shower
- Large North Facing Windows
- Kitchenette with mini fridge and sink
- Easy access to the I-5 & CA-78 Expressways
- Walking Distance to the Sprinter

All information contained herein is from sources deemed reliable and is submitted subject to errors, omissions and to change of price or terms without notice.



MARK NELSON, SIOR
PRINCIPAL
858 230 1204
MARK@NELSONHILL.COM

MIKE NELSON, SIOR
PRINCIPAL
858 232 2481
MIKE@NELSONHILL.COM

NELSONHILL.COM



**FOR
LEASE**

**545 CORPORATE DRIVE
ESCONDIDO, CA 92029**

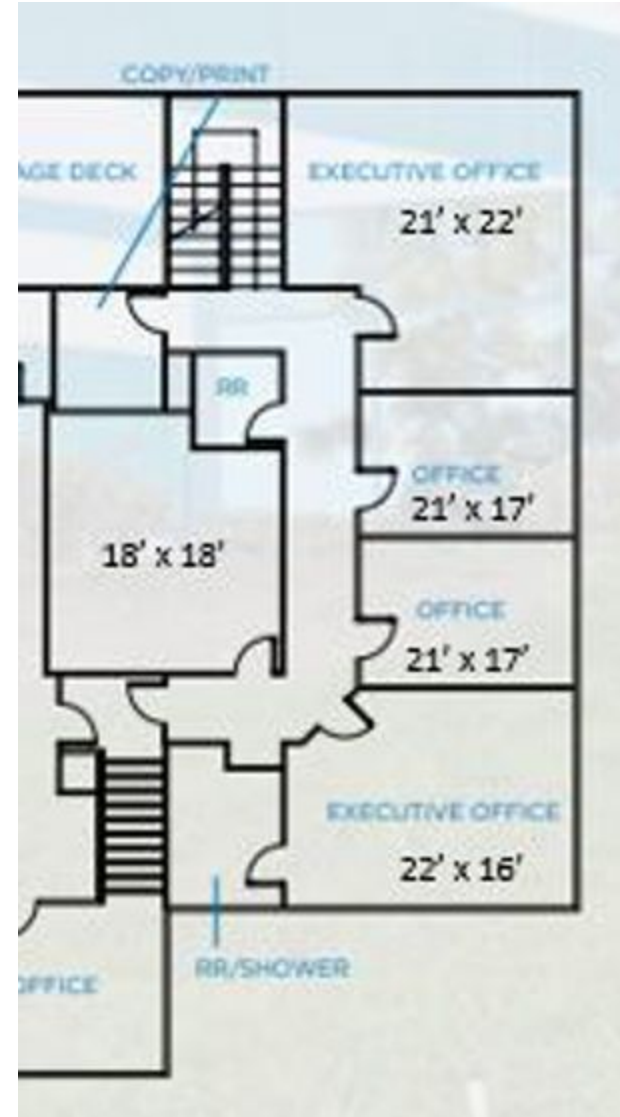



**FOR
LEASE**

**545 CORPORATE DRIVE
ESCONDIDO, CA 92029**

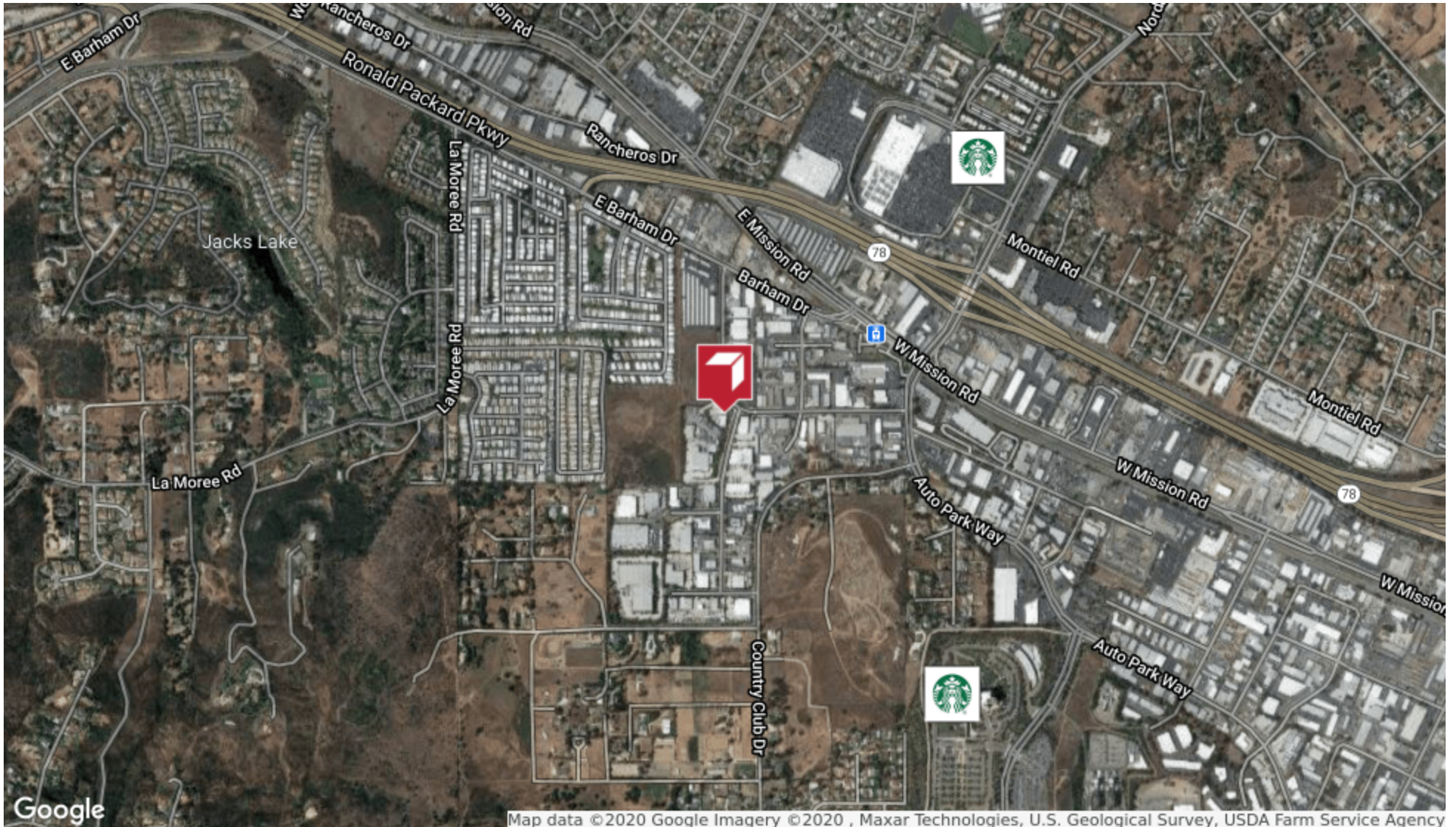



**FOR
LEASE**

**545 CORPORATE DRIVE
ESCONDIDO, CA 92029**

POPULATION	1 MILE	5 MILES	10 MILES
TOTAL POPULATION	6,907	208,459	534,237
AVERAGE AGE	35.4	33.8	37.2
AVERAGE AGE (MALE)	34.9	32.5	36.1
AVERAGE AGE (FEMALE)	35.9	35.0	38.1
HOUSEHOLDS & INCOME	1 MILE	5 MILES	10 MILES
TOTAL HOUSEHOLDS	2,637	67,827	183,116
# OF PERSONS PER HH	2.6	3.1	2.9
AVERAGE HH INCOME	\$68,886	\$73,145	\$91,428
AVERAGE HOUSE VALUE	\$399,120	\$461,912	\$584,490

** Demographic data derived from 2010 US Census*

