

300-350 CRAMER CREEK COURT
DUBLIN, OHIO 43017



OFFICE FOR LEASE

+/- 16,429 SF Available (Divisible)

CRAMER CREEK



PROPERTY FEATURES

- Ideally situated on Frantz Road between Tuttle Crossing and Route 161. Less than one mile from Route 33/161 and I-270 exit to the north and the Tuttle Mall interchange to the south
- 42,075 SF of multi-tenant, single story, stucco and glass office building
- Multiple drive-in's available
- End cap with great exposure

OVERVIEW

AVAILABLE	+/- 16,429 SF (Divisible)
ASKING RATE	\$9.00/SF Net
OPERATING EXPENSES	\$4.54/SF estimated for 2015
PARKING	4 spaces/1,000 SF of occupied space

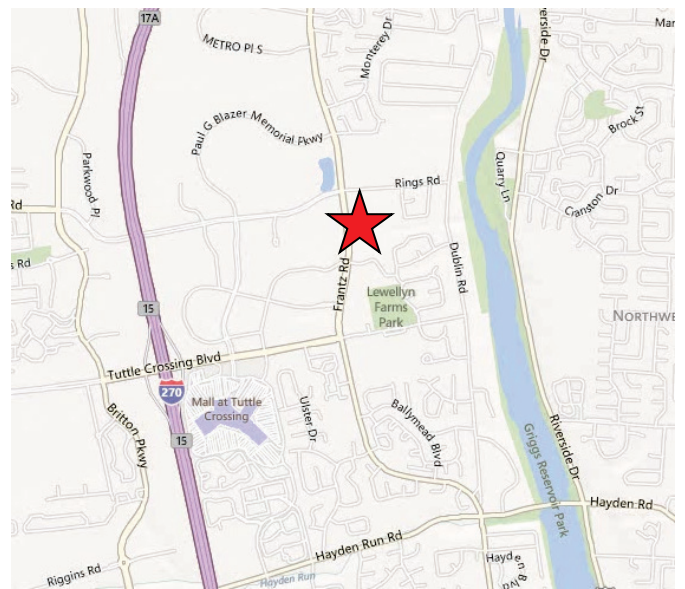

For more information, please contact:

BRENT STAMM, CCIM
Senior Vice President
(614) 883 1141
bstamm@continental-realty.com

TOM SUGAR
Executive Vice President
(614) 883 1066
tsugar@continental-realty.com

**CONTINENTAL REALTY /
CUSHMAN & WAKEFIELD ALLIANCE**
150 E. Broad Street, Suite 500
Columbus, OH 43215
www.continental-realty.com

The depiction in the included photograph of any person, entity, sign, logo or property, other than Continental Realty's (CR) client and the property offered by CR, is incidental only, and is not intended to connote any affiliation, connection, association, sponsorship or approval by or between that which is incidentally depicted and CR or its client. This listing shall not be deemed an offer to lease, sublease or sell such property; and, in the event of any transaction for such property, no commission shall be earned by or payable to any cooperating broker except if otherwise provided pursuant to the express terms, rates and conditions of CR's agreement with its principal, if, as and when such commission (if any) is actually received from such principal. (A copy of the rates and conditions referred to above with respect to this property is available upon request.)

300-350 CRAMER CREEK COURT

Office for Lease

+/- 16,429 SF
AVAILABLE

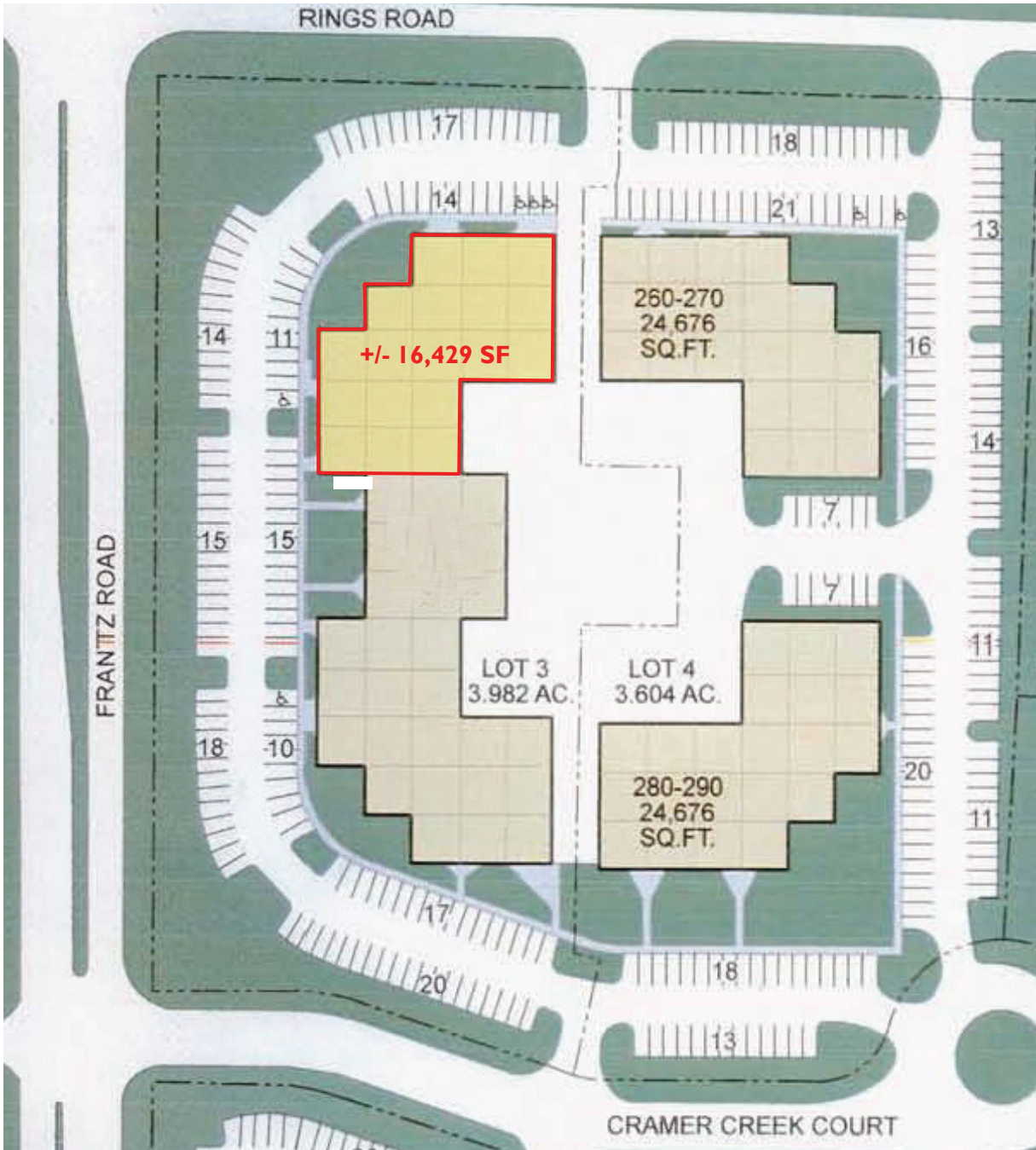

For more information, please contact:

BRENT STAMM, CCIM
Senior Vice President

(614) 883 1141

bstamm@continental-realty.com

TOM SUGAR

Executive Vice President

(614) 883 1066

tsugar@continental-realty.com

**CONTINENTAL REALTY /
CUSHMAN & WAKEFIELD ALLIANCE**

150 E. Broad Street, Suite 500

Columbus, OH 43215

www.continental-realty.com

The depiction in the included photograph of any person, entity, sign, logo or property, other than Continental Realty's (CR) client and the property offered by CR, is incidental only, and is not intended to connote any affiliation, connection, association, sponsorship or approval by or between that which is incidentally depicted and CR or its client. This listing shall not be deemed an offer to lease, sublease or sell such property; and, in the event of any transaction for such property, no commission shall be earned by or payable to any cooperating broker except if otherwise provided pursuant to the express terms, rates and conditions of CR's agreement with its principal, if, as and when such commission (if any) is actually received from such principal. (A copy of the rates and conditions referred to above with respect to this property is available upon request.)

300-350 CRAMER CREEK COURT

Office for Lease

+/- 16,429 SF
AVAILABLE



For more information, please contact:

BRENT STAMM, CCIM

Senior Vice President

(614) 883 1141

bstamm@continental-realty.com

TOM SUGAR

Executive Vice President

(614) 883 1066

tsugar@continental-realty.com

**CONTINENTAL REALTY /
CUSHMAN & WAKEFIELD ALLIANCE**

150 E. Broad Street, Suite 500

Columbus, OH 43215

www.continental-realty.com

The depiction in the included photograph of any person, entity, sign, logo or property, other than Continental Realty's (CR) client and the property offered by CR, is incidental only, and is not intended to connote any affiliation, connection, association, sponsorship or approval by or between that which is incidentally depicted and CR or its client. This listing shall not be deemed an offer to lease, sublease or sell such property; and, in the event of any transaction for such property, no commission shall be earned by or payable to any cooperating broker except if otherwise provided pursuant to the express terms, rates and conditions of CR's agreement with its principal, if, as and when such commission (if any) is actually received from such principal. (A copy of the rates and conditions referred to above with respect to this property is available upon request.)