

INDUSTRIAL – FOR LEASE

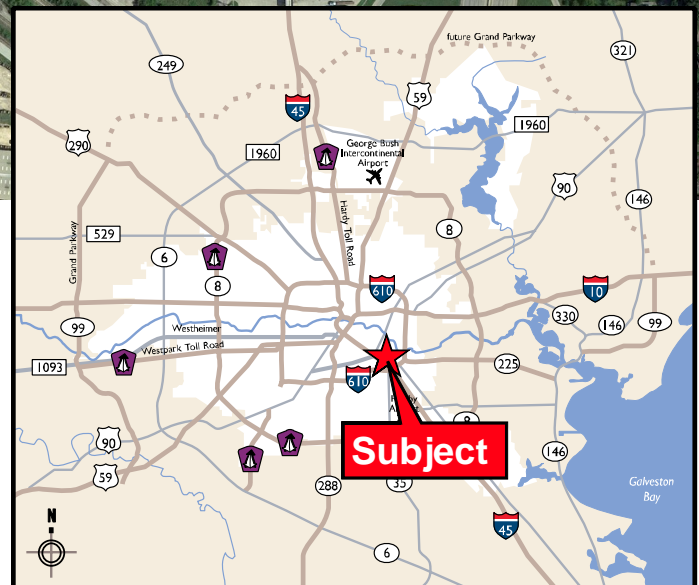

- 61,034 sq. ft. in two buildings on 4.5109 acres of land
- Located in the Turning Basin Industrial District across from the Port of Houston
- Additional land can be available
- Key Map 495U
- Availability: 30 days
- Reduced Lease rate: \$18,500/mo. NNN



For more information, contact:

B. Kelley Parker III, SIOR
(713) 963 2896
Kelley.Parker@cushwake.com

John F. Littman, SIOR
(713) 963 2862
John.Littman@cushwake.com

Coe Parker, SIOR
(713) 963 2825
Coe.Parker@cushwake.com

1330 Post Oak Boulevard
Suite 2700
Houston, TX 77056

cushmanwakefield.com

Building A

- ±34,006 sq. ft. total
- ±8,000 sq. ft. warehouse
- ±2,000 sq. ft. office
- ±1.7 acres
- ±26,006 sq. ft., crane-ready, two 5-ton
- Clear height 30'
- Stabilized / paved fenced yard

Building B

- ±27,028 sq. ft. total
- ±2.8109 acres
- Two 10-ton OH cranes
- Stabilized / paved fenced yard
- Clear height 30'
- Office area could be built out

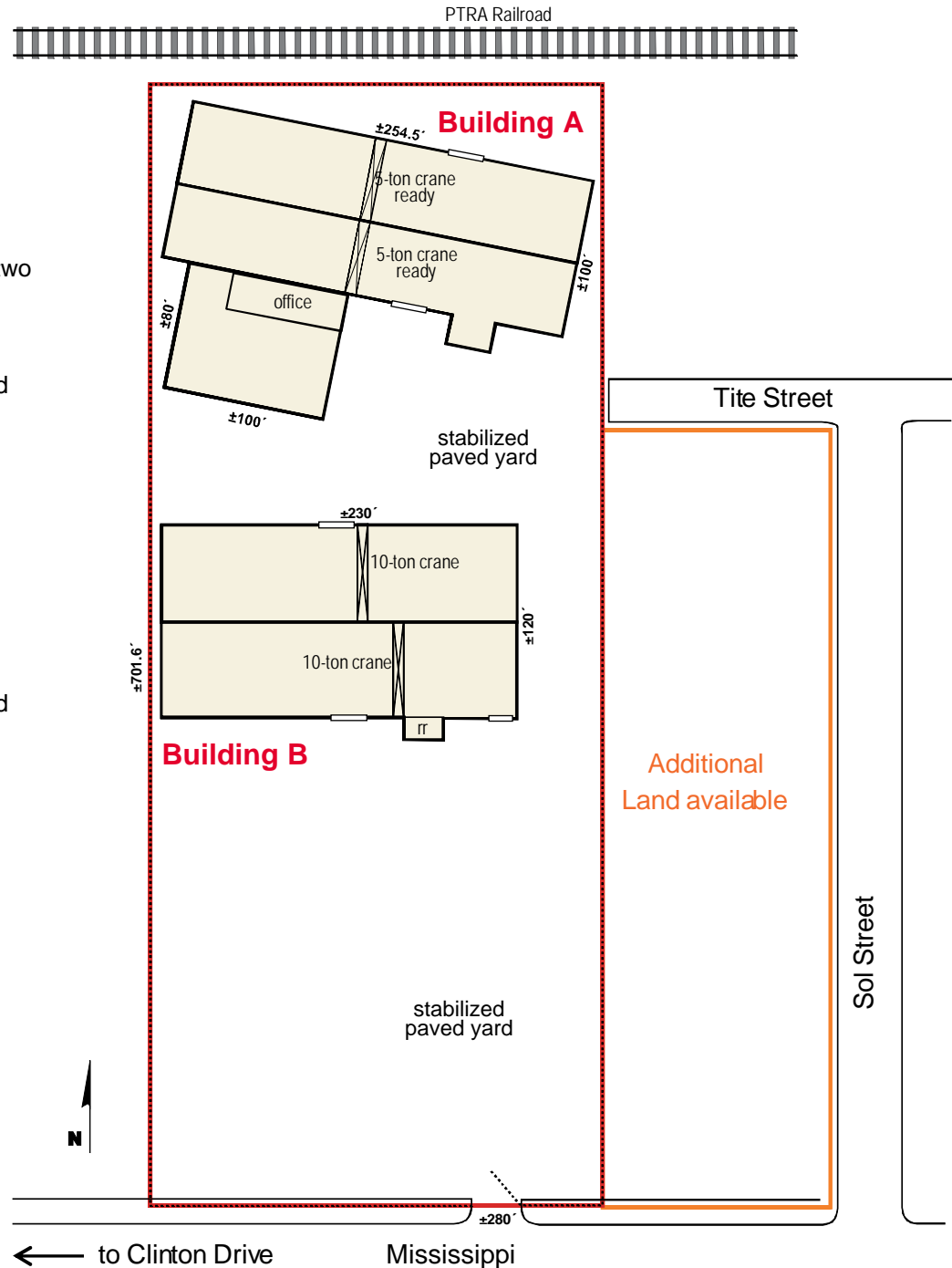

For more information, contact:

B. Kelley Parker III, SIOR
(713) 963 2896
Kelley.Parker@cushwake.com

John F. Littman, SIOR
(713) 963 2862
John.Littman@cushwake.com

Coe Parker, SIOR
(713) 963 2825
Coe.Parker@cushwake.com

1330 Post Oak Boulevard
Suite 2700
Houston, TX 77056

cushmanwakefield.com