



HIGHLIGHTS

- **EASTLAND PROFESSIONAL BUILDING - Move-In Ready!**
- 2 freestanding, two-story office buildings facing Workman Street between Citrus Street and Barranca Avenue
- Recently upgraded with exterior paint, landscaping and newer windows
- Professional environment with large windows, interior atriums, abundant parking and stairwell access from inside and outside
- Amenity rich, adjacent to Eastland Shopping Center
- Easy access to bus stop and I-10 freeway

RENTAL RATE

\$1.55 PSF/FSG

SUITE

SQ. FT.

281-102

1,940

281-201

1,280

281-204

1,221

PROPERTY DETAILS

Building Size

±20,744

Year Built

1962
Recently Updated

Parking

4/1,000



For more information please contact:

CHRISTOPHER LARIMORE

Founding Principal

P • 626.240.2788

E • clarimore@lee-associates.com

LICENSE ID #01314464

VINCENT MOLITOR

Principal

P • 626.240.2787

E • vmolitor@lee-associates.com

LICENSE ID #01295360

A Member of



COMMERCIAL REAL ESTATE SERVICES

LEE & ASSOCIATES - PASADENA

155 N. Lake Avenue, Suite 800

Pasadena, CA 91101

626.535.9888 P • 626.410.6705 F

Corporate ID #01125429

CLIENT FOCUSED. PERFORMANCE DRIVEN.



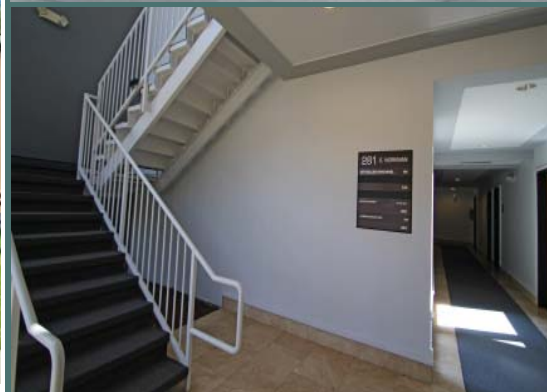

For more information please contact:

CHRISTOPHER LARIMORE

Founding Principal

P • 626.240.2788

E • clarimore@lee-associates.com

LICENSE ID #01314464

VINCENT MOLITOR

Principal

P • 626.240.2787

E • vmolitor@lee-associates.com

LICENSE ID #01295360

A Member of

LEE & ASSOCIATES

COMMERCIAL REAL ESTATE SERVICES

LEE & ASSOCIATES - PASADENA

155 N. Lake Avenue, Suite 800

Pasadena, CA 91101

626.535.9888 P • 626.410.6705 F

Corporate ID #01125429

CLIENT FOCUSED. PERFORMANCE DRIVEN.    

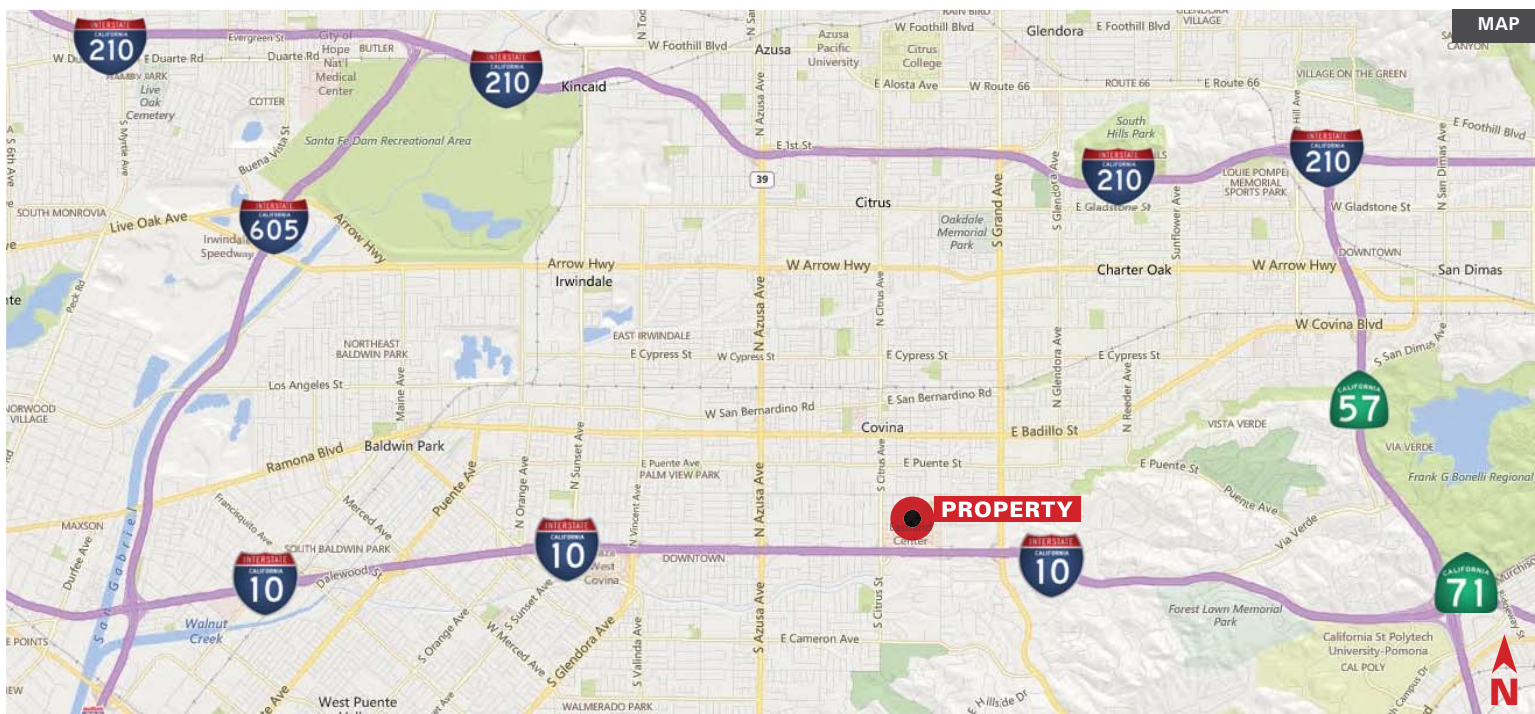

For more information please contact:

CHRISTOPHER LARIMORE

Founding Principal

P • 626.240.2788

E • clarimore@lee-associates.com

LICENSE ID #01314464

VINCENT MOLITOR

Principal

P • 626.240.2787

E • vmolitor@lee-associates.com

LICENSE ID #01295360

A Member of

LEE & ASSOCIATES

COMMERCIAL REAL ESTATE SERVICES

LEE & ASSOCIATES - PASADENA

155 N. Lake Avenue, Suite 800

Pasadena, CA 91101

626.535.9888 P • 626.410.6705 F

Corporate ID #01125429

CLIENT FOCUSED. PERFORMANCE DRIVEN.