



Jameson Office Park

3500 S. Phillips Avenue, Sioux Falls, SD

Property Features

- Suite 101: 1,961 sq. ft.
- Suite 201: 1,894 sq. ft.
- Suite 247: 2,153 sq. ft.
- Professional, private location
- Recently renovated and updated
- Suite features private offices
- Common area restrooms and board/conference room included in rent
- Paved, on-site parking

Pricing

- Lease rate: \$12.00/ sq. ft. gross plus utilities

Location

- Building located on the Southeast corner of E. 43rd Street and S. Phillips Avenue
- Easy access to Minnesota Avenue, Interstate 229 and 41st Street

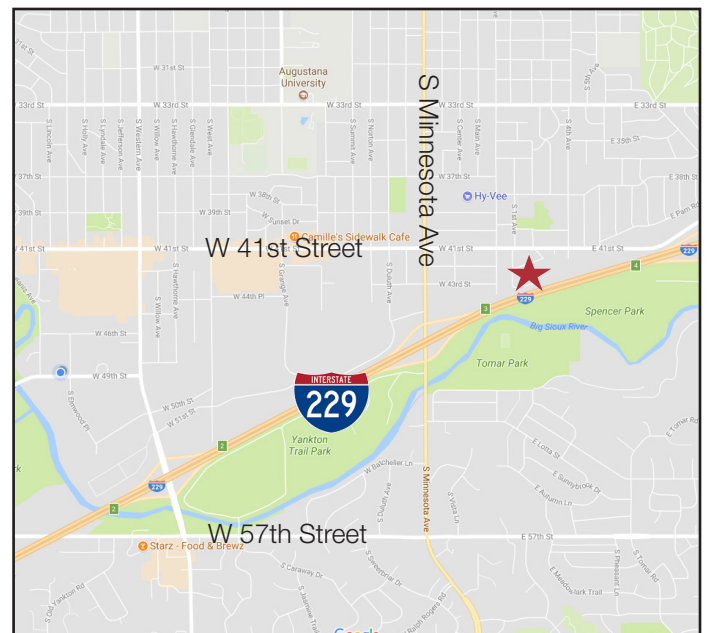

Ryan Ammann

+1 605 444 7131 direct

+1 605 310 7091 mobile

rammann@naisiouxfalls.com

NO WARRANTY OR REPRESENTATION, EXPRESS OR IMPLIED, IS MADE AS TO THE ACCURACY OF THE INFORMATION CONTAINED HEREIN, AND THE SAME IS SUBMITTED SUBJECT TO ERRORS, OMISSIONS, CHANGE OF PRICE, RENTAL OR OTHER CONDITIONS, PRIOR SALE, LEASE OR FINANCING, OR WITHDRAWAL WITHOUT NOTICE, AND OF ANY SPECIAL LISTING CONDITIONS IMPOSED BY OUR PRINCIPALS. NO WARRANTIES OR REPRESENTATIONS ARE MADE AS TO THE CONDITION OF THE PROPERTY OR ANY HAZARDS CONTAINED THEREIN ARE ANY TO BE IMPLIED.

2500 W. 49th Street, Suite 100

Sioux Falls, SD 57105

+1 605 357 7100

naisiouxfalls.com

For Lease
Office Suites



First Floor Plan



Second Floor Plan

For Lease
Office Suites



Suite #101

For Lease
Office Suites

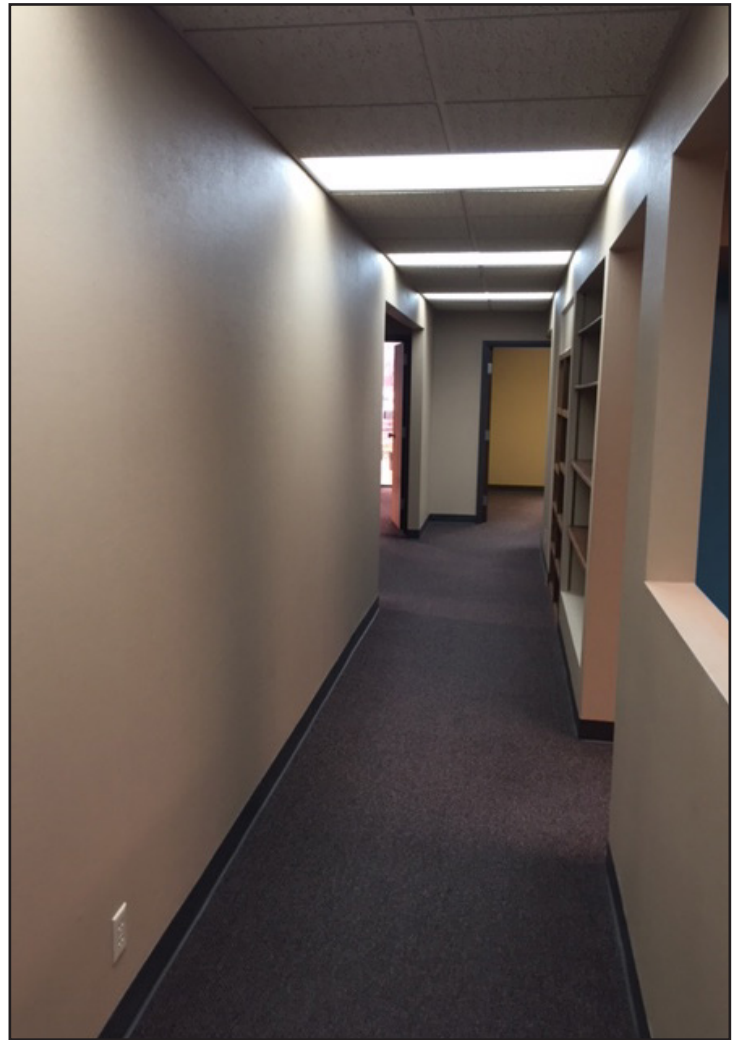

For Lease
Office Suite

