

33,614 SF (DIVISIBLE)

Industrial Space For Lease



Prologis Park Addison

901 S. Rohlwing Road, Units H & J
Addison, IL 60101 USA

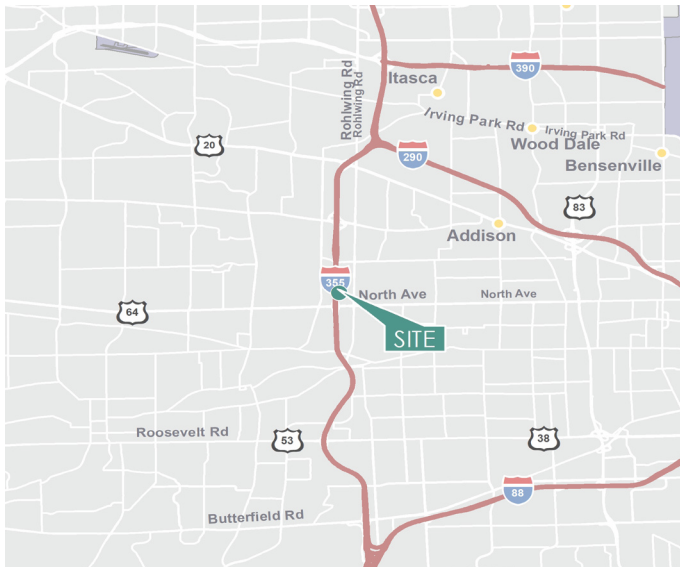

LOCATION

- Immediate access to I-355 via North Avenue (Route 64)
- Close proximity to other major highways

FACILITY

- 133,892 SF building
- 33,614 SF available (divisible)
- 15,059 SF office area (can be reduced)
- 18' clear height
- 3 shared interior docks
- 1 drive-in door
- +/- 66 car spaces

ADVANTAGES AND AMENITIES

- Low DuPage County taxes
- Institutionally owned and managed facility

33,614 SF (DIVISIBLE)

Industrial Space For Lease

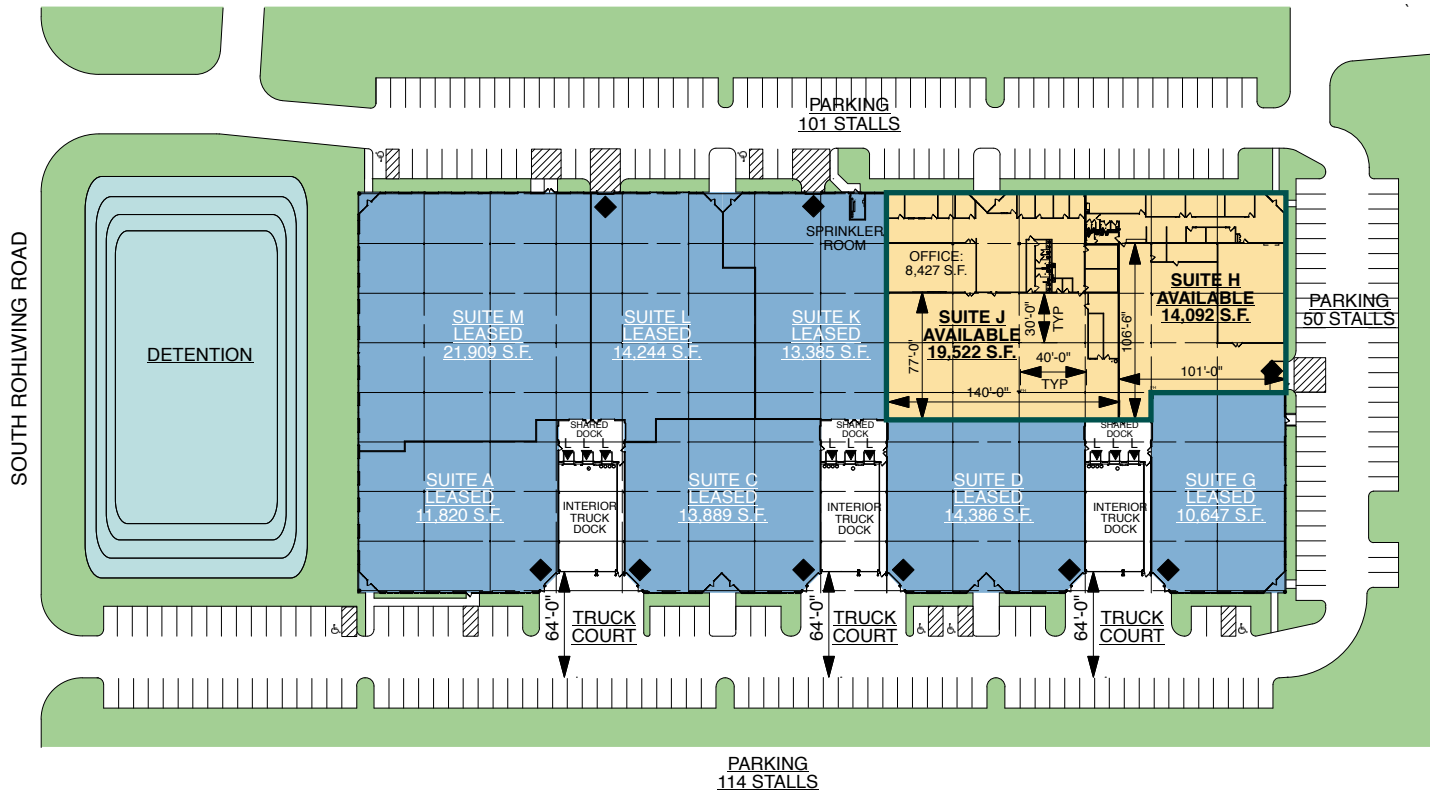

 **TRANSWESTERN** REAL ESTATE SERVICES

Transwestern

Justin Lerner, SIOR

justin.lerner@transwestern.com

ph +1 847 588 5665

cell +1 847 858 5303

9550 W. Higgins Road

Suite 250

Rosemont, IL 60018 USA

Transwestern

Joe Karmin

joe.karmin@transwestern.com

ph +1 847 588 5670

cell +1 847 287 4567

9550 W. Higgins Road

Suite 250

Rosemont, IL 60018 USA

Transwestern

Ross Lehrman

ross.lehrman@transwestern.com

ph +1 847 588 5671

cell +1 847 946 4602

9550 W. Higgins Road

Suite 250

Rosemont, IL 60018 USA

Prologis

Kerry Gilar

kgilar@prologis.com

ph +1 847 292 3947

cell +1 630 661 1820

6250 N. River Road

Suite 1100

Rosemont, IL 60018 USA