

AVAILABLE FOR LEASE

2001 W. PARKES DRIVE, BROADVIEW, IL



BUILDING SPECIFICATIONS

| | |
|---------------------------|--|
| Building Size: | 53,284 SF |
| Office: | 10,500 SF |
| Land: | 2.7 Acres |
| Ceiling Height: | 18' Clear |
| Loading: | 4 Interior Docks w/ Levelers 2 Drive-in Doors |
| Power: | 400a; 277/480v; 3-phase 200a; 120/240v; 3-phase |
| Parking: | 90 cars |
| Sprinkler: | Fully |
| Heat: | Gas |
| Real Estate Taxes: | \$1.21 psf (2016 paid in 2017) |
| Lease Rate: | \$3.95 psf net |



FEATURES

- Free-standing masonry building
- 6" Reinforced concrete floors
- Minutes from I-290 / I-294
- (1) 2-ton crane
- Skilled labor force
- 13 miles to Chicago Loop
- 14 miles to O'Hare Airport
- 4-way interchange at I-290 and 25th Avenue

**FOR ADDITIONAL
INFORMATION,
PLEASE CONTACT:**

GEORGE J. CIBULA, SIOR
Managing Broker
630-993-3860
gcibula@darwinrealty.com

MANDY LEWANDOWSKI
Associate
630-993-3851
mandy@darwinrealty.com

AVAILABLE FOR LEASE

2001 W. PARKES DRIVE, BROADVIEW, IL

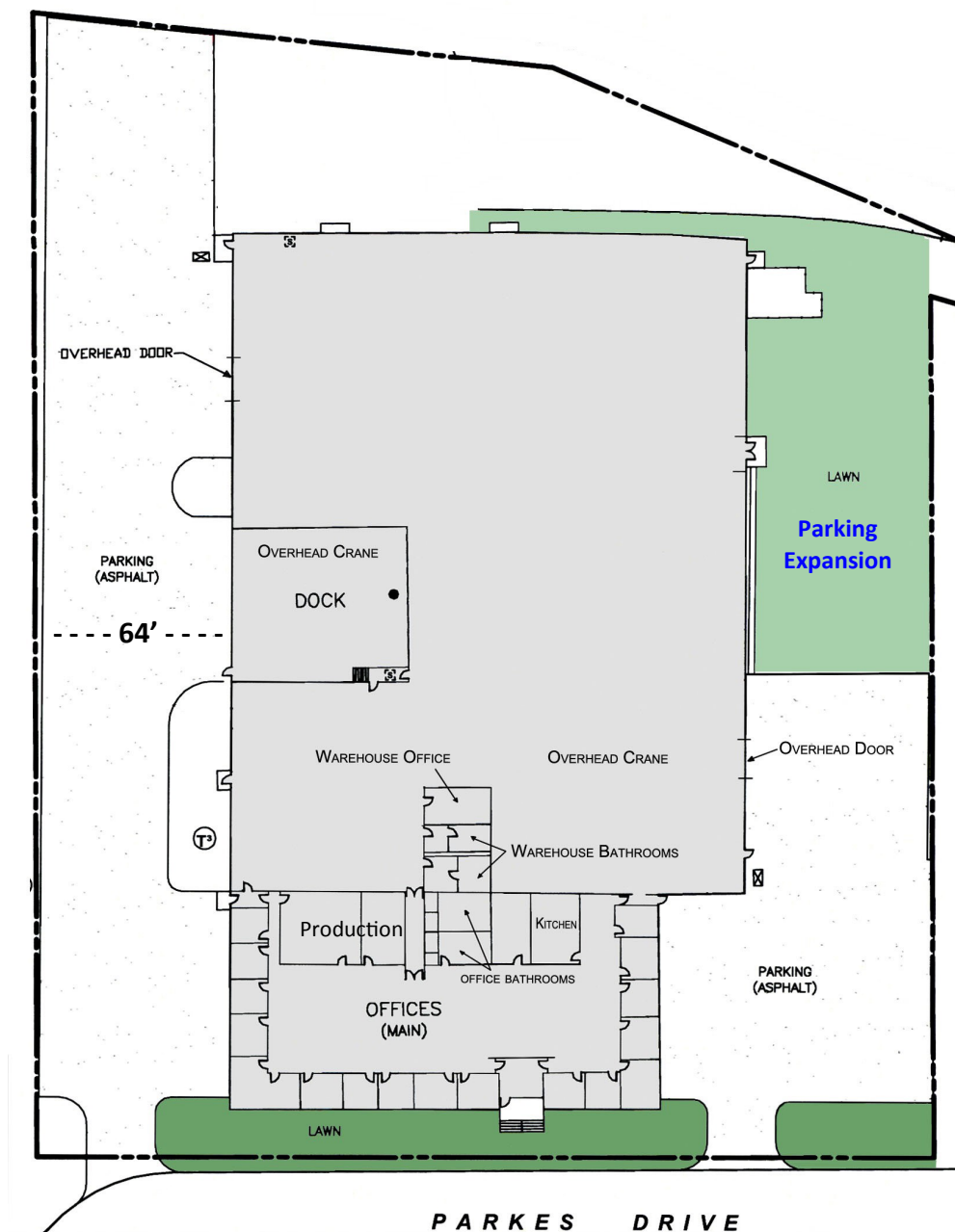

**FOR ADDITIONAL
INFORMATION,
PLEASE CONTACT:**

GEORGE J. CIBULA, SIOR
Managing Broker
630-993-3860
gcibula@darwinrealty.com

MANDY LEWANDOWSKI
Associate
630-993-3851
mandy@darwinrealty.com