



HighMark Medical Center

1740 NW MAPLE ST, ISSAQUAH, WA

FOR LEASE



New Class A
medical office
space available

**HOME TO THE AREA'S MOST
PROMINENT HEALTHCARE
PROVIDERS**

Overlake Hospital Medical Center

UW Neighborhood Clinics

Seattle Cancer Care Alliance

KEITH HONSBERGER

425.450.1107

keith.honsberger@kidder.com

GARY GUENTHER

425.450.1154

gary.guenther@kidder.com



**4.5/1,000 USF
PARKING**

Building owned and managed by
HEALTHCARE REALTY



LEED GOLD CERTIFIED

**Kidder
Mathews**

This information supplied herein is from sources we deem reliable. It is provided without any representation, warranty, or guarantee, expressed or implied as to its accuracy. Prospective Buyer or Tenant should conduct an independent investigation and verification of all matters deemed to be material, including, but not limited to, statements of income and expenses. Consult your attorney, accountant, or other professional advisor.

KIDDER.COM

FOR LEASE

HighMark Medical Center

1740 NW MAPLE ST, ISSAQUAH, WA

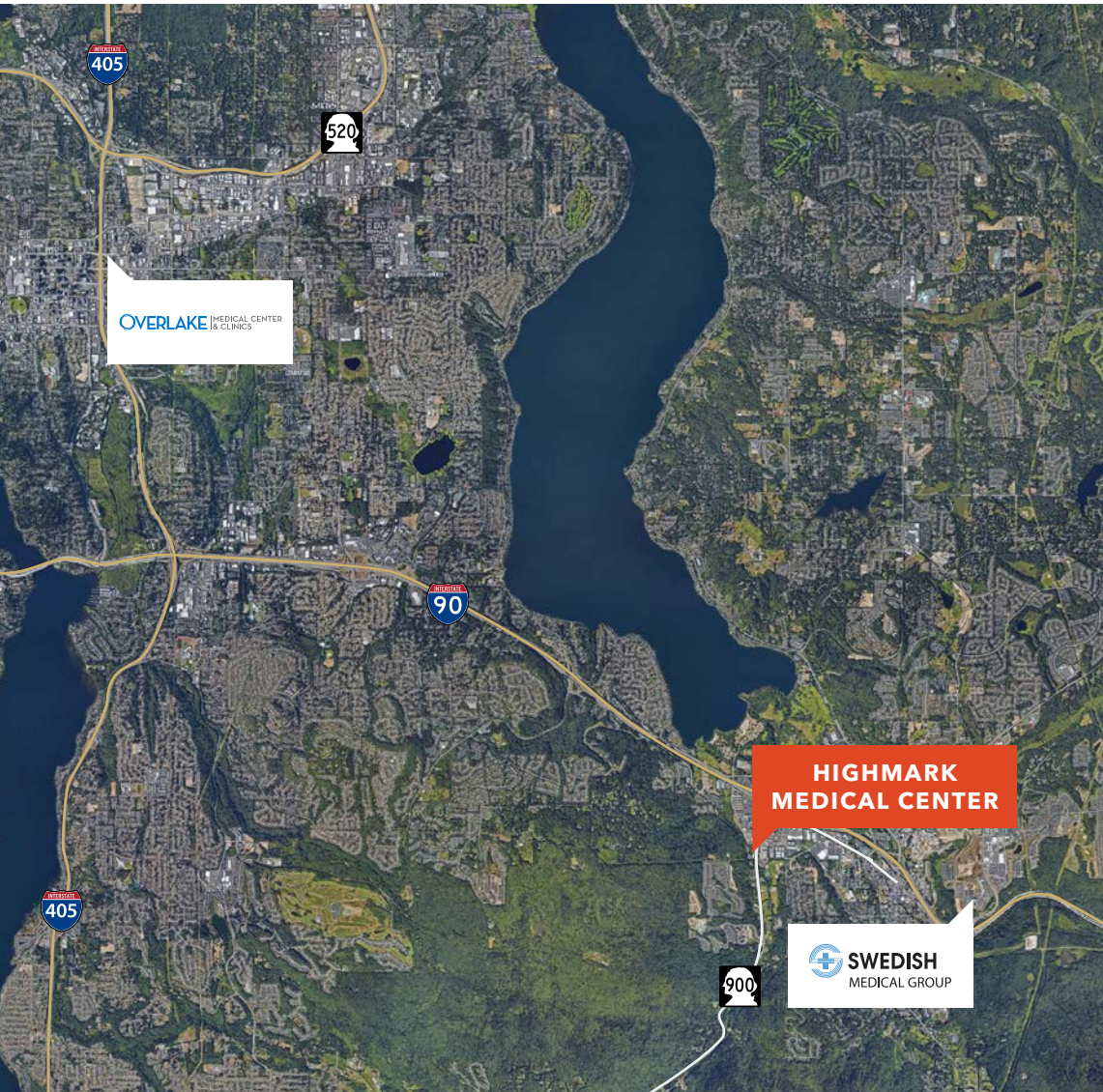

KIDDER.COM

This information supplied herein is from sources we deem reliable. It is provided without any representation, warranty, or guarantee, expressed or implied as to its accuracy. Prospective Buyer or Tenant should conduct an independent investigation and verification of all matters deemed to be material, including, but not limited to, statements of income and expenses. Consult your attorney, accountant, or other professional advisor.

km Kidder Mathews

FOR LEASE

HighMark Medical Center

1740 NW MAPLE ST, ISSAQUAH, WA

Second Floor

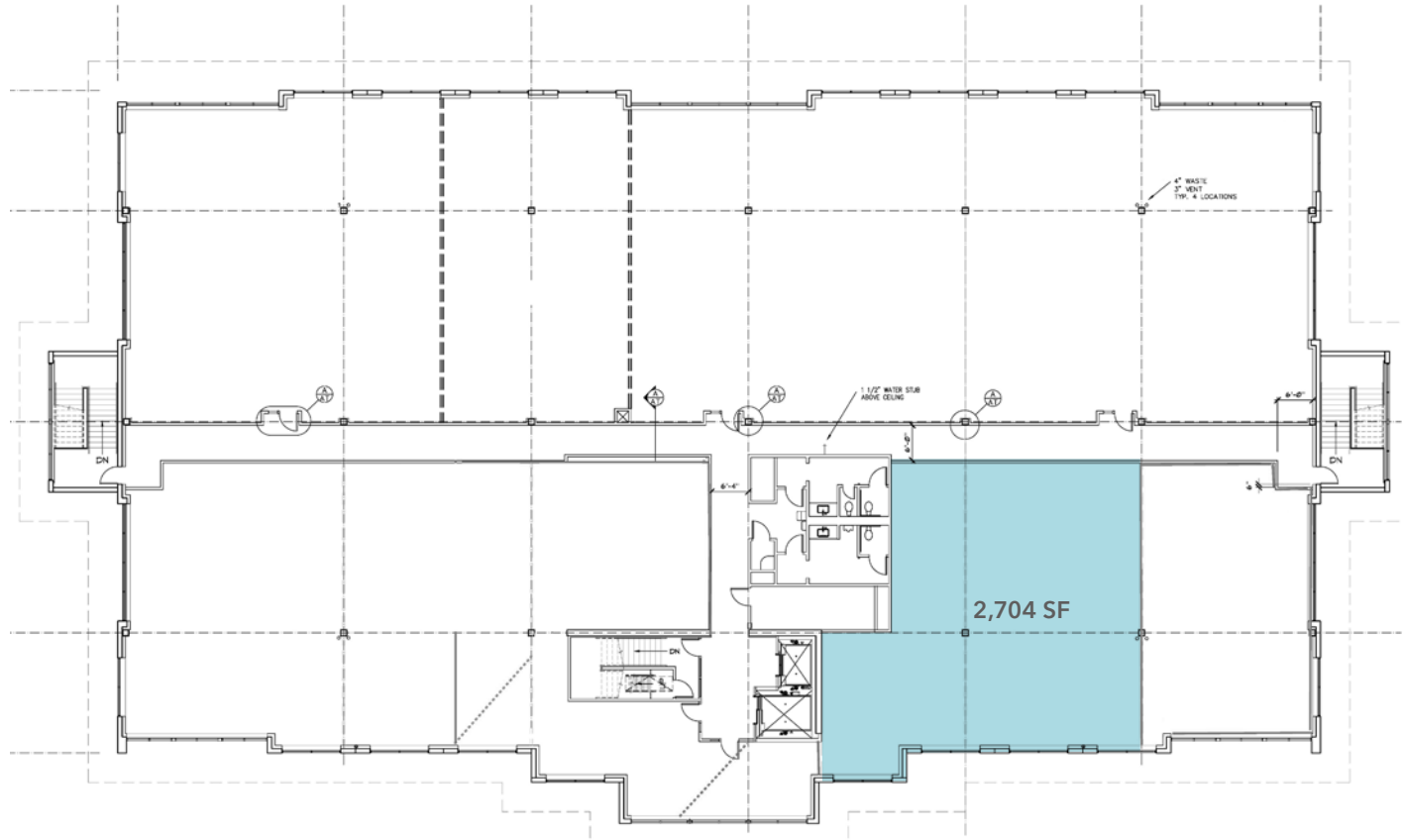

KEITH HONSBERGER

425.450.1107

keith.honsberger@kidder.com

GARY GUENTHER

425.450.1154

gary.guenther@kidder.com

KIDDER.COM

This information supplied herein is from sources we deem reliable. It is provided without any representation, warranty, or guarantee, expressed or implied as to its accuracy. Prospective Buyer or Tenant should conduct an independent investigation and verification of all matters deemed to be material, including, but not limited to, statements of income and expenses. Consult your attorney, accountant, or other professional advisor.

km Kidder Mathews