

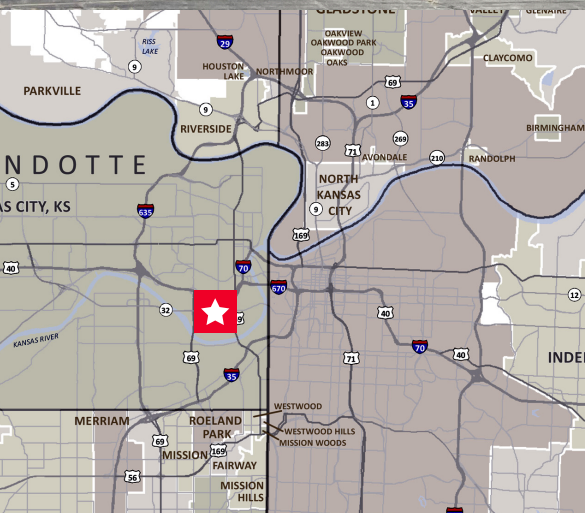

FOR LEASE

1800 Kansas Avenue Kansas City, KS



± 21,500 SF First Floor Industrial Space
Lease Rate: \$4.00 PSF IG

Property Highlights

- 11,000 SF fully air-conditioned warehouse with 28' clear height
- 5 dock-high doors, 1 drive-in door
- Excellent I-35 and I-70 access
- Heavy power

Jack Goldsborough, CCIM
Associate
+1 816 412 0326
jack.goldsborough@cushwake.com

Joe Giwa
Associate
+1 816 216 5657
joe.giwa@cushwake.com

4600 Madison Avenue, Suite 800
Kansas City, MO 64112
Main +1 816 221 2200
Fax +1 816 842 2798
cushmanwakefield.com

Building Features / Floor Plan

OVERVIEW

Address 1800 Kansas Avenue, Kansas City, KS

Square Feet ±21,500 SF

Office Square Feet ±1,000 SF

FEATURES

Zoning M-3 (Heavy Industrial)

Clear Height 28' / 12'

Year Built 1903 / 1999

Loading 5 Dock-High Doors, 1 Drive-in Door

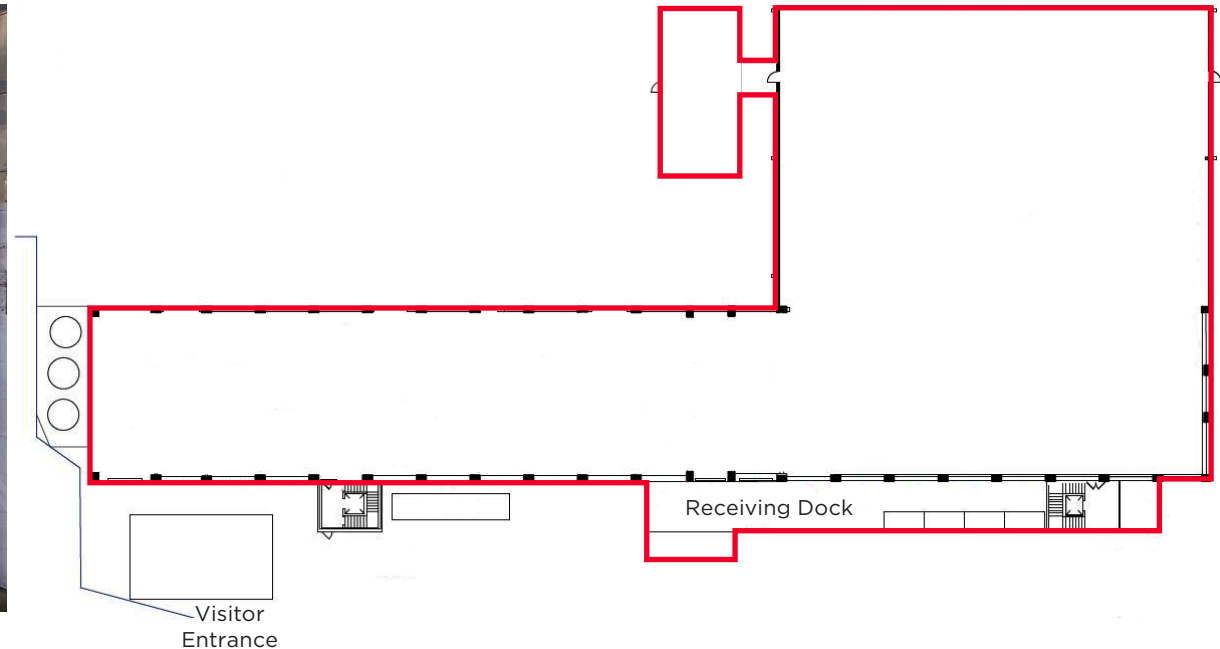

Location Aerial

