

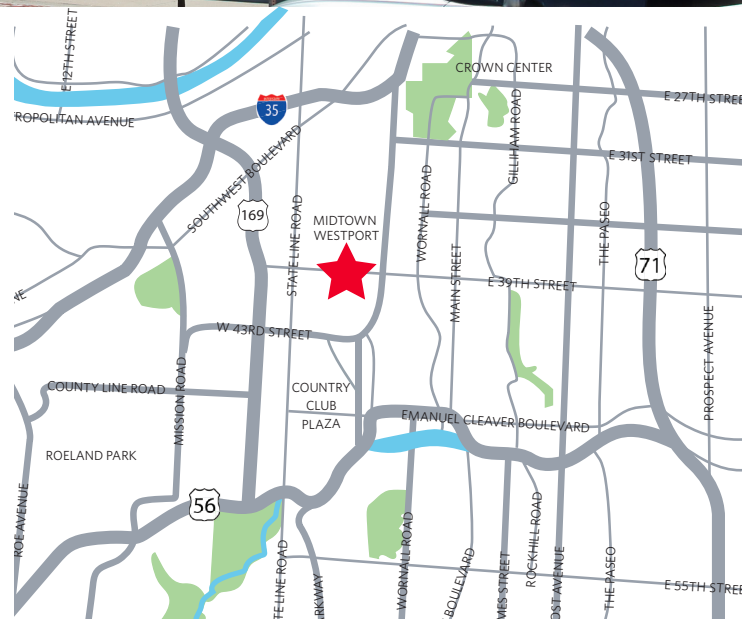

3,533 SF Office Space
Lease Rate: \$22.50 PSF FS

Property Highlights

- Located in the heart of the vibrant Westport District
- Join new tenant Sullivan, Higdon & Sink coming in 2019
- Ample free covered parking in the 700 space five-story, attached garage offering 3.00/1,000 sf parking ratio
- Numerous restaurants and amenities within a short walk
- New exterior and common area upgrades planned Q1 2019
- Ten offices with exterior windows
- Two conference rooms



Jeffrey T. Winters
Director
+1 816 412 0298
jeff.winters@cushwake.com

Travis Helgeson
Director
+1 816 412 0215
travis.helgeson@cushwake.com

4600 Madison Avenue, Suite 800
Kansas City, MO 64112
main +1 816 221 2200
fax +1 816 842 2798
cushmanwakefield.com

Floor Plan

4050 Pennsylvania - 3,533 SF

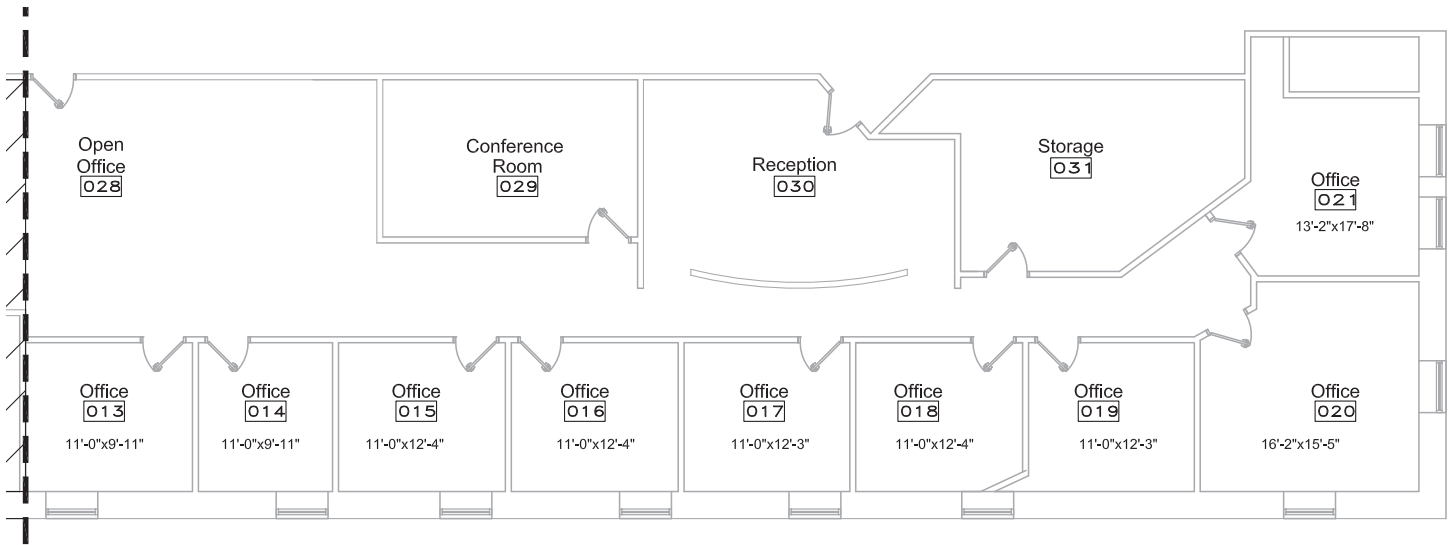



FOR LEASE

Manor Square Office

4050 Pennsylvania / Kansas City, Missouri



**Pictures are of recently completed 2nd floor space*

Cushman & Wakefield Copyright 2019. No warranty or representation, express or implied, is made to the accuracy or completeness of the information contained herein, and same is submitted subject to errors, omissions, change of price, rental or other conditions, withdrawal without notice, and to any special listing conditions imposed by the property owner(s). As applicable, we make no representation as to the condition of the property (or properties) in question.



FOR LEASE

Manor Square Office

4050 Pennsylvania / Kansas City, Missouri

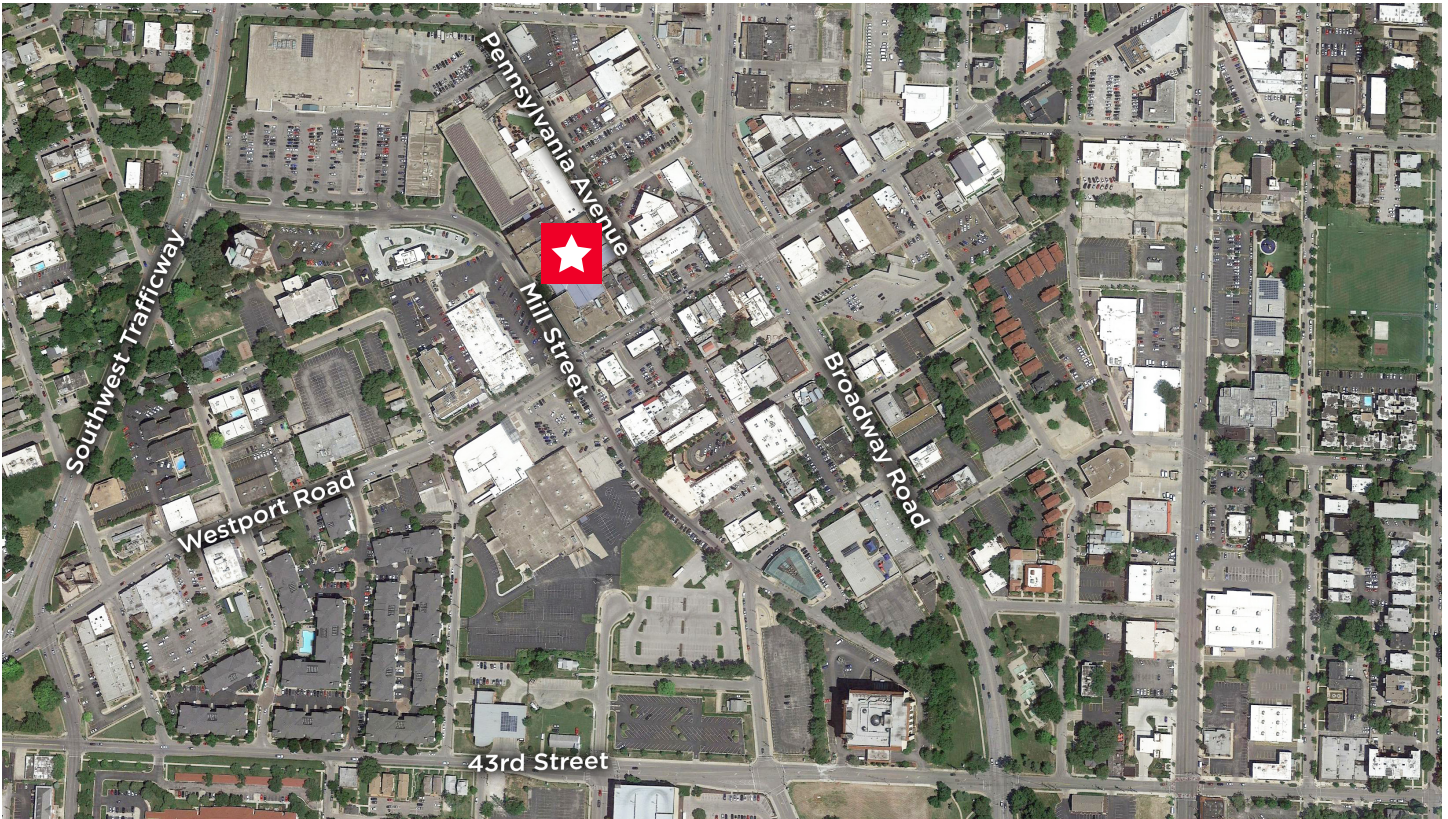

Aerial / Location Map

Drive Time Info

Destination	Drive Time
Country Club Plaza	5 Minutes
Access to Interstate 35	7-10 Minutes
Downtown/P&L District	10 Minutes
Crown Center/Union Station	10 Minutes

Demographics

	1 Mile	3 Miles	5 Miles
Population	23,768	116,268	277,123
Households	14,692	56,010	124,254
Average HH Income	\$63,414	\$67,689	\$61,476
Daytime Population	48,480	129,637	296,552
# of Businesses	3,102	8,458	17,625

Jeffrey T. Winters
 Director
 +1 816 412 0298
 jeff.winters@cushwake.com

Travis Helgeson
 Director
 +1 816 412 0215
 travis.helgeson@cushwake.com

4600 Madison Avenue, Suite 800
 Kansas City, MO 64112
 main +1 816 221 2200
 fax +1 816 842 2798
cushmanwakefield.com