

INDUSTRIAL SPACE FOR LEASE MULTI-TENANT INDUSTRIAL BUILDING

620 VENTURE STREET, SUITE C | ESCONDIDO, CA



BUILDING AMENITIES

- Suite C: 3,450 SF
- Multi-tenant industrial building near Escondido Auto Park
- 16' warehouse ceiling height
- One grade level door
- Office, one restroom and warehouse
- Available August 1, 2019

LEASE RATE: \$0.90/SF/MO. + \$0.05/SF CAM

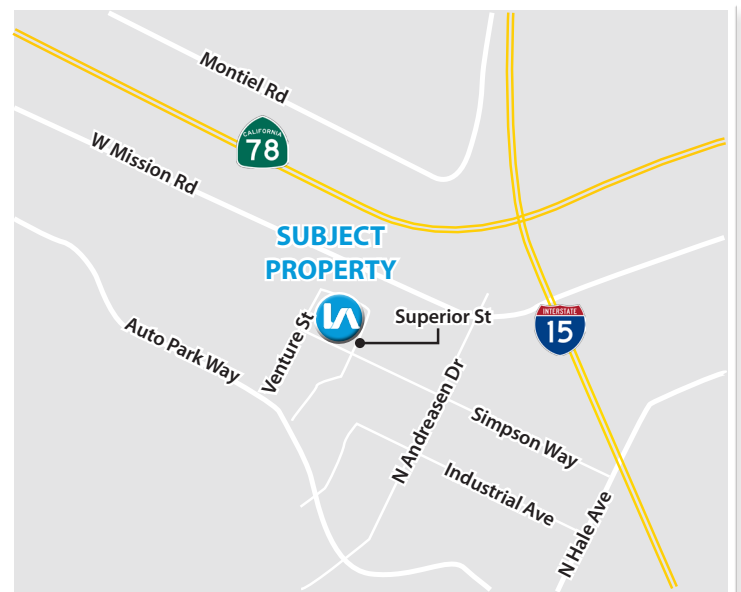

Peter Merz
pmerz@lee-associates.com
D 760.448.1362
DRE #01269042

Daniel Knoke
dknoke@lee-associates.com
D 760.929.7836
DRE #01215373

All information furnished regarding property for sale, rental or financing is from sources deemed reliable, but no warranty or representation is made to the accuracy thereof and same is submitted to errors, omissions, change of price, rental or other conditions prior to sale, lease or financing or withdrawal without notice. No liability of any kind is to be imposed on the broker herein.

INDUSTRIAL SPACE FOR LEASE MULTI-TENANT INDUSTRIAL BUILDING

620 VENTURE STREET, SUITE C | ESCONDIDO, CA

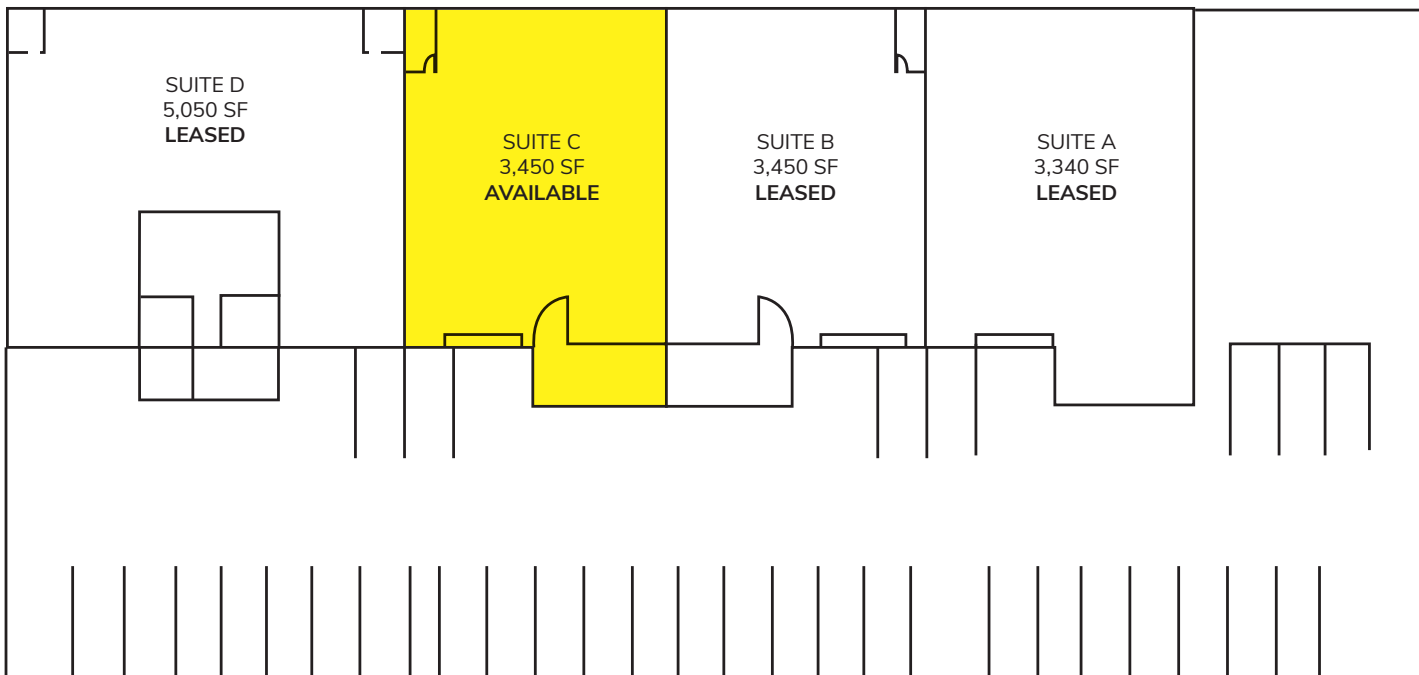

SUITE	SIZE/SF	IMPROVEMENTS	RATE/SF/MO	AVAILABILITY	ACCESS
C	3,450	Office	\$0.90/SF/MO + \$0.05 CAM	August 1, 2019	Call to Show

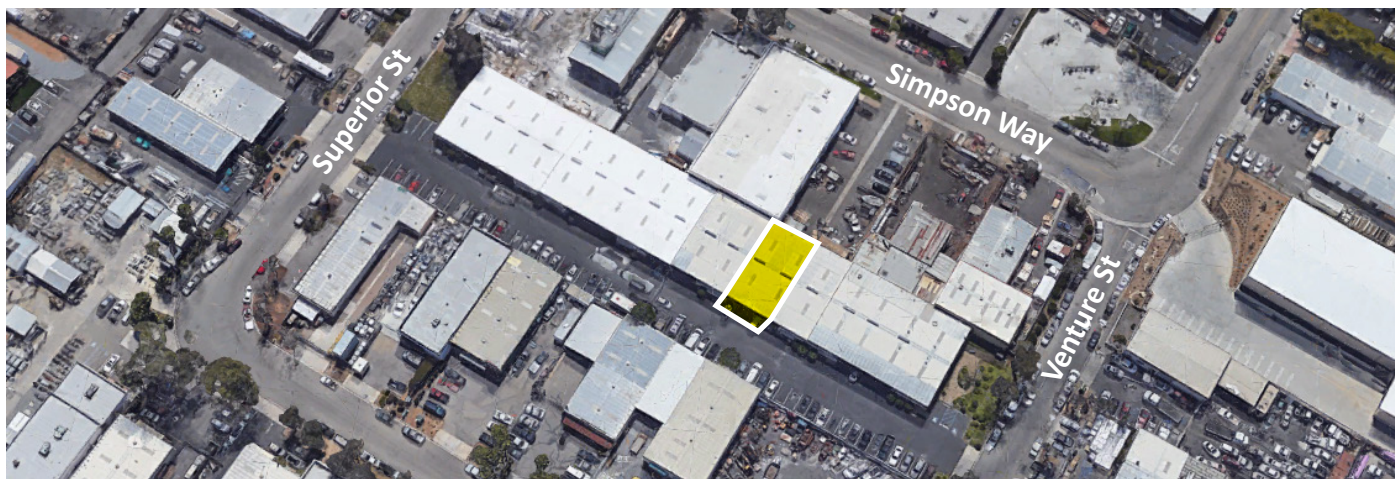

Peter Merz
pmerz@lee-associates.com
D 760.448.1362
DRE #01269042

Daniel Knoke
dknoke@lee-associates.com
D 760.929.7836
DRE #01215373

All information furnished regarding property for sale, rental or financing is from sources deemed reliable, but no warranty or representation is made to the accuracy thereof and same is submitted to errors, omissions, change of price, rental or other conditions prior to sale, lease or financing or withdrawal without notice. No liability of any kind is to be imposed on the broker herein.