

OFFICE SUITE FOR LEASE

421 Graham Road, Cuyahoga Falls, OH 44221



PROPERTY OVERVIEW

Professional Office Building located on Graham Road between State Road and E. Bath Road in Cuyahoga Falls. This property is located just minutes from Portage Crossings and 1/4 mile from the new Menard's. The building offers wonderful signage, free parking, covered walkways, windows, and manicured landscaping. The available suite offers flexibility as it can be used for a professional office or a medical office. This unit offers the best bang for your buck in Cuyahoga Falls.

PROPERTY HIGHLIGHTS

- Located on a main artery through Cuyahoga Falls
- Space Flexibility (Professional Office or Medical)
- Plenty of Free Parking Spaces
- Covered Walkways in the Front and Rear
- Wonderful Signage
- Beautifully Maintained Exterior
- Some Covered Parking



Lease Rate:

\$12.50 SF/YR
(MG)



Suite:

C



Lot Size:

1.11 Acres



Available SF:

2,580 SF



Building Size:

15,232 SF



Zoning:

C-1 Commercial District

OUR NETWORK IS YOUR EDGE.

All information is from sources deemed reliable and is subject to errors, omissions, change of price, rental, prior sale, and withdrawal without notice. Prospect should carefully verify each item of information contained herein.

Ed Jesson

O: 330.940.9360

C: 330.760.4494

ejesson@hoffleigh.com

OFFICE SUITE FOR LEASE

421 Graham Road, Cuyahoga Falls, OH 44221

First Floor Office Suites 421 Graham Road Cuyahoga Falls, Ohio 44221

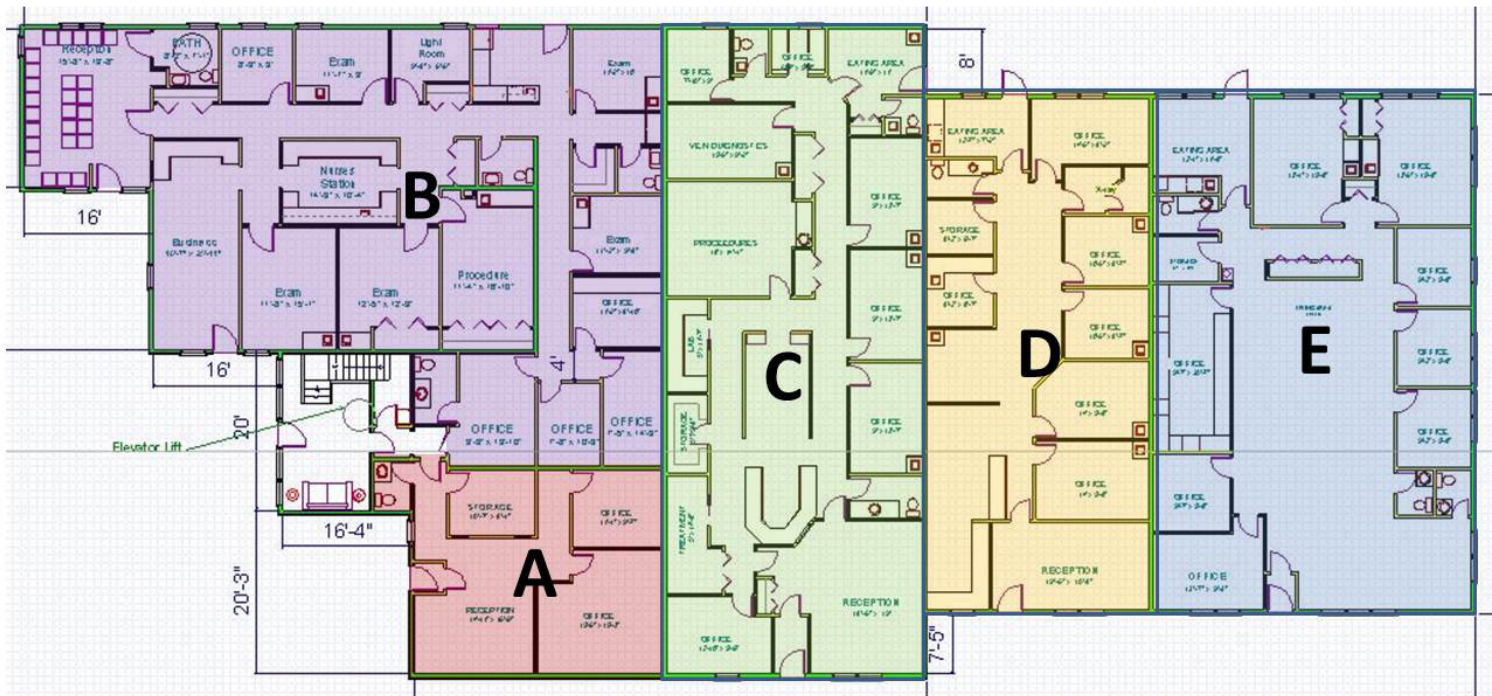

OUR NETWORK IS YOUR EDGE.

All information is from sources deemed reliable and is subject to errors, omissions, change of price, rental, prior sale, and withdrawal without notice. Prospect should carefully verify each item of information contained herein.

Ed Jesson

O: 330.940.9360

C: 330.760.4494

ejesson@hoffleigh.com



OFFICE SUITE FOR LEASE

421 Graham Road, Cuyahoga Falls, OH 44221



OUR NETWORK IS YOUR EDGE.

All information is from sources deemed reliable and is subject to errors, omissions, change of price, rental, prior sale, and withdrawal without notice. Prospect should carefully verify each item of information contained herein.

Ed Jesson

O: 330.940.9360

C: 330.760.4494

ejesson@hoffleigh.com