

Astrea Industrial Park

3707 124th Street NE
Unit 1
Marysville, WA

Unit 1 - 2,606 SF available

± 1,141 SF warehouse

± 1,465 SF office

Well located industrial park with
I-5 freeway visibility

Fenced and paved yard area
available

Great neighbors

Quick freeway access

Aggressive lease rates



Location



Contact

Brian Kenworthy
Senior Vice President

425.450.1131

briank@kiddermathews.com

Astrea Industrial Park

Site plan

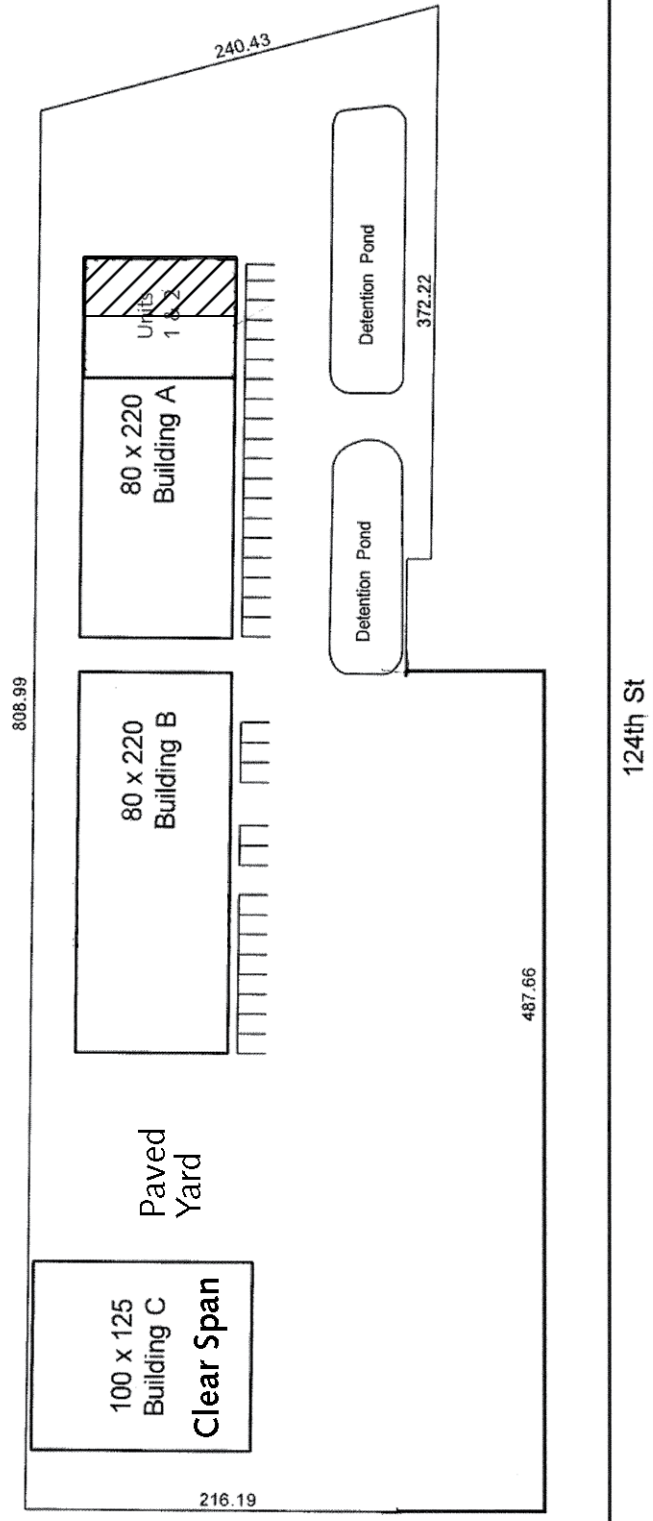

Contact

Brian Kenworthy
Senior Vice President
 425.450.1131

briank@kiddermathews.com