

1500 MARKET STREET

CENTRE SQUARE • PHILADELPHIA, PA



**GROUND FLOOR RETAIL/RESTAURANT
SPACE AVAILABLE**

1500 MARKET STREET

CENTRE SQUARE • PHILADELPHIA, PA



RETAIL/RESTAURANT OPPORTUNITIES

INTERIOR LOBBY SPACE 16TH STREET
970 - 1,147 SF 1,125 SF

MARKET STREET
UP TO 18,021 SF
(DIVISIBLE)

The 40,000 SF of retail space is situated under 1.8M SF of office space in two towers and adjacent to City Hall and the highly acclaimed urban park, Dilworth Plaza Direct with 10.8M visitors annually

Lobby will be upgraded and repositioned to meet the needs of the extensive pedestrian traffic

The retail space has exposure on 15th Street, 16th street, Market Street and the concourse to the train-shed

Direct access to the commuter train-shed, serving the suburbs and City's subway systems



FLOOR PLANS

Market Street

16th Street

15th Street

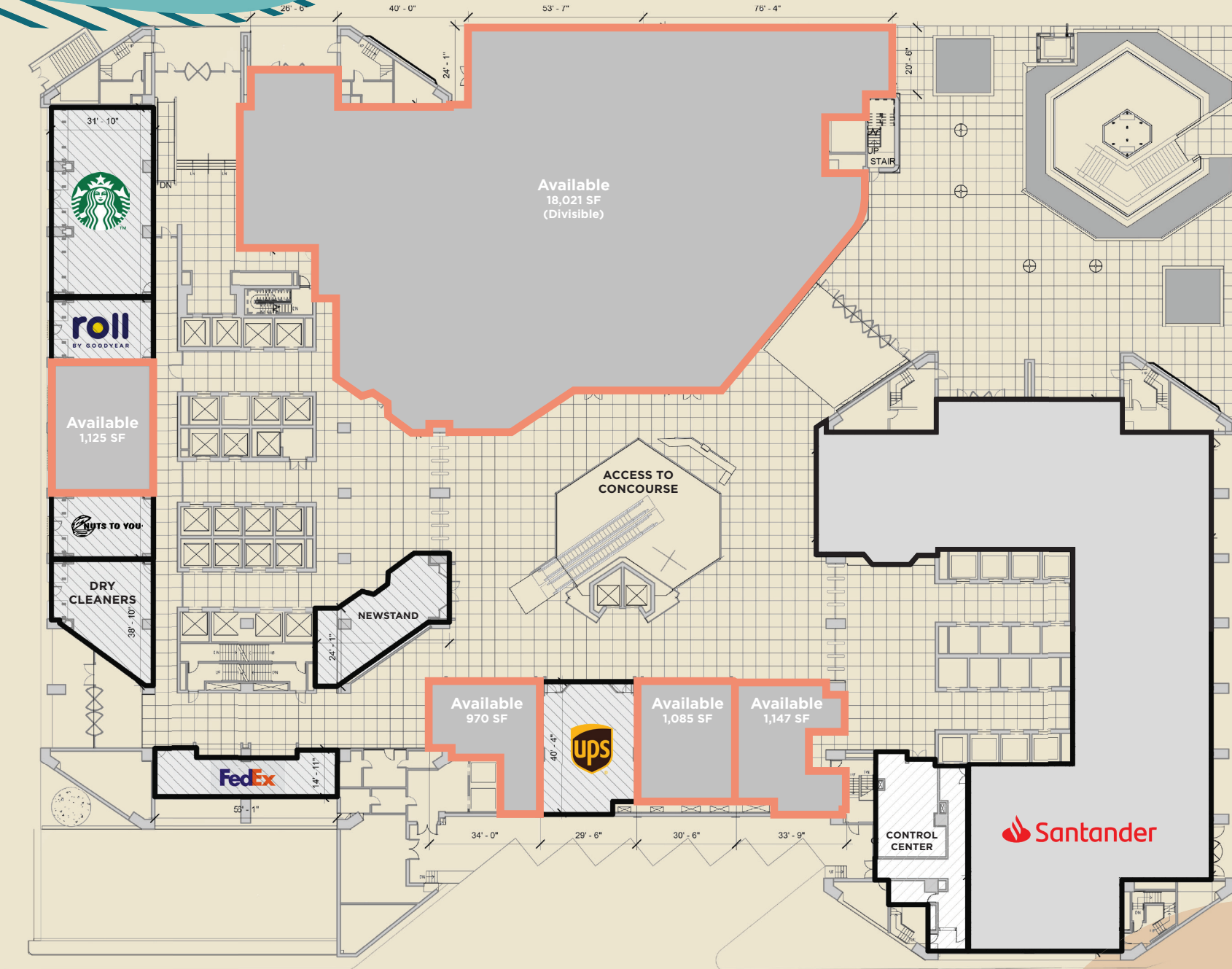

RETAIL MAP

1500 MARKET STREET

CENTRE SQUARE • PHILADELPHIA, PA



1500 MARKET STREET

CENTRE SQUARE • PHILADELPHIA, PA

Paige Jaffe • Managing Director

215 988 5500 paige.jaffe@am.jll.com Licensed: PA

Mallory Scaccetti • Senior Vice President

215 988 5500 mallory.scaccetti@am.jll.com Licensed: PA

DISCLAIMER

© 2020 Jones Lang LaSalle IP, Inc. All rights reserved. All information contained herein is from sources deemed reliable; however, no representation or warranty is made to the accuracy thereof.

