

# For Lease

## Park 280 - Building B



4710 B Street NW  
Auburn, WA



18,221 SF total with 5,123 SF office

Divisible to 9,894 SF (1,958) and 13,126 SF (3,502)

24' clear height

Heavy power

5 grade-level doors (12' x 14')

Frontage on B street with high image improvements

Available now

**Mike Newton**  
206.248.7311  
mnewton@kiddermathews.com

Park 280

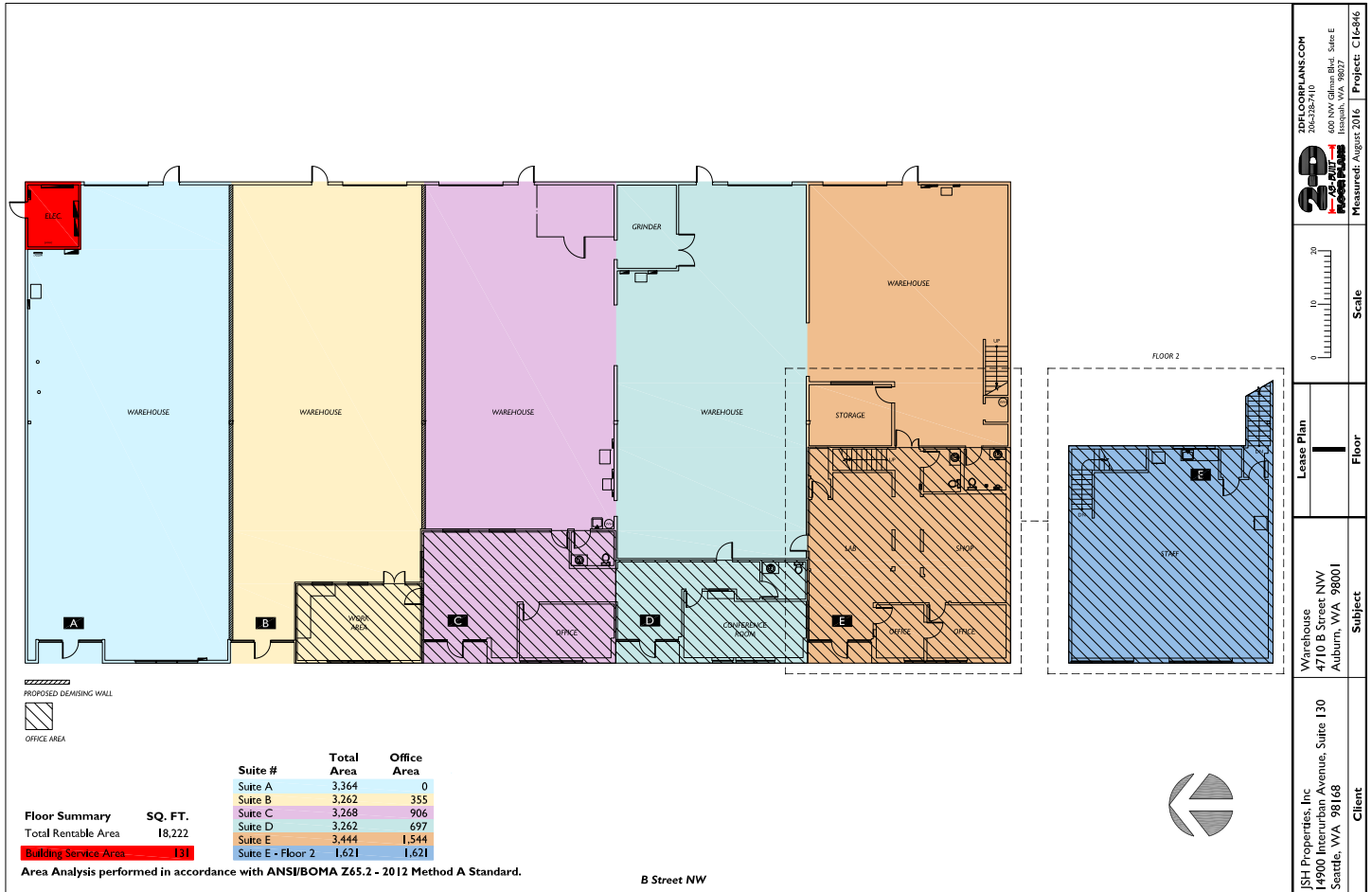

Contact

**Mike Newton**  
 206.248.7311  
 mnewton@kiddermathews.com