

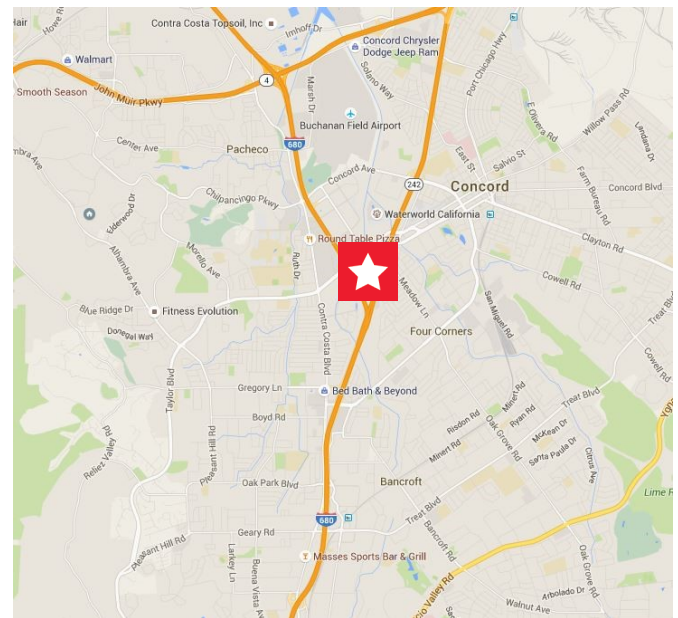

Suite C: ±2,800 SF

Property Highlights

- Building: ±15,850 SF
- Dimensions: (±40'w X ±70'd)
- Dead Storage
- Clear Height: ±18'
- Loading: One (1) 12' x 14' Grade Level Door
- Power: ±100 Amps @ 120/208 Volts, 3 phase per unit
- Located in the heart of central Concord, with close proximity to retail amenities at the strategic confluence of I-680 & I-242



For more information, please contact:

Tim Schmid
Director
+1 925 627 2886
tim.schmid@cushwake.com
LIC #01847650

Bo Harkins
Director
+1 925 627 2481
bo.harkins@cushwake.com
LIC #01943785

1333 N California Blvd, Suite 500
Walnut Creek, CA 94596

T: +1 925.935.0770

cushmanwakefield.com

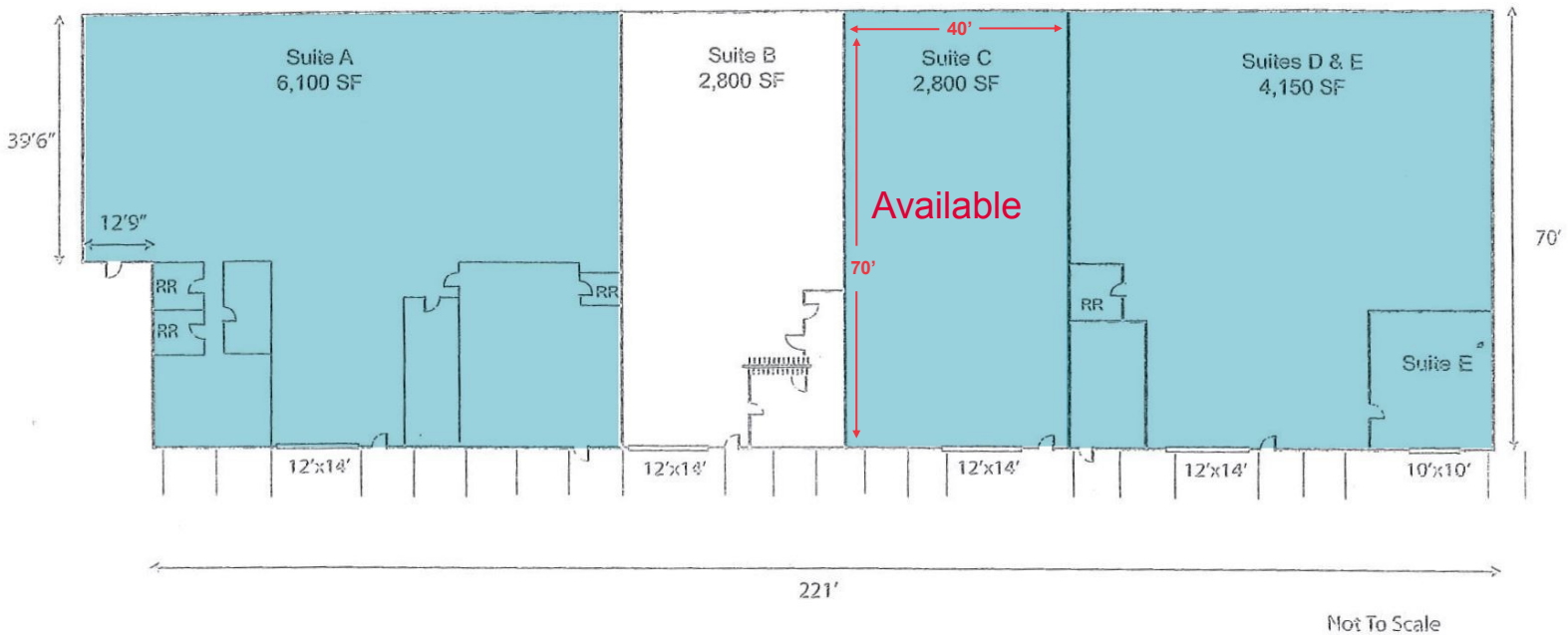
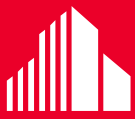

For more information, please contact:

Tim Schmid
Director
+1 925 627 2886
tim.schmid@cushwake.com
LIC #01847650

Bo Harkins
Director
+1 925 627 2481
bo.harkins@cushwake.com
LIC #01943785

1333 N California Blvd, Suite 500
Walnut Creek, CA 94596

T: +1 925.935.0770

cushmanwakefield.com