



# For Lease

## Property Overview

Space	Suite 102 – 4,509 SF
Availability	Within 30 Days Notice
Rental Rate	\$14.00 per RSF NNN
Operating Expenses	\$5.71 per RSF est. in 2018

### Building Features

- 14' Clear Height
- 100% HVAC
- Rear Loading; Semi-Dock
- Ample Parking

## Metric Center B

2101 Donley Drive  
Austin, Texas 78758

---

Ace Schlameus  
+1 512 225 2709  
[Ace.Schlameus@am.jll.com](mailto:Ace.Schlameus@am.jll.com)

[www.jll.com/austin](http://www.jll.com/austin)

Suite 102 | 4,509 SF

Metric Center B

For Lease

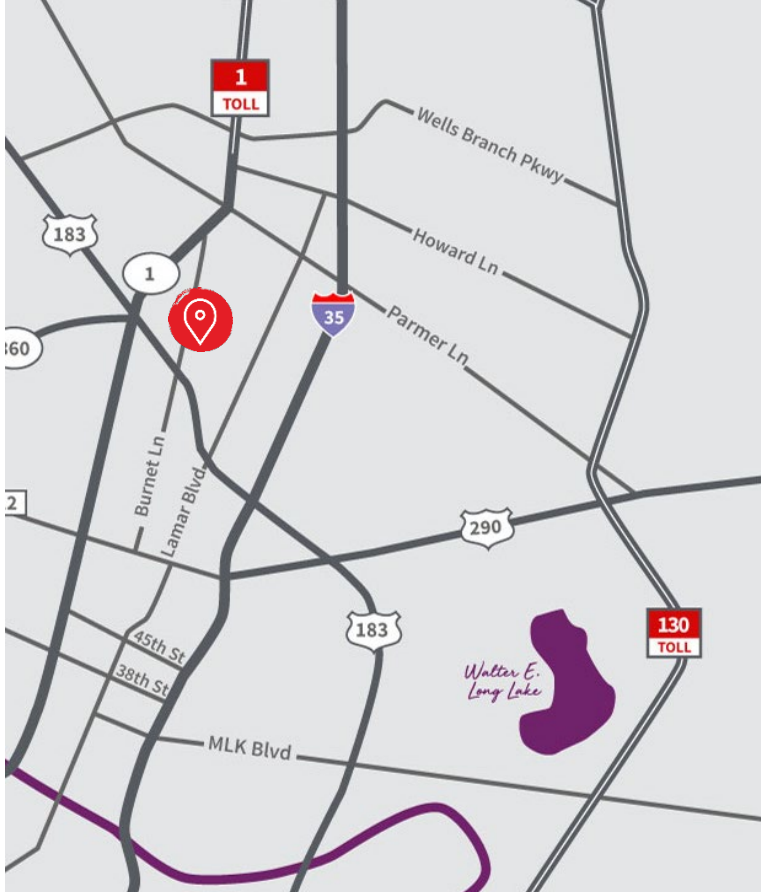
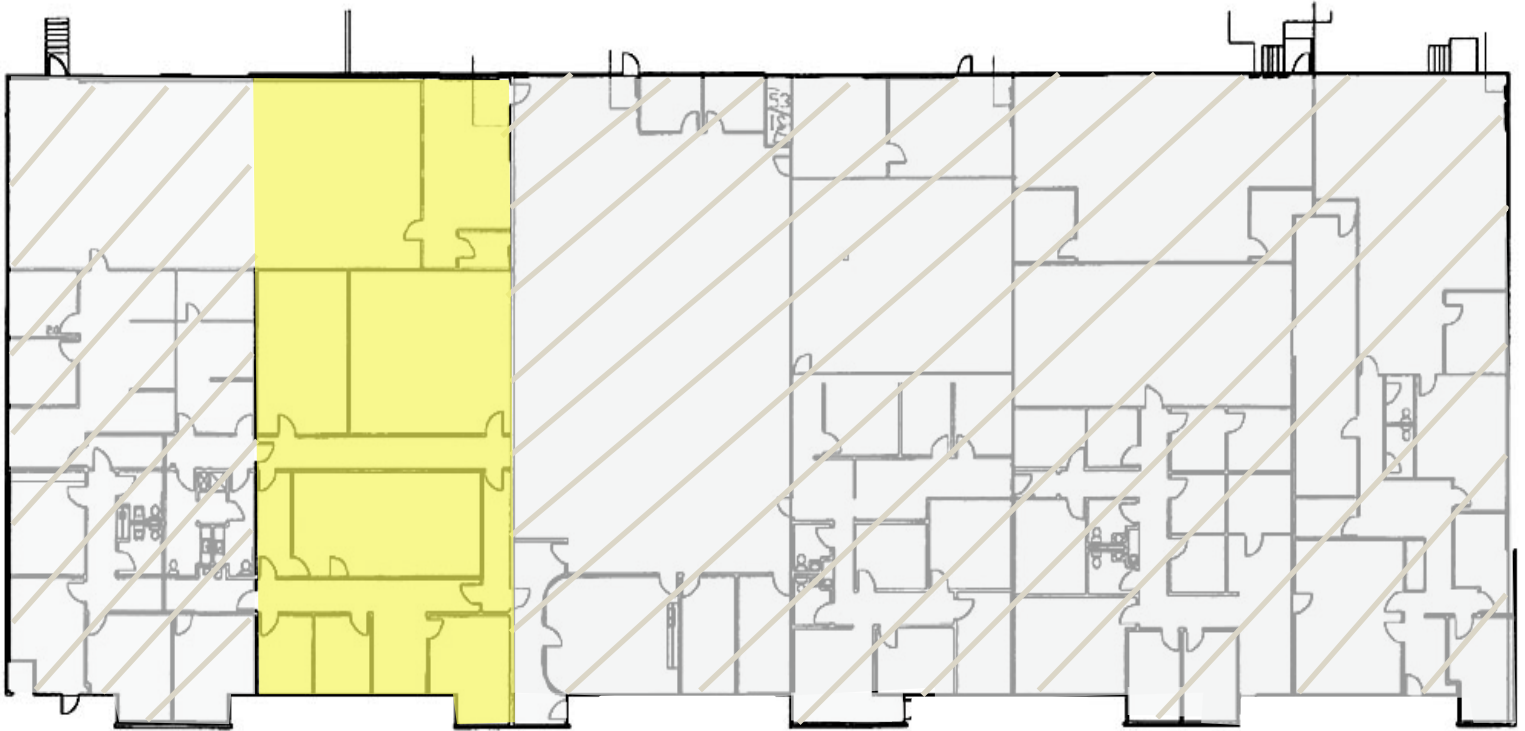

**Ace Schlameus**

+1 512 225 2709

[ace.schlameus@am.jll.com](mailto:ace.schlameus@am.jll.com)

[www.jll.com/austin](http://www.jll.com/austin)

The information contained herein is obtained from sources believed to be reliable. However, Jones Lang LaSalle makes no guarantees, warranties or representations as to the completeness or accuracy thereof. The presentation of this property is submitted subject to errors, omissions, change of price or conditions, and is subject to prior sale, lease or withdrawal without notice

