

Site No. :	1518
Site Name :	Gresham Town Fair
Location :	Gresham, OR
Submitted By :	Danielle Olson
Drawn By :	RK
Date :	03.27.14

## Lease Outline Drawing

±2,615 S.F.

Gross Leasable Area

### VACANCY REPORT DATA

#### EXTG. CEILING HEIGHTS

B.O. Roof Deck	N/A
B.O. Roof Joists	N/A
B.O. Ceiling	N/A
B.O. Soffit	N/A

#### EXTG. ELECTRICAL SERVICE

Elec. Panel #1	N/A
Elec. Panel #2	N/A
Elec. Panel #3	N/A
Elec. Panel #4	N/A
Elec. Panel #5	N/A

#### FIRE SUPPRESSION SYSTEM

Extg. Bldg. is Sprinklered?	N/A
-----------------------------	-----

Note: Dimensions and conditions shown are a graphic representation of the property and/or tenant premises. Some existing interior tenant improvements are not shown. It is the responsibility of the Tenant or his agent to field verify all dimensions and conditions prior to design and construction of tenant improvements.

Unless otherwise noted, the existing reference site plan is derived from the KIMCO Realty Corporation Flyer CAD file. The existing interior tenant layout is derived from field measurements conducted and provided by KIMCO Realty Corporation.

The information presented herein is intended for use by Kimco Realty Corporation, for the purposes of schematic planning only and should not be used as a construction document. Owner, contractor and/or tenant are responsible to verify all dimensions and conditions prior to permit or construction. This drawings has been electronically transmitted.

**UNIT\_316**

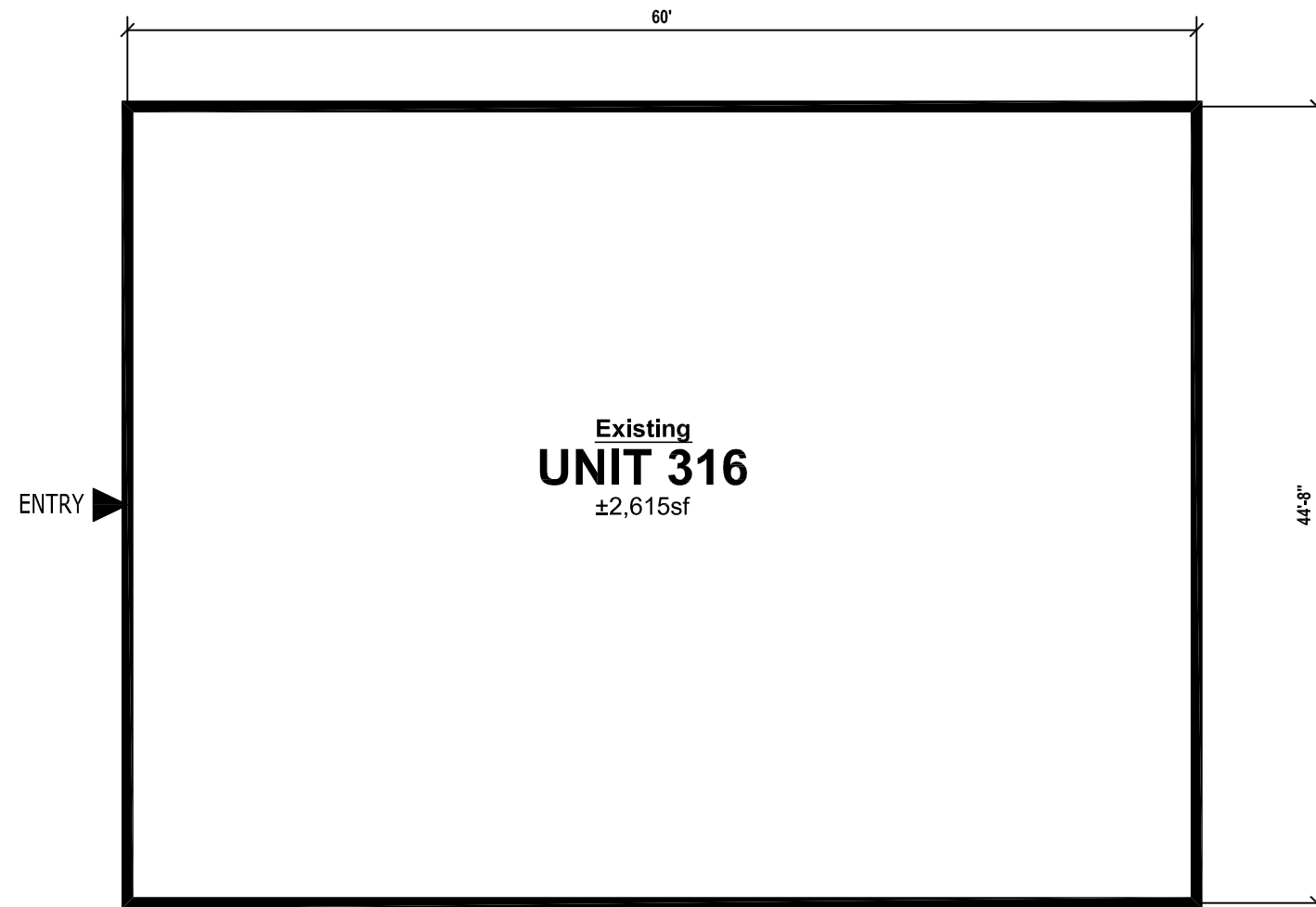

**EXISTING DEMISING PLAN**

SCALE: 1" = 10'-0"



**NOTES:**

- 1.0 Extg. site plan derived from 1518.dwg Flyer CAD file per KIMCO Realty.