

111 Murray Street

TRIBECA
NEW YORK, NY



NEWMARK

Property Details

Location

Northeast corner of West Street

Approximate Size

Ground Floor

Space A	996 SF
Space B	292 SF
Total	1,288 SF

Possession

Immediate

Term

Negotiable

Frontage

Space A	52 FT on Murray Street 15 FT on West Street
Space B	25 FT on West Street

Ceiling Height

Ground Floor 19 FT 1 IN

Site Status

New Construction

Neighbors

One Seed (coming soon), Whole Foods Market, SoulCycle, Shake Shack, Target, Harry's Italian, The Palm, Bluemercury, Equinox, Regal Cinemas, Warby Parker, Joe and the Juice, Bed Bath & Beyond, Gucci and Vince

Comments

Located at the base of a 64-story, 157-unit luxury condominium within the most dense residential confluence of the Financial District, TriBeCa and Battery Park City with approximately 7,000 residential units and five million SF of office space within a 1/4 mile

Architecturally distinct curving storefront

Plaza available for retail/cafe utilization surrounded by a landscaped garden

Lower Manhattan spending power of over \$8.4 billion, average household income of \$193,751, 15 billion annual tourists and over 7,000 hotel rooms

Major thoroughfare for Borough of Manhattan Community College, PS 234, PS 84 and Stuyvesant High School with over 30,000 enrolled students

Manhattan's number two performing Whole Foods Market, and number two performing SoulCycle within one block

Most uses considered

ADA bathroom in Space A

111 MURRAY STREET

Ground Floor - Overall Layout

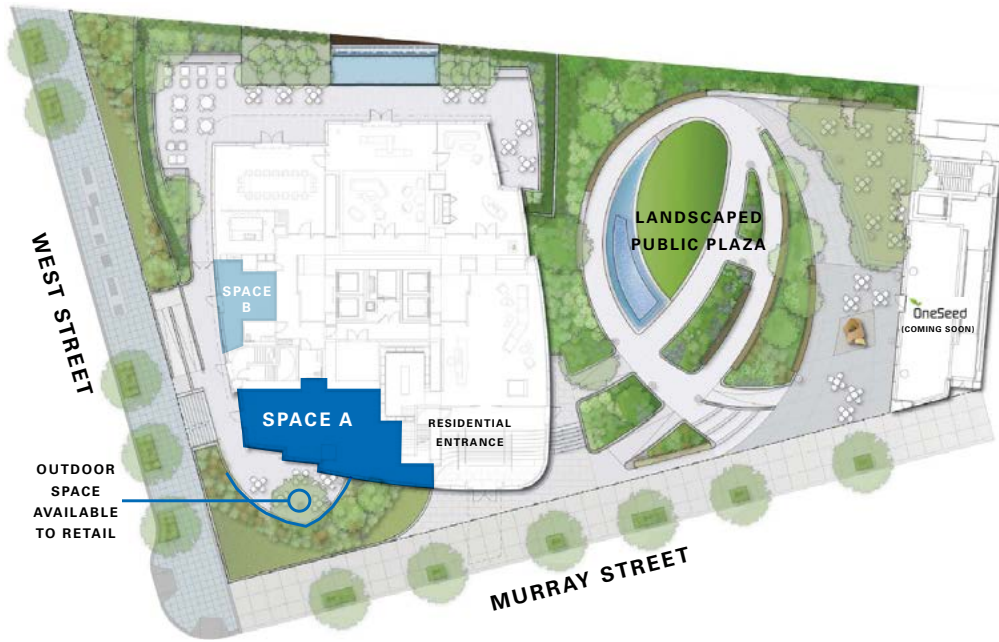

Approximate Size

Ground Floor	
Space A	996 SF
Space B	292 SF
Total	1,288 SF

Ground Floor

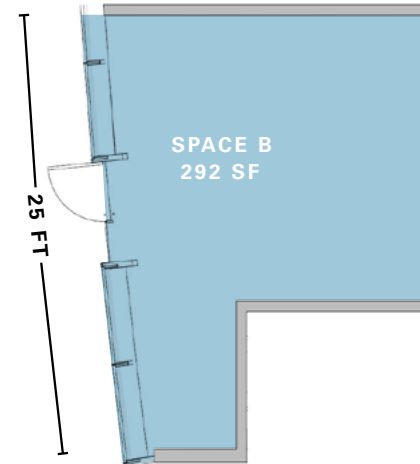
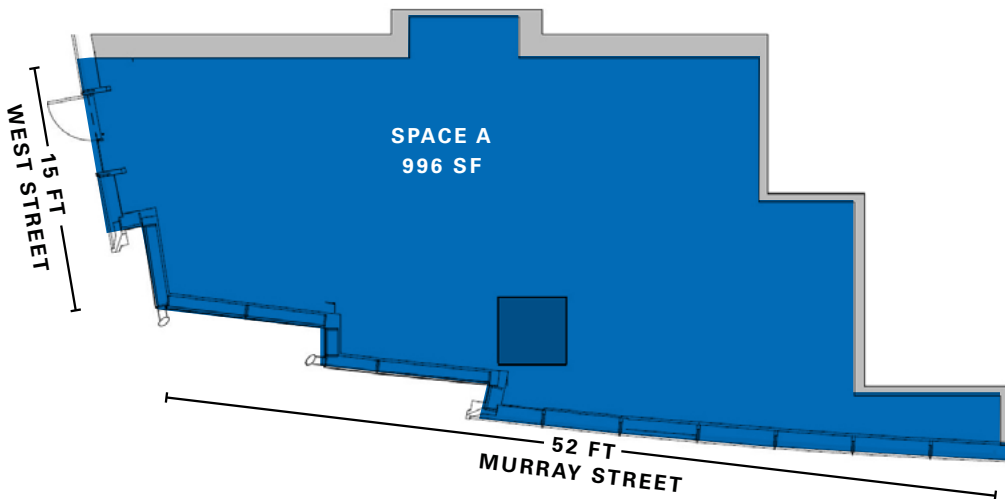

Additional Photos

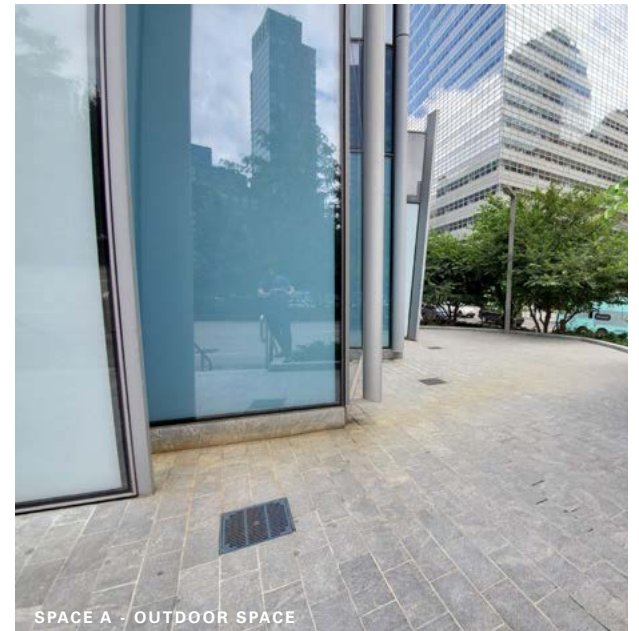
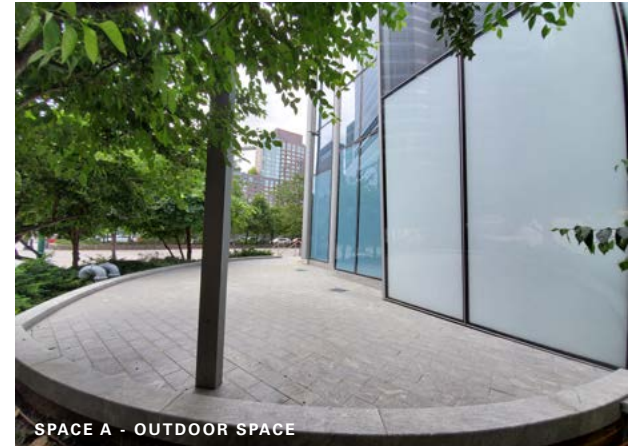
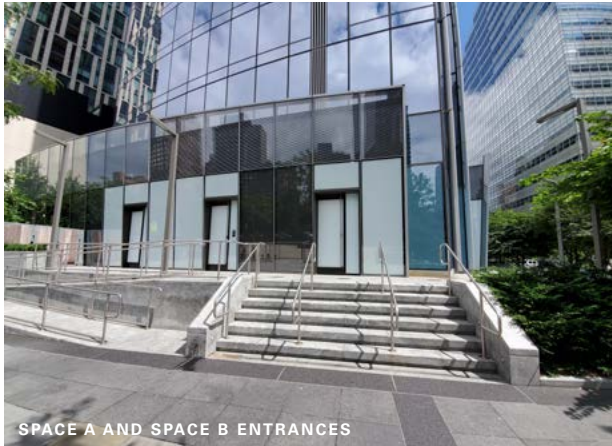

111 MURRAY STREET



CONTACT

Andrew Stern
 t 212-351-9353
 andrew.stern@nmrk.com

nmrk.com