

340 LAFAYETTE STREET



CONCEPTUAL RENDERING

SPACE DETAILS

LOCATION

West block between Bleecker and Bond Streets

APPROXIMATE SIZE

Ground Floor	2,650 SF
Lower Level	1,676 SF
Total	4,326 SF

POSSESSION

Immediate

TERM

Long term

FRONTAGE

38 FT on Lafayette Street

CEILING HEIGHT

Ground Floor	15 FT 5 IN
Lower Level	12 FT

SITE STATUS

New retail space

NEIGHBORS

Le Pain Quotidien, CorePower Yoga (coming soon), Aape (coming soon), Levain Bakery (coming soon), SoulCycle, Cha Cha Matcha, Kith and Clean Market (coming soon)

COMMENTS

Last remaining space on prime NoHo corner with great co-tenancy

Completely renovated building with a new storefront

At the base of the Bleecker Street and Broadway/Lafayette subway station servicing the **6 B D F M** lines

All uses accepted

GROUND FLOOR

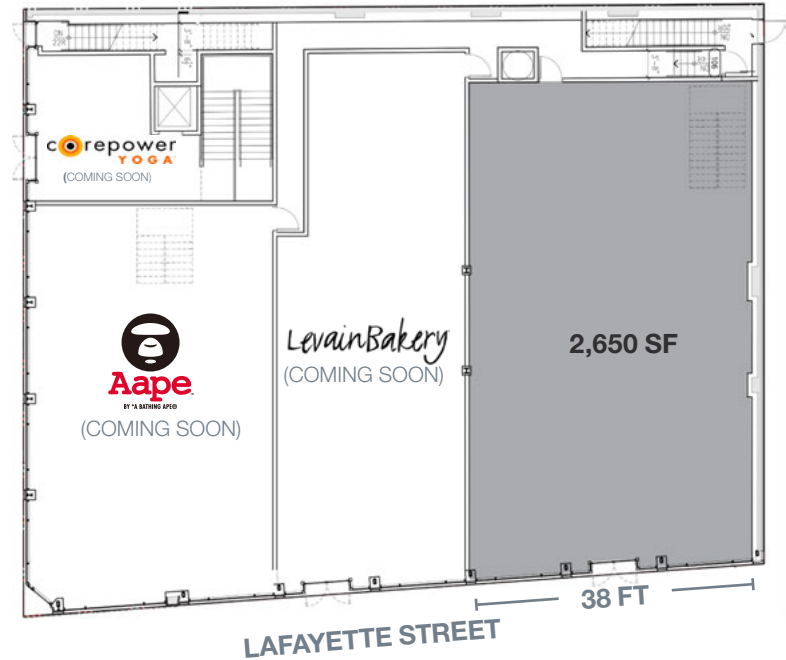

LOWER LEVEL



AREA RETAIL



CONTACT EXCLUSIVE AGENTS

KAREN BELLANTONI
212.331.0116
karen.bellantoni@ngkf.com

MICHAEL COHEN
212.916.3374
michaelryan.cohen@ngkf.com



NGKF.COM

© 2019 NEWMARK KNIGHT FRANK RETAIL. The information contained herein has been obtained from sources deemed reliable but has not been verified and no guarantee, warranty or representation, either express or implied, is made with respect to such information. Terms of sale or lease and availability are subject to change or withdrawal without notice.